

#12559 Filed This 21 day of Nov. 1968 P.

And Recorded in Vol. 777 Page 99 at 12:18 M

Ollie Farnsworth

Register Mesne Conveyance Greenville County, S. C.

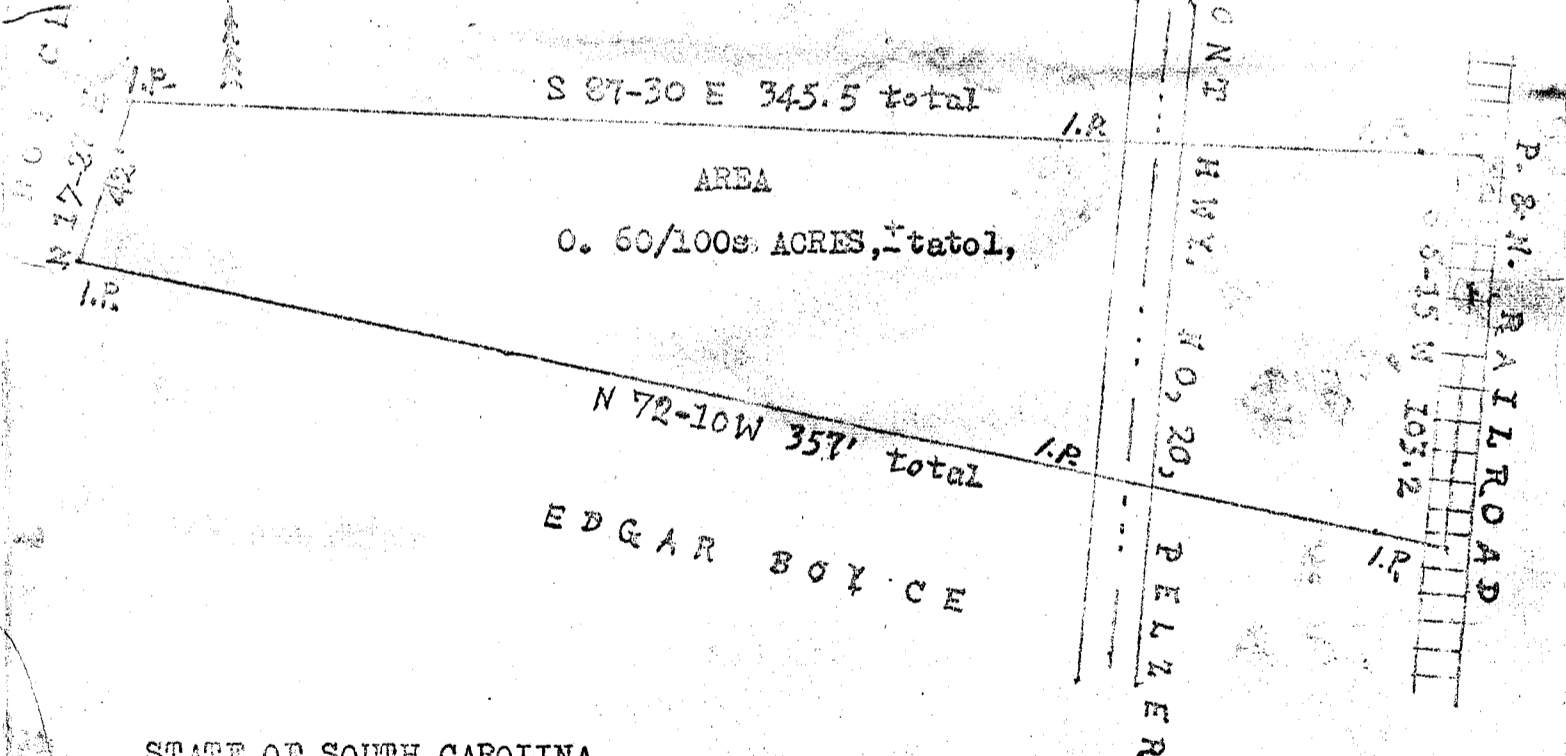
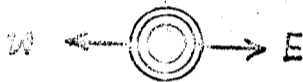

STATE OF SOUTH CAROLINA
COUNTY OF GREENVILLE

* GROVE TOWNSHIP *
* * *

NOV 21 1968

50¢

PROPERTY OF EDGAR BOYCE.

LOCATED APPROXIMATELY ONE MILE SOUTH OF PIEDMONT AND 1/4 MILE SOUTH OF OWENS GROCERY STORE ON WEST SIDE OF HWY, NO, 20,

THE ABOVE PLAT REPRESENTS A PORTION OF A TRACT KNOWN AS THE C.W. LOCKE PLACE RECORDED DEC. 3rd, 1948. vol. 366 PAGE 365,

SURVEYED OCTOBER 4th, 1968, BY THE EDGAR BOYCE FOR SALE TO EDWARD LEE DAVIS AND JO

SURVEYED

222-99

12559

CHARLES K. DUNN

L.S. REG. # 1578,

FILED
GREENVILLE CO. S. C.
NOV 21 12 18 PM 1968
OLLIE FARNSWORTH
R.M.S.