

857 Plat This 10 day of July 19 68
 And Recorded in Vol. 444 Page 55 at 3:50 P.M.
 Ollie Farnsworth
 Register Marie Connerance Greenville County, S. C.

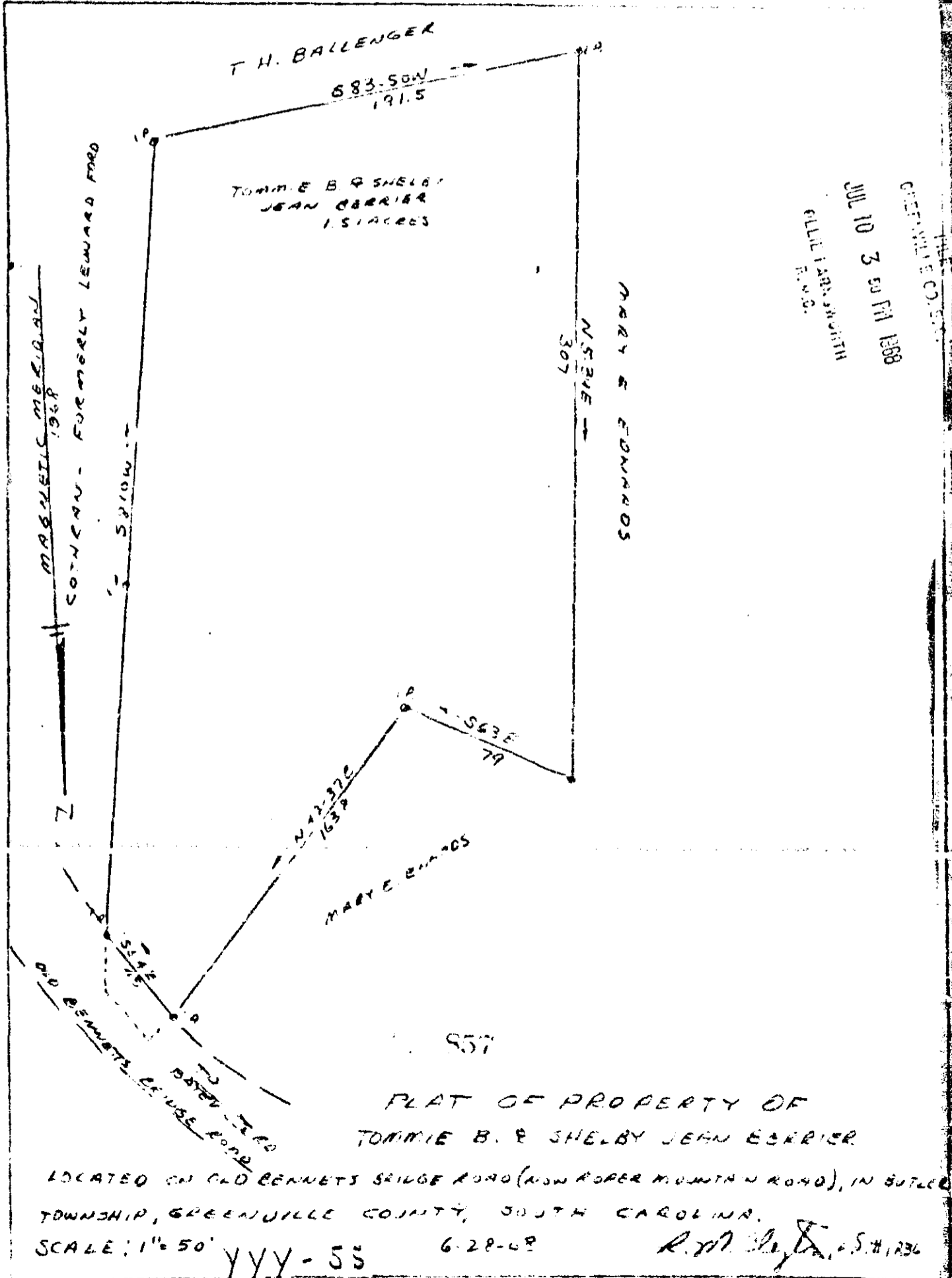

857
 PLAT OF PROPERTY OF
 TOMMIE B. & SHELBY JEAN CARRIER

LOCATED ON OLD BENNETTS BRIDGE ROAD (NOW ROBER MOUNTAIN ROAD), IN BUTLER
 TOWNSHIP, GREENVILLE COUNTY, SOUTH CAROLINA.
 SCALE: 1" = 50' YYY-55 6-28-68 R. W. [Signature] S. H. 1234