

For Dedication of Roads & Streets  
see Dedication Book 1 page 11.

FILED  
GREENVILLE CO. S.C.  
JAN 30 4 35 PM 1969  
ELLIE L. SMITH  
R.M.C.

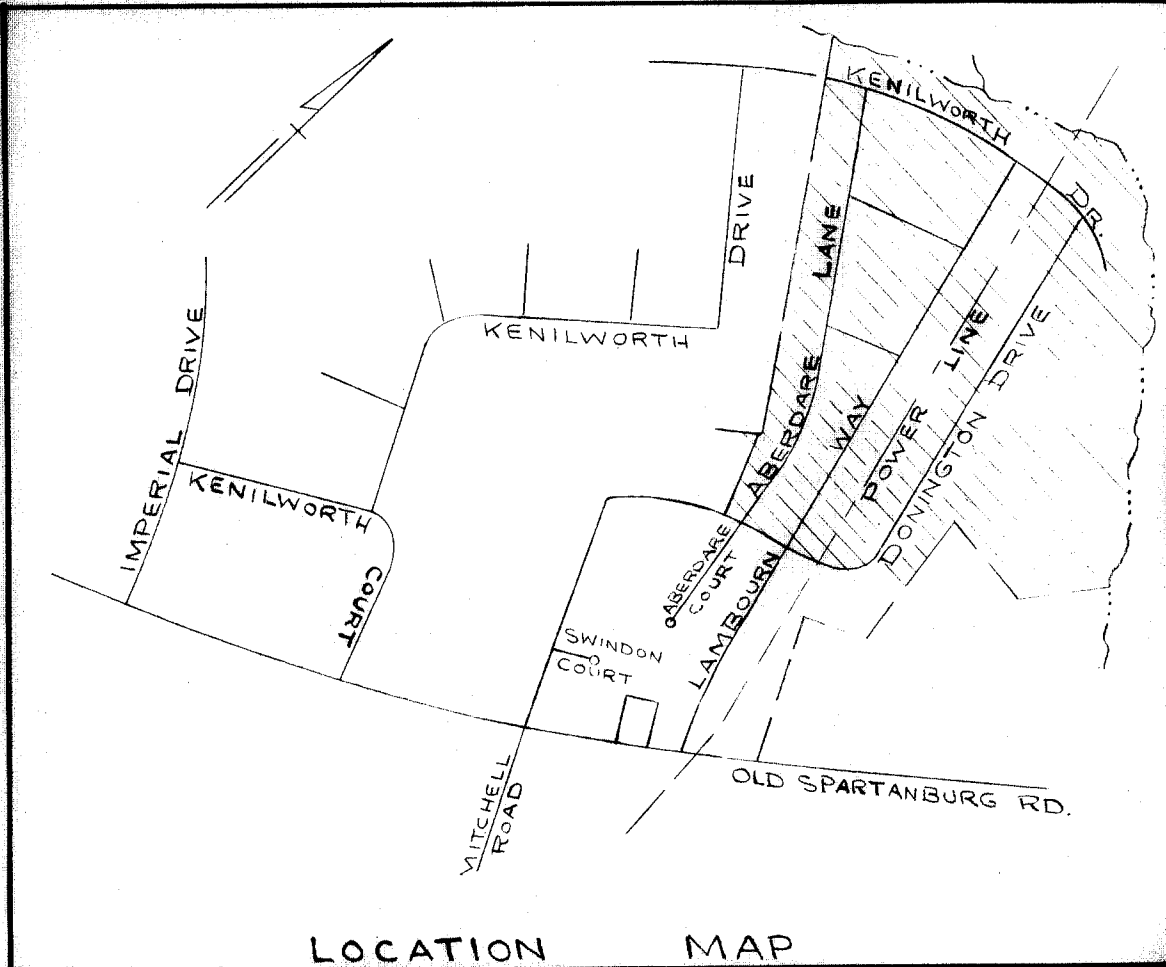

LOCATION MAP

PERFORMANCE BOND POSTED  
FOR RECORDATION APPROVAL

No county street maintenance will  
take place on any street shown on  
this plat until the release of this  
bond.

Signed: \_\_\_\_\_  
Director of Planning  
Greenville County  
Planning Commission

CERTIFICATE OF OWNERSHIP AND DEDICATION

The undersigned hereby acknowledge that I am (we are)  
the owner(s) of the property shown and described hereon  
and that I (we) hereby adopt this plan of subdivision with  
my (our) free consent and that I (we) establish the mini-  
mum building restriction lines, and hereby dedicate to pub-  
lic use as roads, streets, and easements/ forever all areas  
so shown or indicated on said plat.

1/9/69 Signed: \_\_\_\_\_  
\_\_\_\_\_  
\_\_\_\_\_  
\_\_\_\_\_  
Signed: \_\_\_\_\_

CERTIFICATE OF ACCURACY

"I, \_\_\_\_\_, certify that this plat was  
(drawn by me) (drawn under my supervision) (an actual  
survey made under my supervision) from (an actual survey  
made by me) (dead description recorded in Book 227,  
Page 215, Book 781, Page 231, etc.) (other); that  
the error of closure as calculated by latitudes and departures  
is 1/3216, that the boundaries not surveyed are  
shown as broken lines plotted from information found in  
Book \_\_\_\_\_, Page \_\_\_\_\_; that this plat was prepared in  
accordance with the Greenville County Subdivision Regula-  
tions as adopted.

1/9/69 Signed: Harold L. Thompson  
Date Licensed Engineer or Registered Surveyor  
S. C. Registration No. 3616

CERTIFICATE OF APPROVAL FOR RECORDING

"I hereby certify that the subdivision plat shown hereon  
has been found to comply with the Subdivision Regulations  
for Greenville County, with the exception of such variances,  
if any, as are noted in the minutes of the Greenville County  
Planning Commission of Greenville County, South Carolina,  
and that it has been approved for recording in the office of  
the County Register of Mense Conveyance."

JAN. 17, 1969 Signed: Robert G. White  
Director of Planning  
Greenville County Planning Commission  
18056

SHEET ONE

**KINGSBATE**

JACK SHAW  
OWNER  
PIEDMONT ENGINEERS  
& ARCHITECTS  
SURVEYOR

NO. OF ACRES 64.04 MILES OF NEW ROADS 1.86

NO. OF LOTS 102 DATE 1/9/69

ERROR OF CLOSURE 1/3216

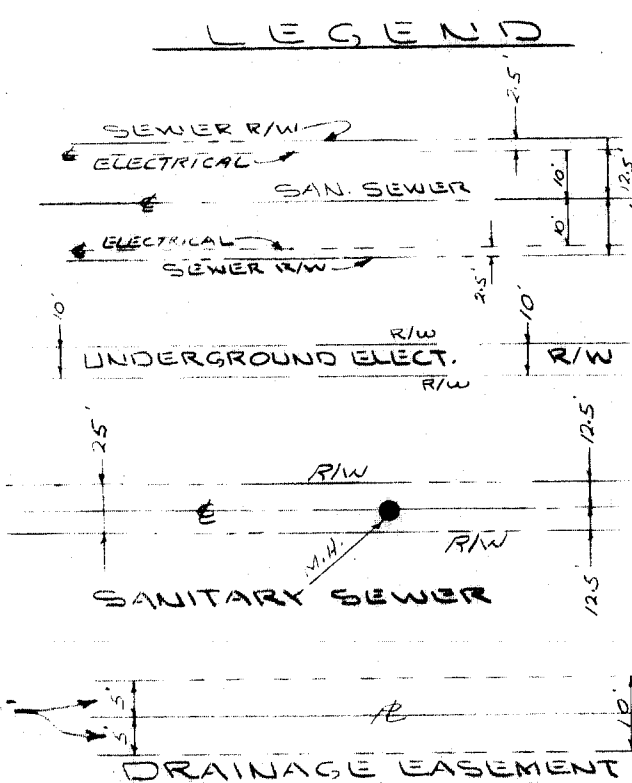
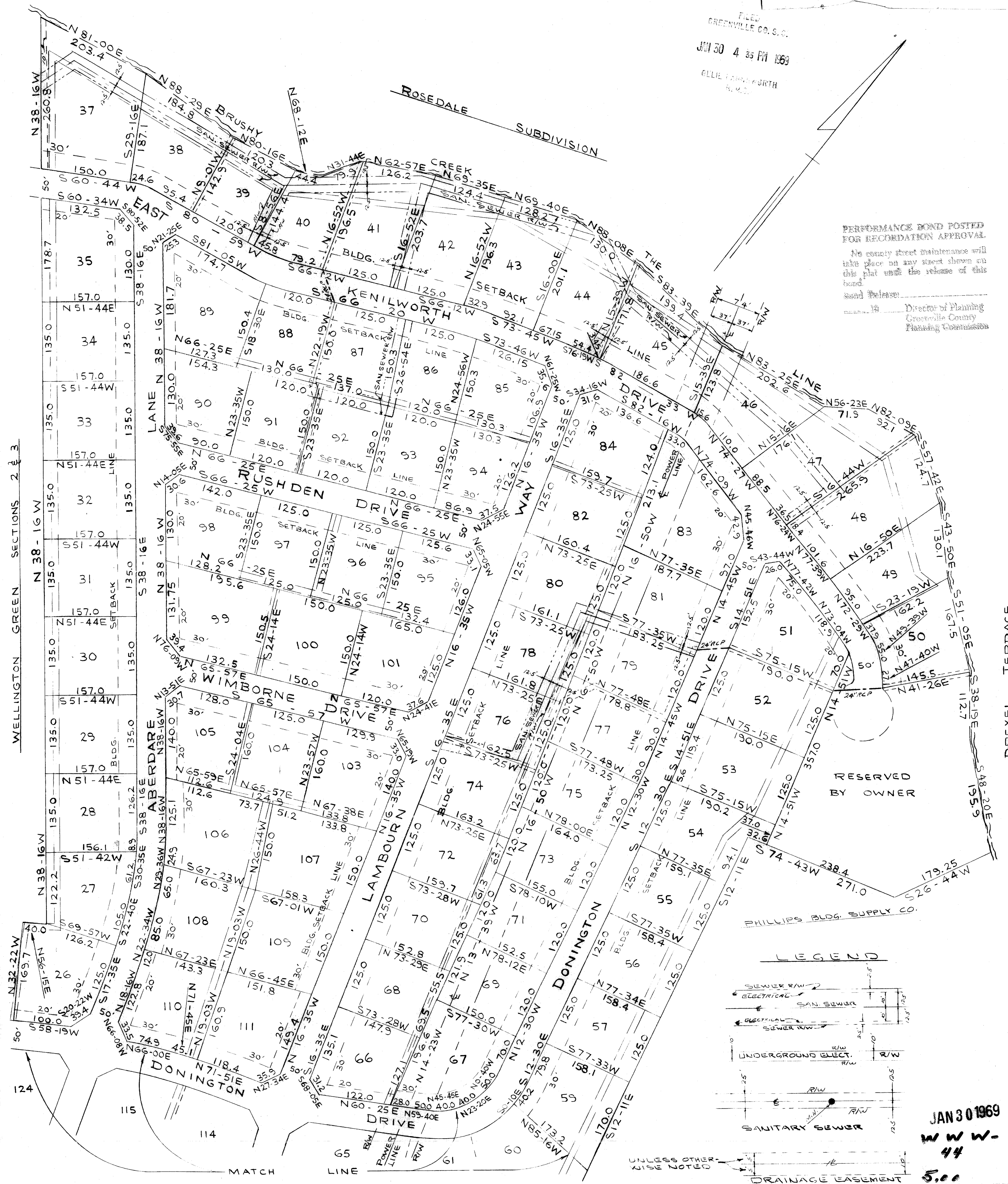
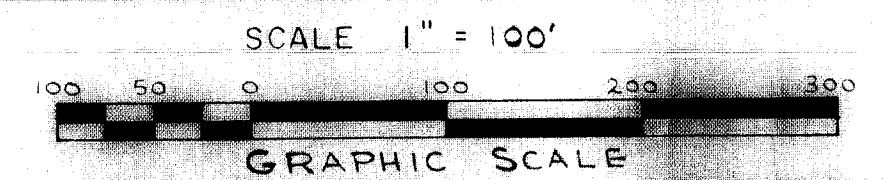

JAN 30 1969  
W W W.  
44  
5.00

WELLINGTON GREEN SECTIONS 2 & 3

DREXEL TERRACE

MATCH LINE

UNLESS OTHERWISE NOTED