

#16083 Filed This 7th day of Dec. 1967
And Recorded in Vol. 4 V V Page 145 at 1:52 P.M.

Ollie Farnsworth

Register Mesne Conveyance Greenville County, S. C.

VVV-145

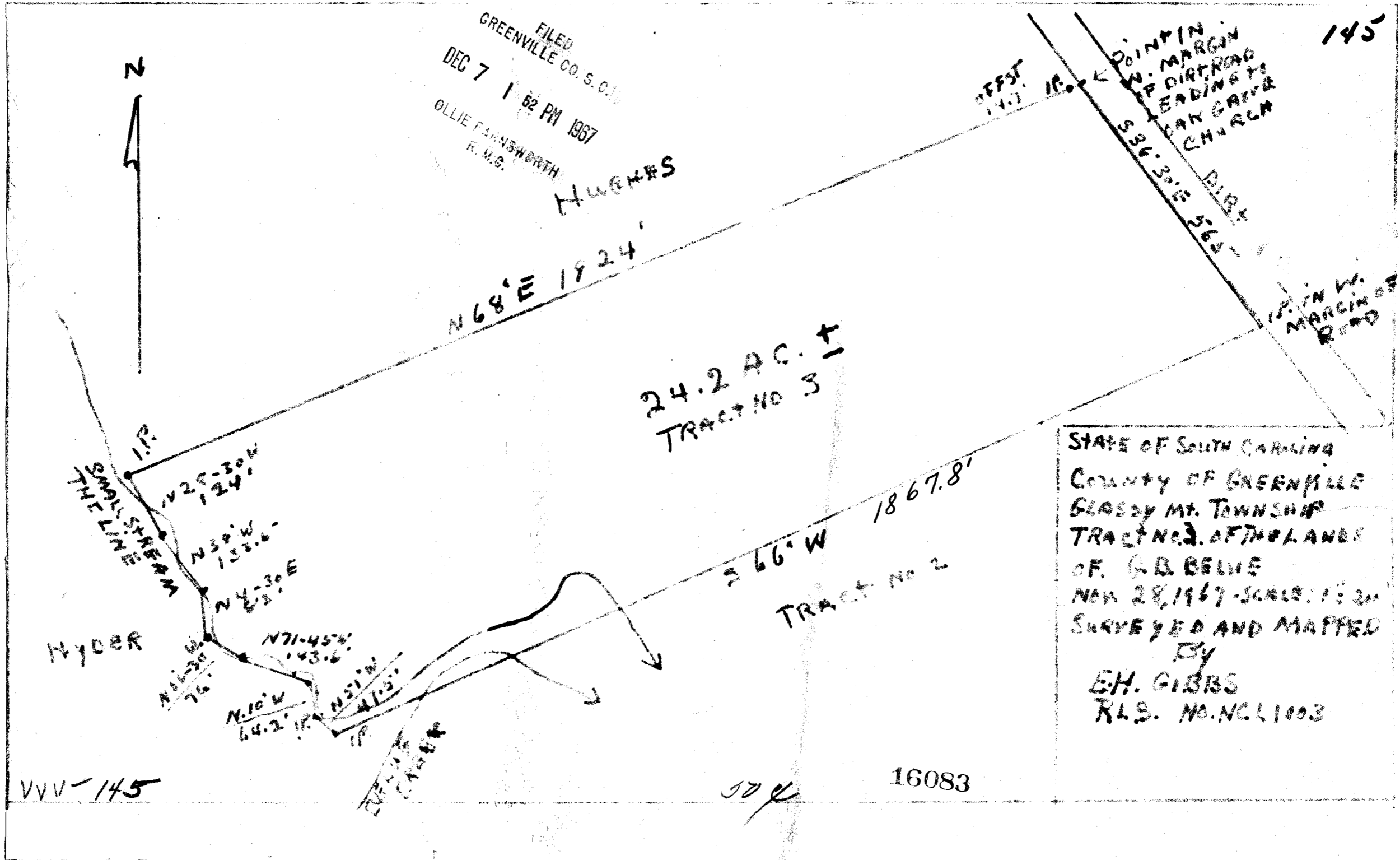

STATE OF SOUTH CAROLINA
 COUNTY OF GREENVILLE
 GLASSY MT. TOWNSHIP
 TRACT NO. 3. OF THE LANDS
 OF G. B. BELUE
 NOV 28, 1967 - SCALE: 1" = 20'
 SURVEYED AND MAPPED
 BY
 E.H. GIBBS
 R.L.S. NO. NCL 1003