

# 13954 and 13955  
 And Recorded in TTT-67 at 2:15 P.M.  
 Register Messrs. Conyers & Greenville County, S. C.

Plat Book-TTT-Page 67

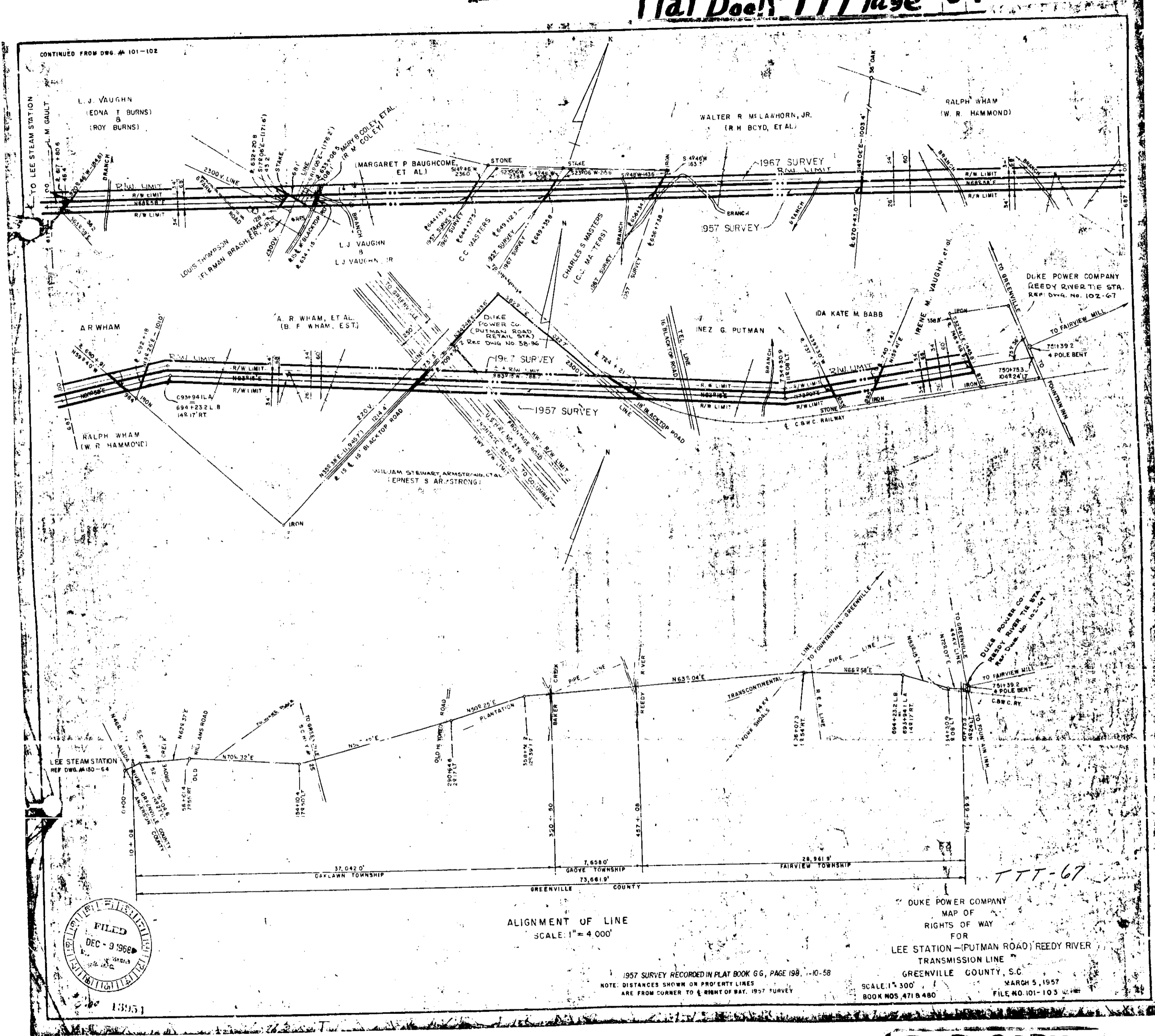

ALIGNMENT OF LINE  
 SCALE: 1" = 4,000'

1957 SURVEY RECORDED IN PLAT BOOK GG, PAGE 198, 1-10-58  
 NOTE: DISTANCES SHOWN ON PROPERTY LINES  
 ARE FROM CORNER TO E RIGHT OF WAY, 1957 SURVEY

DUKE POWER COMPANY  
 MAP OF  
 RIGHTS OF WAY  
 FOR  
 LEE STATION-(PUTMAN ROAD) REEDY RIVER  
 TRANSMISSION LINE  
 GREENVILLE COUNTY, S.C.

SCALE: 1" = 300'  
 800K NOS. 471 & 480  
 MARCH 5, 1957  
 FILE NO. 101-103

BAD COPY

