

#13954, Plat Title 9, and of Rev. W 68
And Recorded in Vol. TTT, Page 65 at 2:15 P.M.
Ollie J. ...
Register of Deeds, Greenville County, S. C.

Plat Book-TTT-Page 65

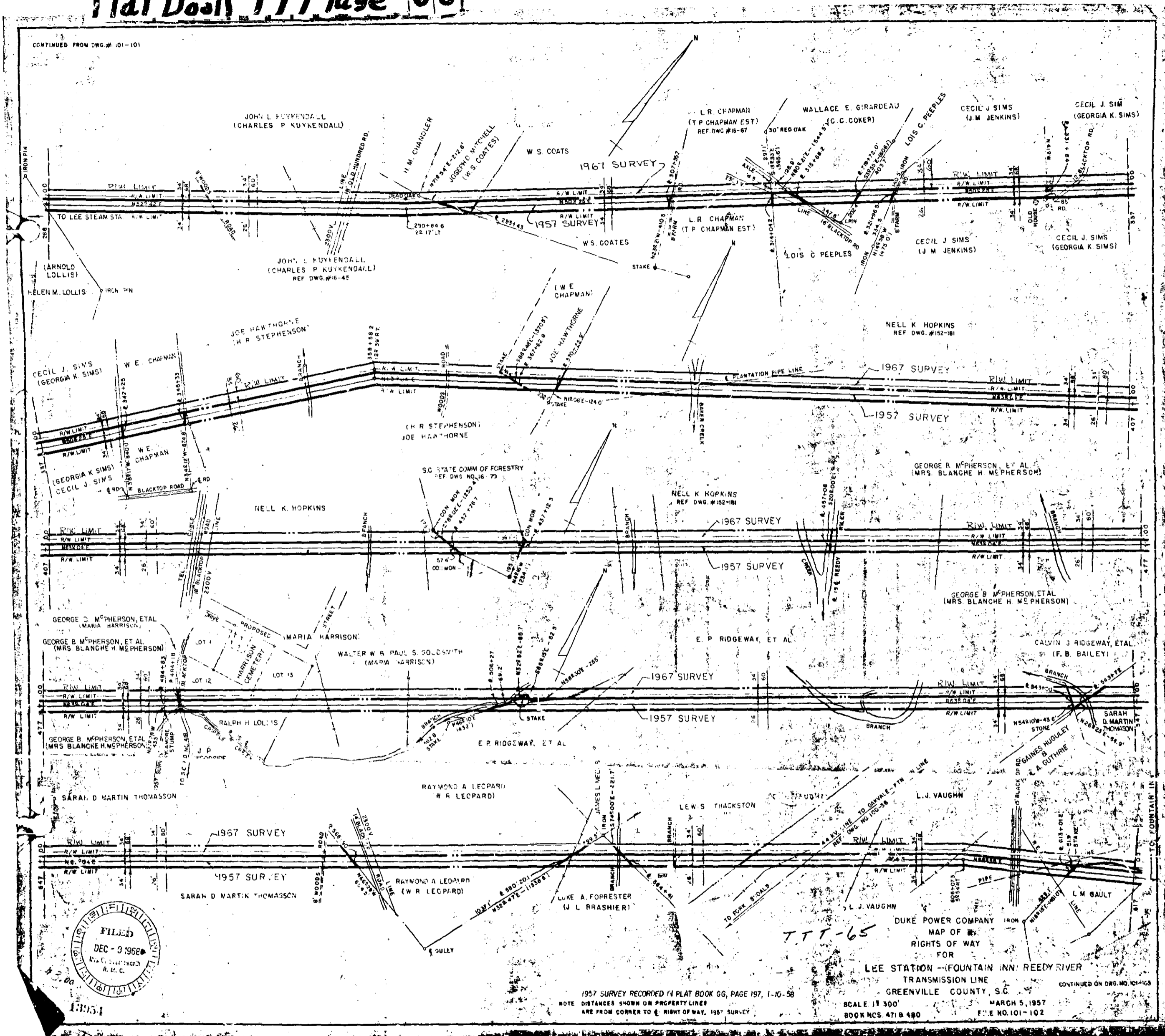

FILED
DEC-3-1968
R.M.C.

1957 SURVEY RECORDED IN PLAT BOOK 66, PAGE 197, 1-16-58
NOTE: DISTANCES SHOWN ON PROPERTY LINES
ARE FROM CORNER TO E. RIGHT OF WAY, 1957 SURVEY

SCALE 1" = 300'
BOOK MCS. 471 B 480
MARCH 5, 1957
FILE NO. 101-102

I BAD COPY

