

Plat Book SSS Page 184

APR 25 11 43 AM '66
 OLLIE FARNSWORTH
 R.M.C.

SSS-184

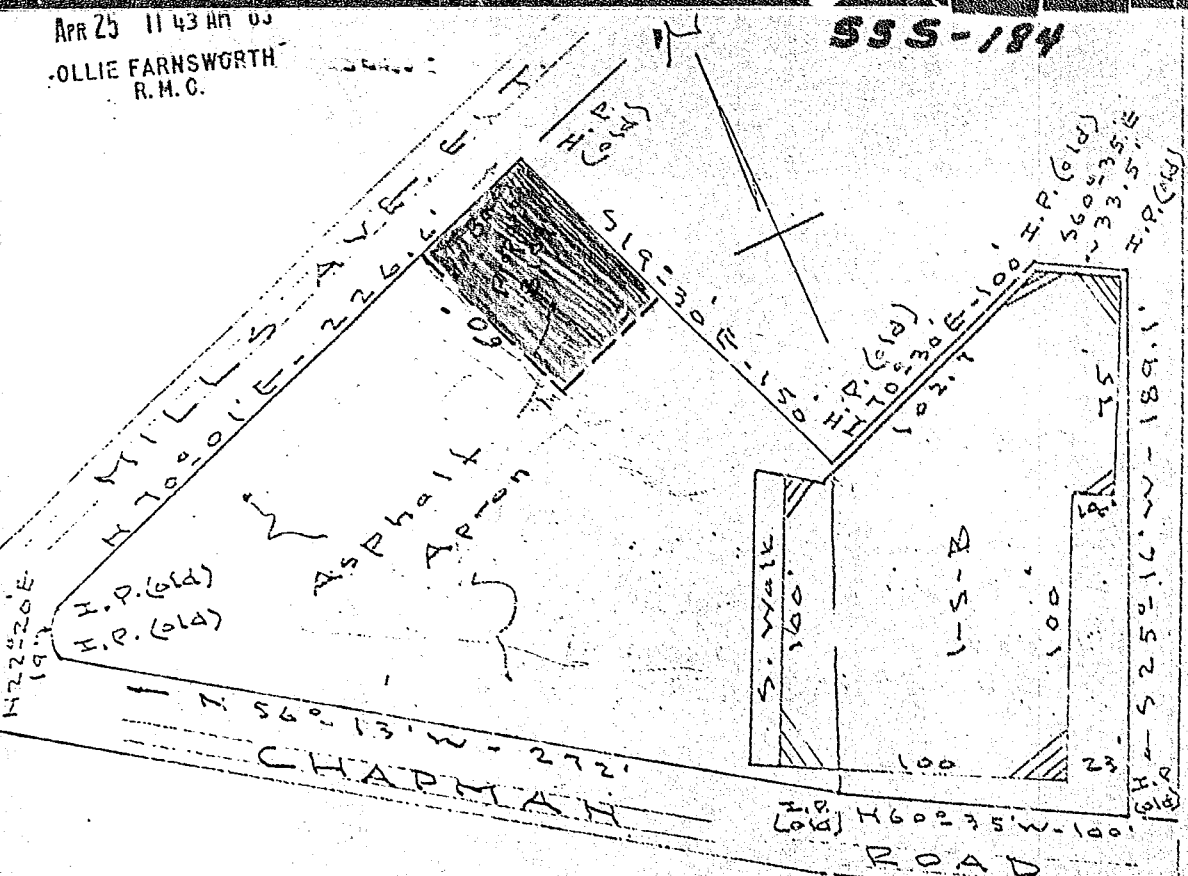

PROPERTY OF
 E. W. DUCKWORTH
 Part of Duncan Mills sub - J.P. Stevens Co.
 near Greenville - S.C.
 Scale 1" = 50' - Oct - 3 - 1961

This is to certify that on the 3rd. day of October, 1961. I surveyed the property shown on this plat, being known as part of Duncan Mills Subdivision--J.P. Stevens Property, recorded in Plat Book "S" at Page 173--Office of R.M.C. for Greenville Co., South Carolina, and that the property lines, walls and buildings are as shown hereon; that the buildings located on said lot do not encroach or project on adjacent streets or property, and that no adjacent buildings, or walls, encroach, or project on said premises.

100

SSS-184

J. E. Shoop
 Registered Land Surveyor.

Recorded April 28, 1969 at 11:43 A. M., #25574.

"S"-173