

SSS-112

MRS. N. M. HALE

OTHER PROPERTY OF JAMES P. & LOUISE MULLIGAN

S-S 19-A-E 231.0

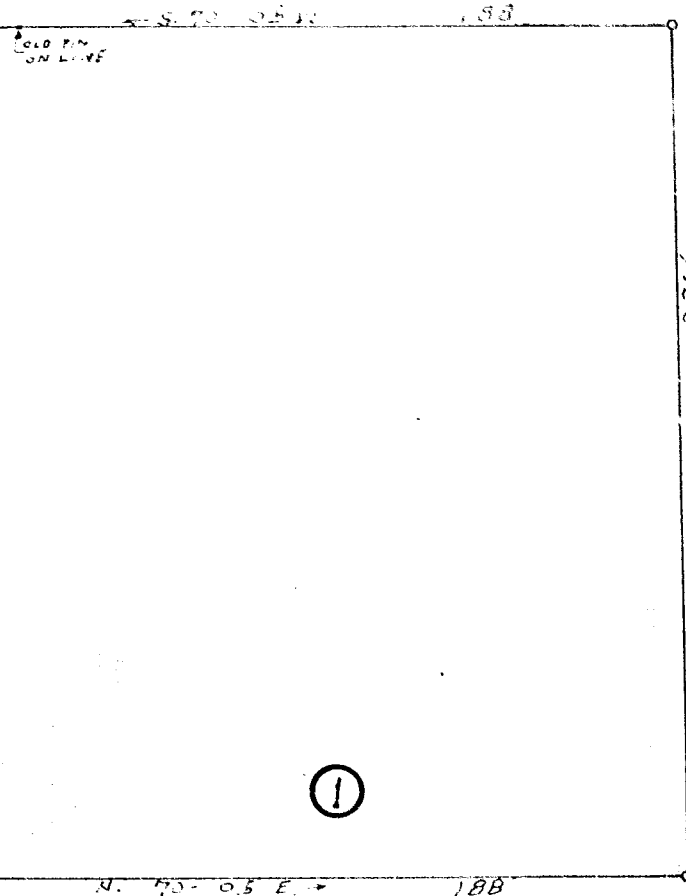

JOHN STEVENSON

PROPERTY OF
JAMES P. & LOUISE MULLIGAN

LOCATED TWO MILES SOUTH OF TAYLORS

CHICKSPRINGS TOWNSHIP GREENVILLE COUNTY

SOUTH CAROLINA

SCALE: 1" = 40 FEET FEB. 15 1968

SURVEYED FEB. 5 1968

FILED
GREENVILLE CO. S.C.
SEP 11 4 30 PM 1968

H. S. BROCKMAN, REG. SURVEYOR
GREER, S.C. No. 959

6289 SSS-112

AREA: 1.00 ACRE Recorded Sept. 11, 1968 at 4:30 P.M. #6289.

1.00 photo
06 James P. Mulligan
Pt. 3 Taylors, S.C.
Sun Rise Dr.