

INFORMATION
 DRILL HOLES FOR ROCK CHECK

- P-1 SHALE AT 3.5' DRILLED TO 20'
- P-2 DRILL REFUSAL AT 15'
- P-3 DRILL REFUSAL AT 17.5'
- P-4 DRILLED TO 20' NO ROCK
- P-5 DRILLED TO 20' NO ROCK
- P-6, P-7, P-8, P-9 DRILLED TO 20' NO ROCK

SOME SHALE AND BULDERS EVIDENT
 EXCAVATION POSSIBLE WITHOUT BLASTING

PLAT FOR
HUMBLE OIL & REFINING COMPANY

ON U.S. 25 NEAR I-85
 GREENVILLE, S.C.

WEBB SURVEYING & MAPPING CO.

SCALE 1" = 20' MARCH 15, 1967

JUN 26 1967
 3:55 P.M.
 R.M.C.

CHARLES E. WEBB
 REGISTERED
 1577
 LAND SURVEYOR
 SOUTH CAROLINA

000-123

120

JUN 26 1967
 3:55 P.M.

R.M.C.

2 plates
 2-120 Filed This 26 day of June 19 67
 And Recorded in Vol. 200 Page 423 of 3:55 P.M.
 Register Mesne Conveyance Greenville County, S. C.

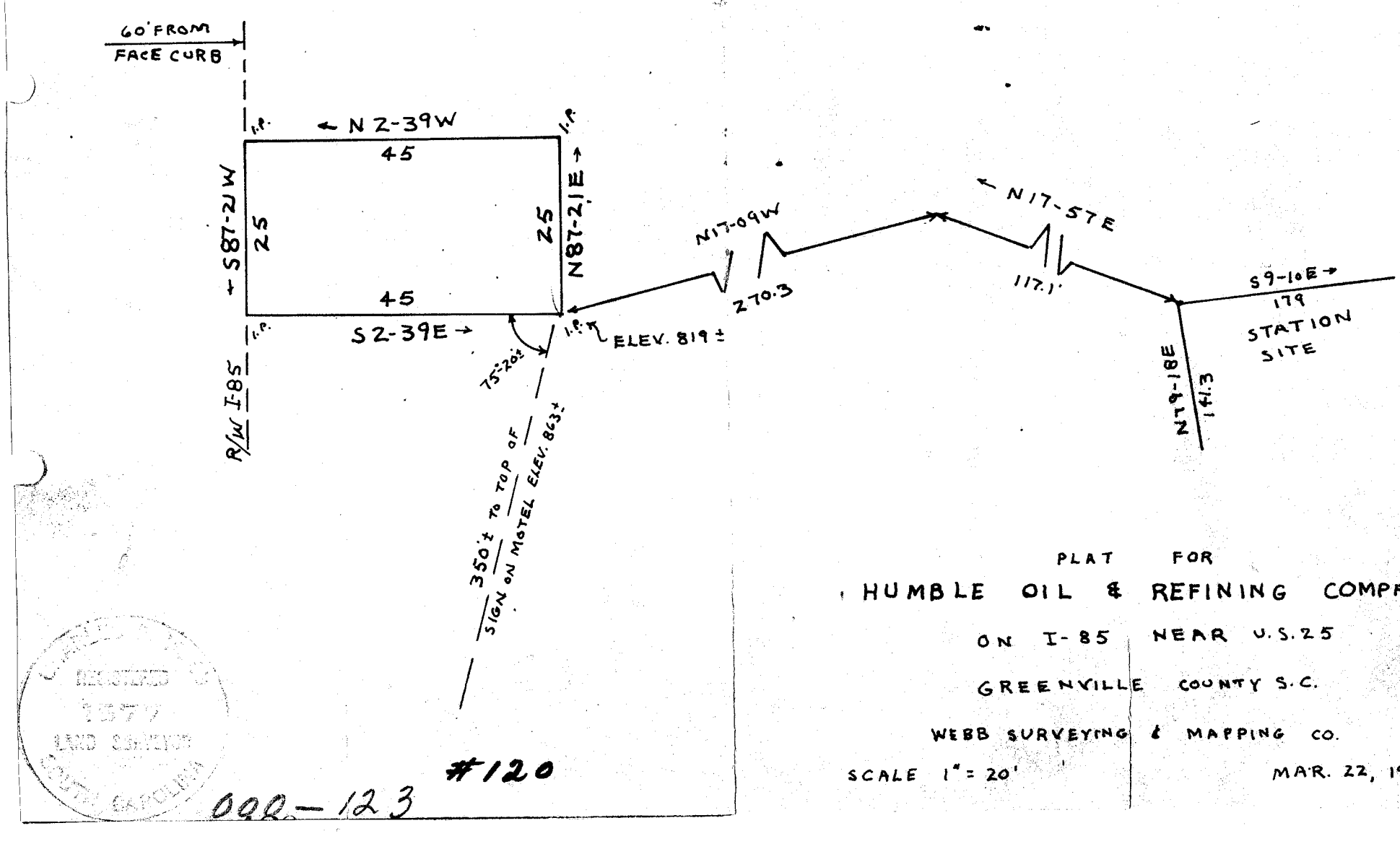

REGISTERED
 1577
 LAND SURVEYOR
 SOUTH CAROLINA

000-123 #120