

AUG 9 3 09 PM 1965

BON AIRE DRIVE

WATER IN ST. R/W

S 32-35E -> 149.2'

325.9 TO EAST BUTLER AVE

50.5'

86.7'

OLLIS BARR NORTH R.M.C.

HALF OF LOT 5

158.8 - N 50-29E

HALF OF LOT 5

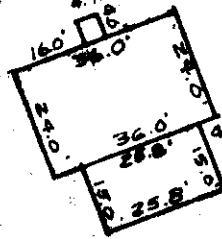

SEPTIC TANK ON LOT 6

50.0'

98.0'

153.0' - N 39-28W

PROPERTY OF
ALFRED P. & MAUDIE C. GILLIAM
 MAULDIN, SOUTH CAROLINA
 SCALE 1"=40' 30 JULY 1965

This is to certify that on the 30th day of July 1965, I surveyed the property shown on this plat, being known as lot 6 and half of lot 5 on plat of property of C.D. CHRISTOPHER recorded in the R.M.C. Office of Greenville County, S.C. in plat book "00" page 226; also known as property of ALFRED P. & MAUDIE C. GILLIAM recorded in the R.M.C. Office in plat book page ; and that the property lines, walls, and buildings are as shown hereon, and that the buildings located on said lot do not encroach or project onto adjacent street or property and that no adjacent walls or buildings encroach or project onto said premises.

R. B. Bruce
 R.B. Bruce, R.L.S. #1952

4508
 AUG 9
 1965

CAROLINE ENGINEERING AND SURVEYING COMPANY
 GREENVILLE, S.C.

150
 KKK-81

4508 Filed This 9 day of Aug 19 65
 And Recorded in Vol. KKK Page 81 at 3:09 PM.
Odessa Kamsworth
 Register Mesne Conveyance Greenville County, S. C.