

666-540

11111-148
LOT FOR
BLANT C. & MARGARET
WESTMORELAND
N 10-15 W → 172.25 FT

E. COLEMAN ROAD

579.45 E → 200.2 FT

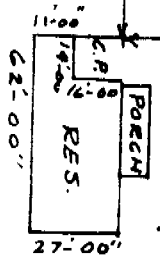

J.P. ← N. 80-37 W 195.2 FT.
J.D. VAUGHN LAND.

I.P. ← S. 11-57 W 168.2 FT
ERNEST B. COLEMAN

205 FT

O.M. PEEP LINE

ENOREE RIVER GAGE ROAD
To BATESVILLE ROAD
1/2 MI.

To U.S. GAGE STA. → 1/2 MI.



8023 V
PLAT OF LOT FOR
ERNEST B. COLEMAN
BUTLER TWP. GREENVILLE CO.
SOUTH CAROLINA

100
Picture

This is to certify that on 30th day of August 1967, I surveyed the above Shown lot and that the Bearings and Distances are as shown on Map and the Building is located as shown being under construction, and that there are no encroachments, except electric supply line for building on lot of any nature Signed Henry D. Bull Reg. C. & G.L.S. No. 10455. SCALE 1" = 50'