

14491

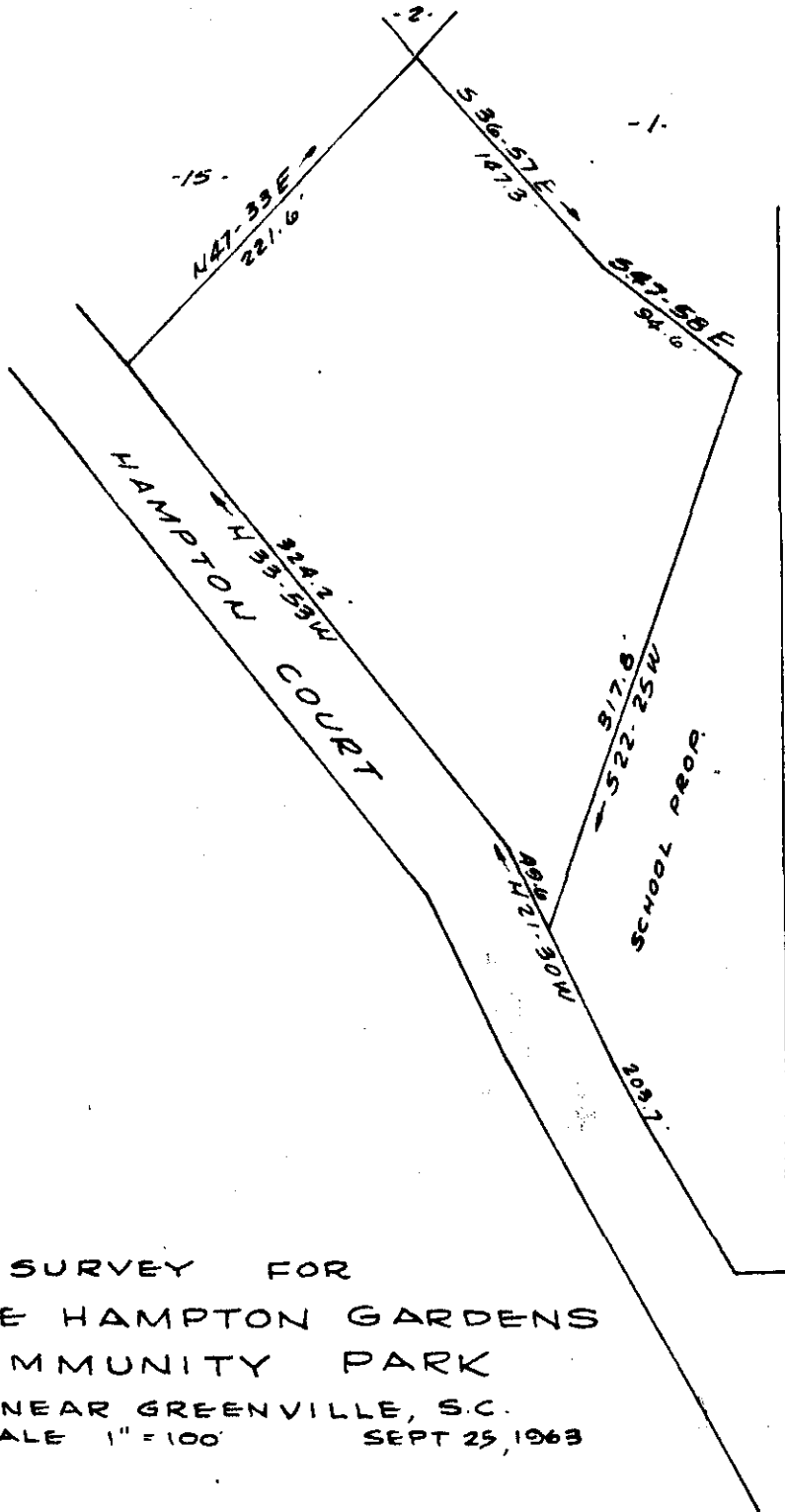

SURVEY FOR  
 WADE HAMPTON GARDENS  
 COMMUNITY PARK  
 NEAR GREENVILLE, S.C.  
 SCALE 1" = 100' SEPT 25, 1963

FILED  
 GREENVILLE CO. S.C.

NOV 15 4 16 PM 1963

OLLIE F. BARNWELL  
 R.M.C.

*The Donald + Co*

*See 506*

*EEC-109*

CAROLINA ENGINEERING & SURVEYING CO.  
 GREENVILLE, S.C.

14491 Filed This 15 day of Nov. 19 63

And Recorded in Vol. EEE Page 109 at 4:16 p.m.

*[Signature]*  
 Register Mesne Conveyance Greenville County, S. C.