

J. B. & RUTH A. BREWER

N 28-07 E 750'

J. B. & RUTH A. BREWER
N 47-17 W 350'

5.89 Acres

S 28-00 W 750'

LEDBETTER

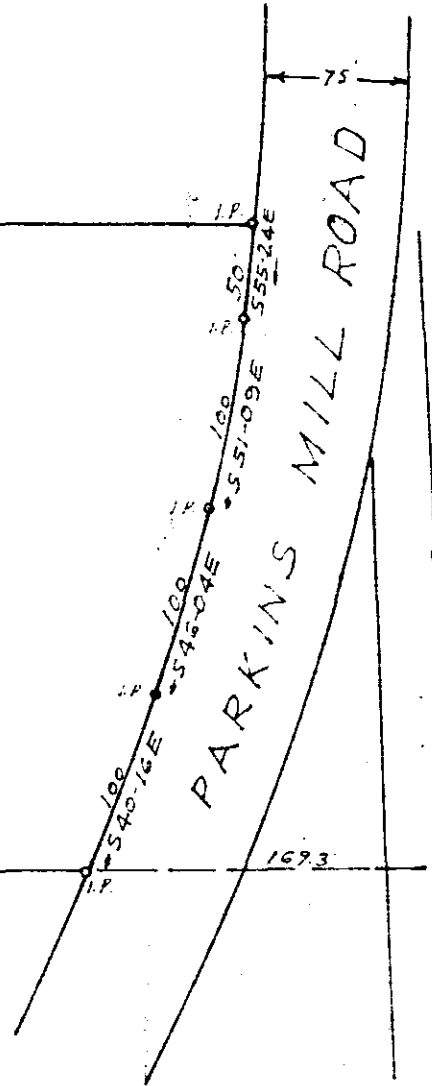

SEP 11 1963

7776

PROPERTY OF
W. T. CASSELS JR.
NEAR GREENVILLE S.C.

SCALE 1"=100'

SEPT. 2, 1963

FILED
SEP 11 3 55 PM 1963
GREENVILLE CO. S.C.
OLLIE JAMNORTH
R.M.G.

* 7776
11 Sept. 1963
FEE
Ollie Jamnouth
Register of Deeds Greenville County, S. C.

888-1

P.O. Riddle - Reg. L.S. # 1347