



THIS IS TO CERTIFY THAT I SURVEYED THE PROPERTY SHOWN HEREON AND ACCORDING TO THE SURVEY AND WATER EXCHANGING TREATMENT PLANT WITHIN A 1/4 MILE OF CHARLES RIVER. THIS SURVEY AND TREATMENT PLANT (SEE BOOK) TO BE USED AS A REFERENCE FOR THE SEWER DIST. LINE.

48-78

Property of the G.G.S.D.

JAN 24 1963

FILED
 GREENVILLE CO. S.C.
 JUN 24 3 31 PM 1963
 OLLIE FARMWORTH
 R.M.C.
 18781

PLAT OF A PORTION OF
 E.H. EARLE PROPERTY
 NEAR GREENVILLE S.C.
 SCALE 1"=200' JUNE 12, 1963
 FILE NO. 130.70
 rec. Jan. 4, 1963 Approved John P. Spencer
 Jan 21, 63 Supt.

8b

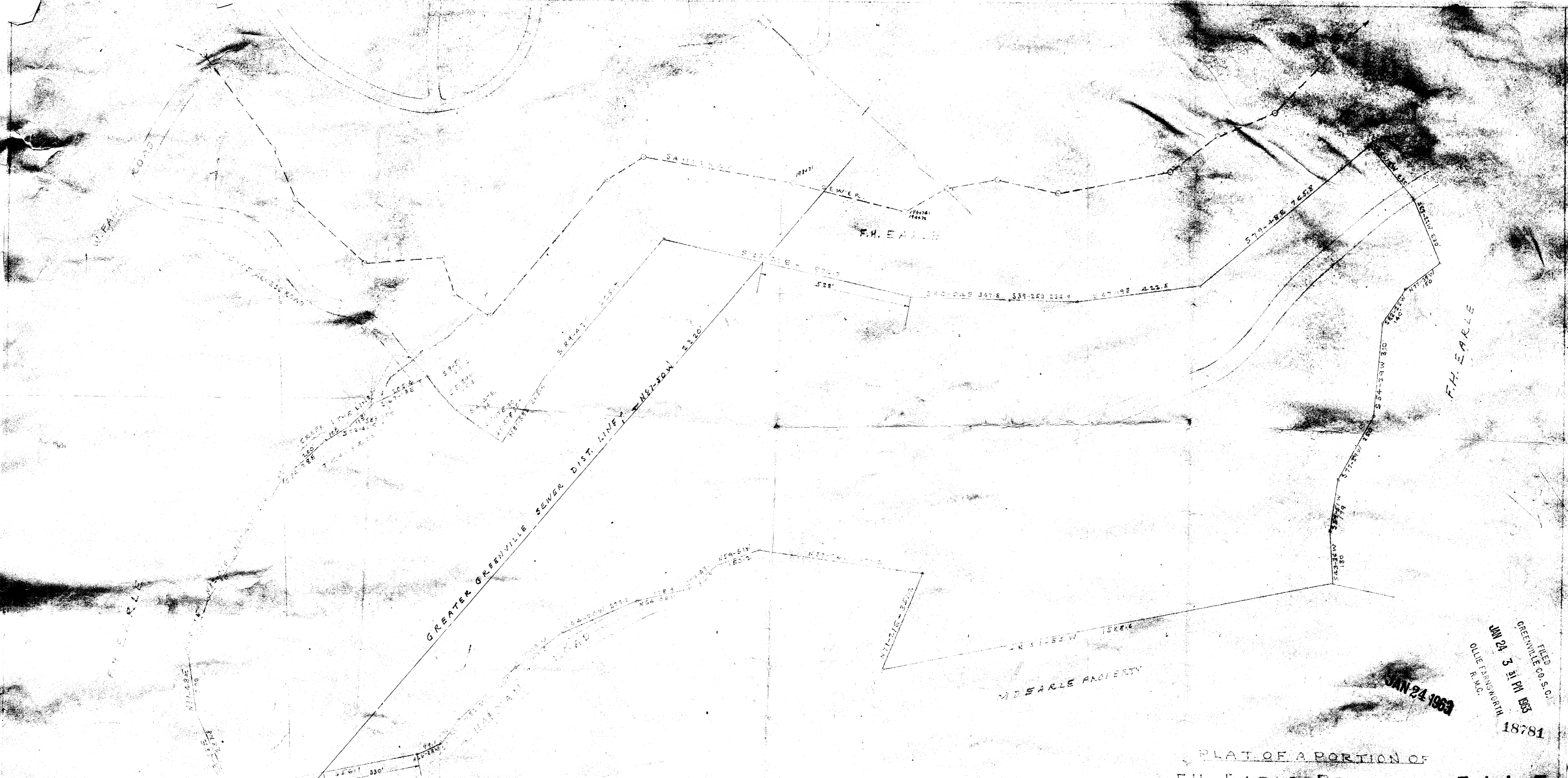

THIS IS TO CERTIFY THAT I SURVEYED THE PROPERTY SHOWN HEREON AND FOUND ACCORDING TO THE SURVEY I AM MAKING EXCLOSING THE AREA WITHIN R.W. OF CHAIRS... FOUND OF THIS SURVEY, AND THAT THERE ARE NO (NOT SHOWN) TO BE USED AS... CONTAINING... MEET

Property of the G.G.S.D.

PLAT OF A PORTION OF
 F.H. EARLE PROPERTY
 NEAR GREENVILLE, S.C.

FILE
 SECT. 2
 DRAW. 8
 DIV.

FILE No. 130.70
 rec. Jan. 4, 1963
 Approved John P. Spencer
 Jan 21, 63
 Supt

FILED
 GREENVILLE CO. S.C.
 JUN 24 3 31 PM 1963
 OLIE FARMWORTH
 R.N.C.
 18781