

REF. TRACT #2 ESTATE OF J. E. FARROW  
FILED IN PL BK 'L', PAGE 93

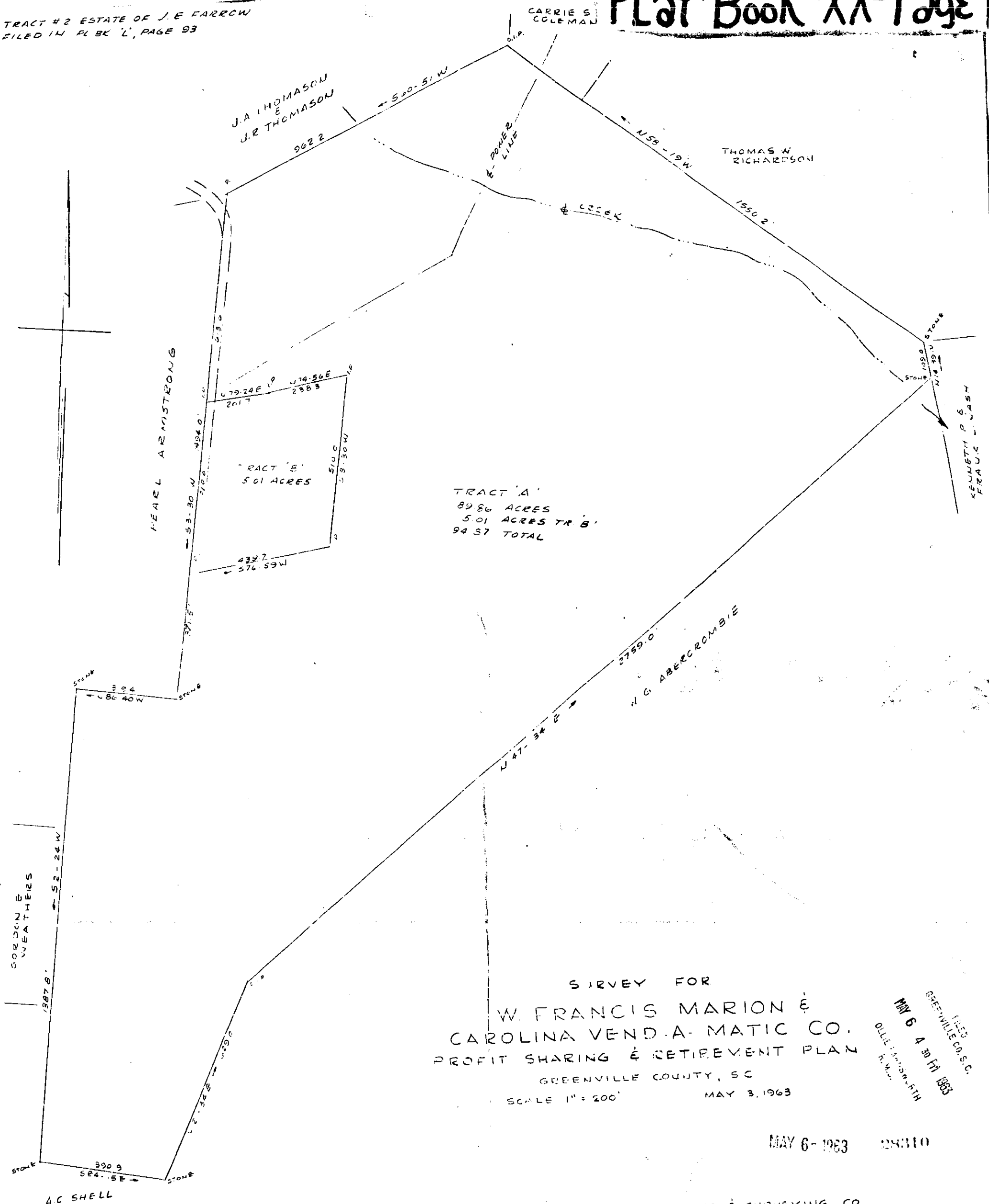

TRACT 'A'  
89.86 ACRES  
5.01 ACRES TR. B'  
94.87 TOTAL

SURVEY FOR  
W. FRANCIS MARION &  
CAROLINA VENDOR-MATIC CO.  
PROFIT SHARING & RETIREMENT PLAN  
GREENVILLE COUNTY, SC  
SCALE 1" = 200' MAY 3, 1963

FILED  
GREENVILLE CO., S.C.  
MAY 6 4 30 PM 1963  
OLLE J. ANDERSON, F.T.H.  
R.M.

MAY 6-1963 28310

CAROLINA ENGINEERING & SURVEYING CO  
GREENVILLE, S.C.

**BAD COPY**

28310 Filed This 6 day of May 19 63  
And Recorded in Vol. 77 Page 133 at 11  
Register Mesne Conveyance Greenville County, S. C.