

Plat Book-R R-Page 95

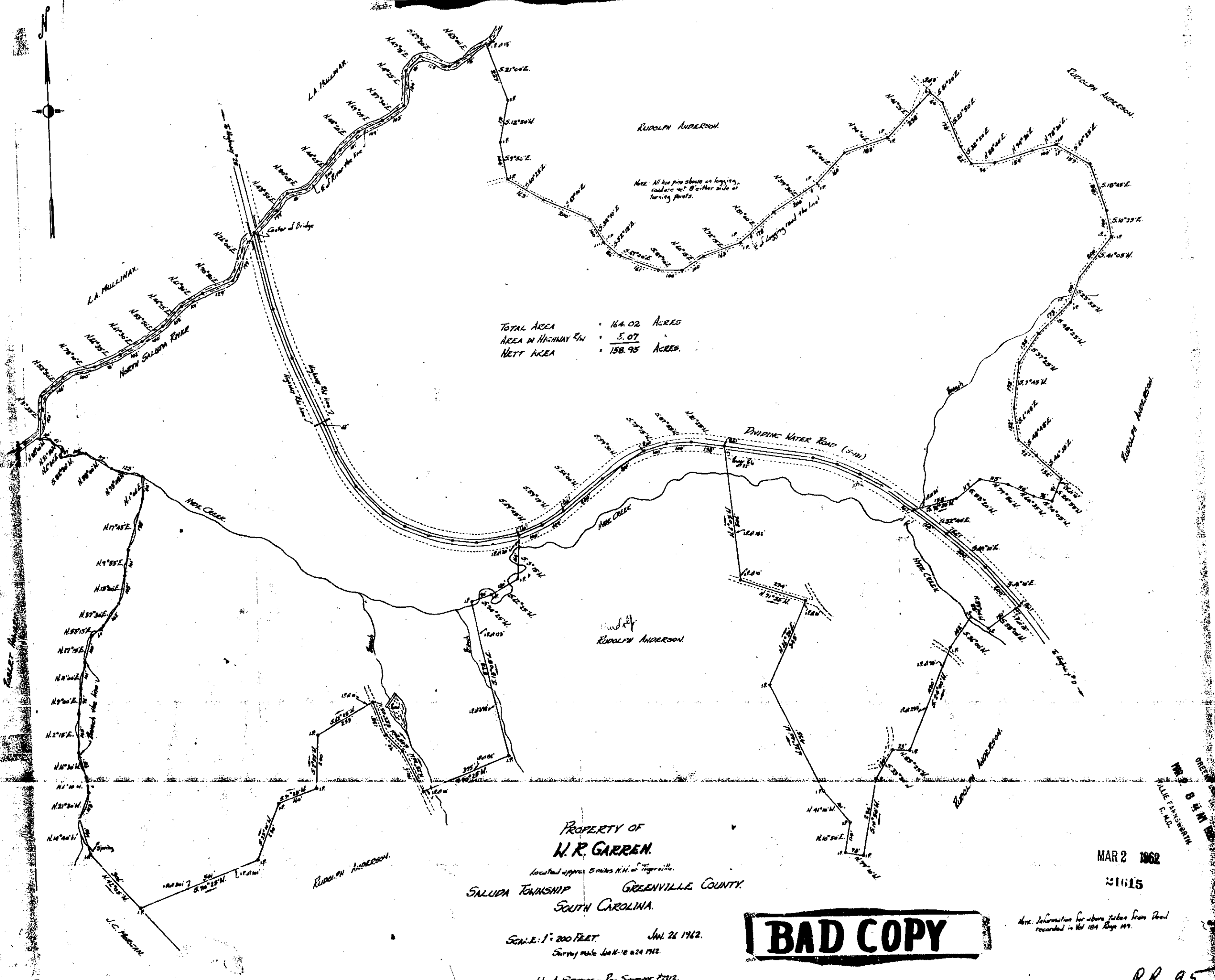

TOTAL AREA = 164.02 ACRES
 AREA IN HIGHWAY R/W = 5.07
 NETT AREA = 158.95 ACRES

PROPERTY OF
N. R. GARREN.

located approx 5 miles N.W. of Tryonville.

SALLIDA TOWNSHIP GREENVILLE COUNTY.
 SOUTH CAROLINA.

SCALE: 1" = 200 FEET
 Survey made Jan. 18 & 21 1962.

John A. Simmons - Reg. Surveyor #2212.
 GREEN, S.C.

BAD COPY

MAR 2 1962
 21615

Note: Information for above taken from Plat recorded in Vol 184 Page 149.

R.R. 95

21615 Plat Book R of Vol. 184
 and Recorded in Vol. R.R. Page 95
 Registered in Greenville County, S.C.