

1 1000 1000 1000

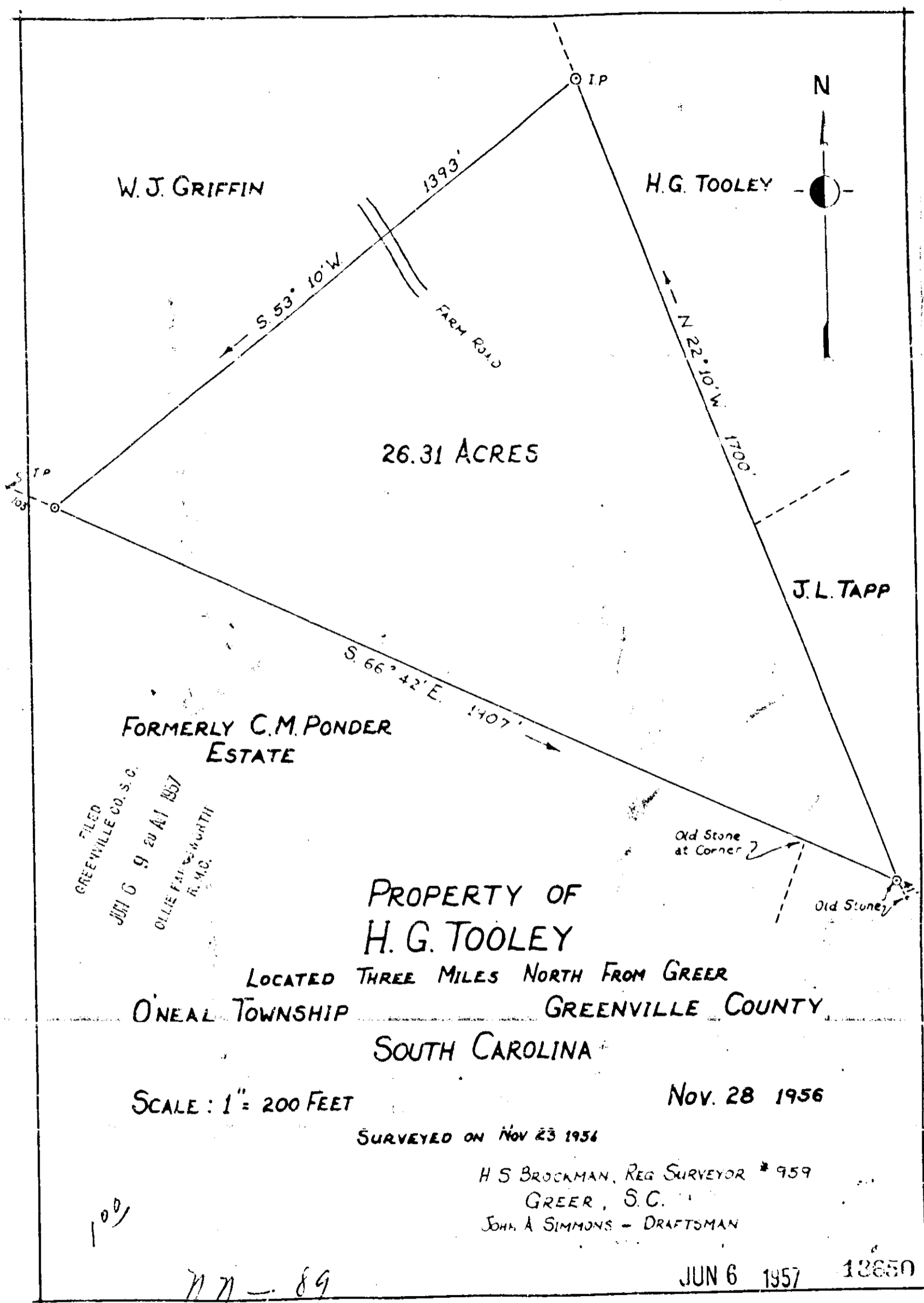

FILED
 GREENVILLE CO. S.C.
 JUN 6 9 20 AM 1957
 OLLIE FAULKNER MORTHE
 R. M.D.

PROPERTY OF
H. G. TOOLEY
 LOCATED THREE MILES NORTH FROM GREER
 ONEAL TOWNSHIP GREENVILLE COUNTY
 SOUTH CAROLINA

SCALE: 1" = 200 FEET
 SURVEYED ON NOV 23 1956
 NOV. 28 1956

H S BROCKMAN, REG SURVEYOR * 959
 GREER, S.C.
 JOHN A SIMMONS - DRAFTSMAN

100

77-89

JUN 6 1957 13850

13850 Filed This 6 day of June 1957
 and Recorded in Vol N Page 89 at
 Greer S.C.
 Register Meuse Conveyance Greenville County, S.C.