

161

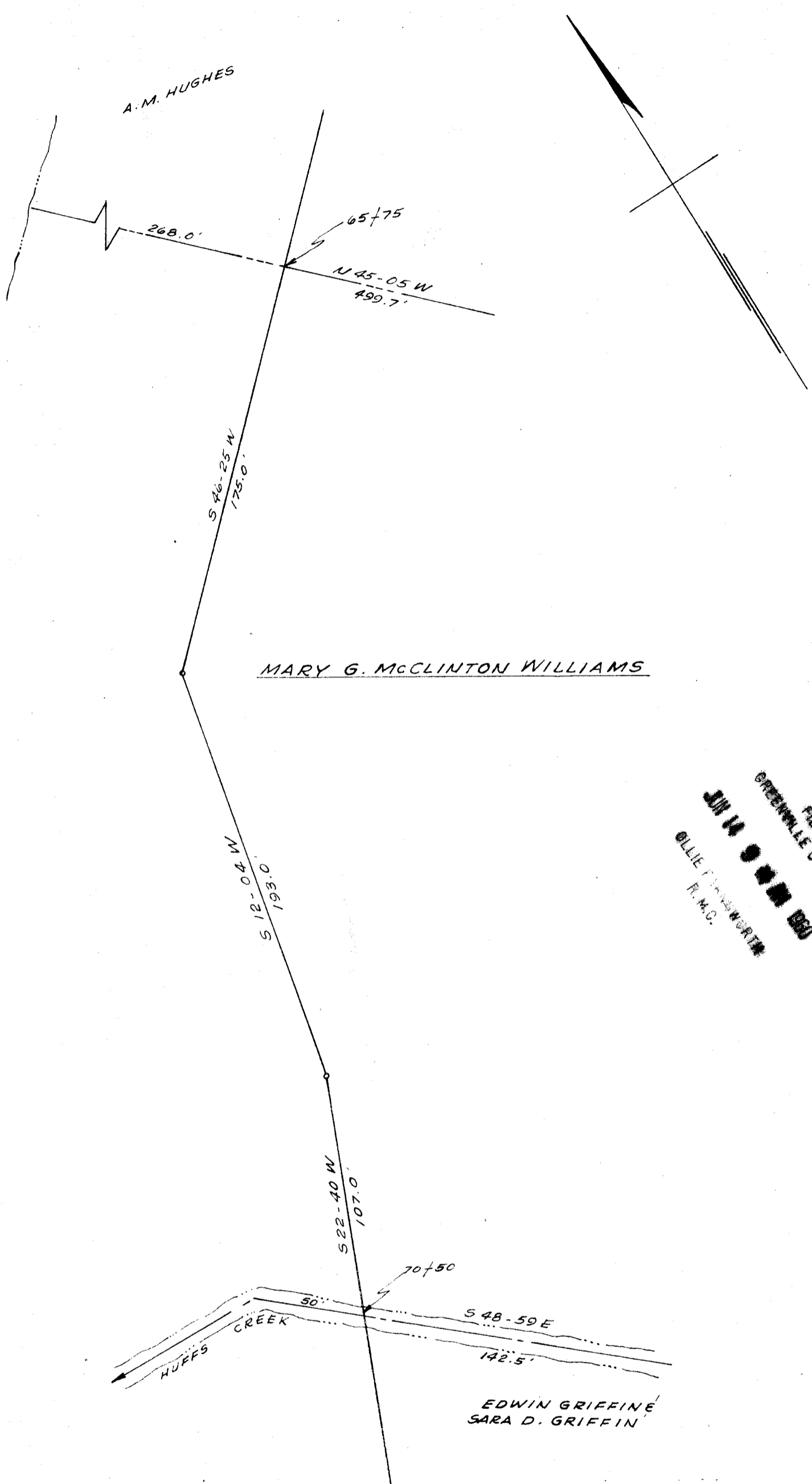

FILED
GREENVILLE CO. S. C.
JUN 14 1960
OLLIE FLEMING WORTH
R. M. G.

JUN 14 1960

34317

M W - 161

REV.	DATE	DESCRIPTION
RIGHT OF WAY PLAN FOR SANITARY SEWERAGE IMPROVEMENTS SIMPSONVILLE, SOUTH CAROLINA		
PIEDMONT ENGINEERING SERVICE GREENVILLE, S.C.		
SCALE: 1" = 50'		DATE: APRIL 1960
APPROVED BY:		<i>[Signature]</i>
DRAWN BY: <i>MTL</i>		DWG. 3 OF 5

34317 Filed This 14 day of JUNE 1960
and Recorded in Vol. M.W. Page 161 of M

34317 Filed This 14 day of JUNE 1960
and Recorded in Vol. M.W. Page 161 of M

Register Mesne Conveyance Greenville County, S. C.