

MAR 1 1956

PEN TO GOSTAL  
CHURCH  
PROPERTY

MRS. HATTIE COOLEY

~~J. H. Hammond~~

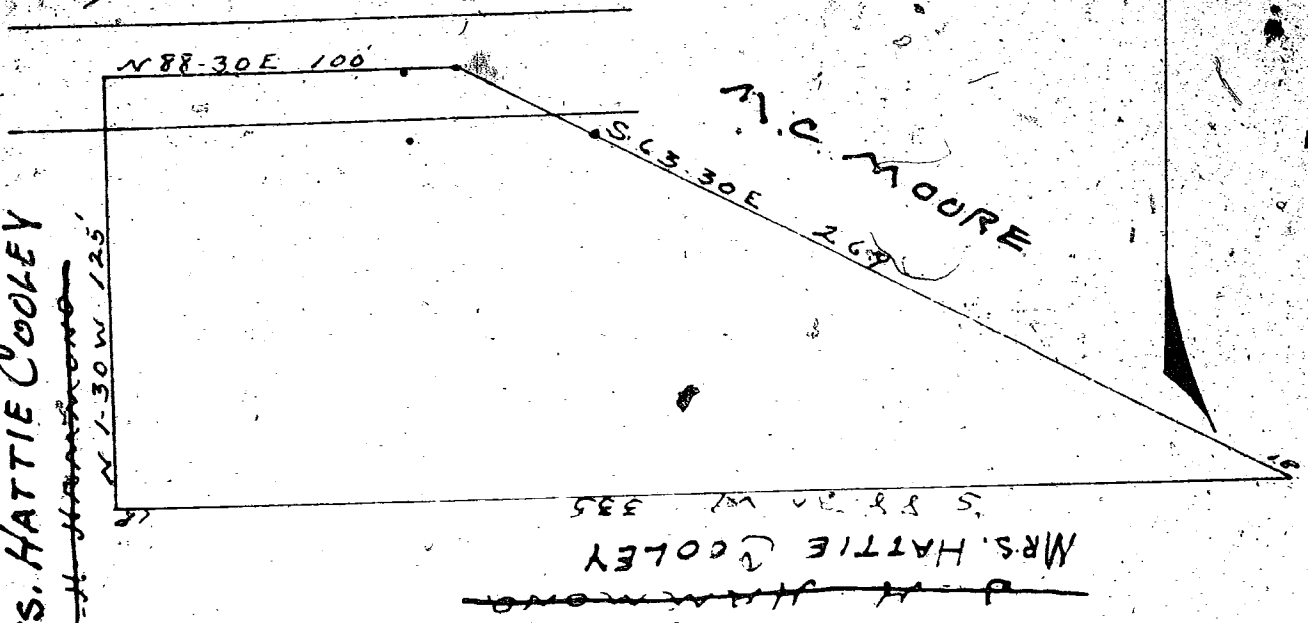

State of South Carolina  
Greenville County

MRS. HATTIE COOLEY

Plat of a lot belonging to ~~J. H. Hammond~~  
and to be deeded to the Pentecostal Church for  
the purpose of building a parsonage on  
the above lot. Rev R. C. Coon is now  
pastor.

Surveyed March 2<sup>nd</sup> 1951

J. Coke Smith

1" = 50'

Reg L.S. No. 974

Plat filed this 6 day of March 1956

and recorded in Vol. J. J. Page 135 at

Ollie Farnsworth

Registrar Messe Conveyance Greenville County, S.C.

BAD COPY

125'