

By a State of Five
Chains to an inch.

5 1/8 Acres

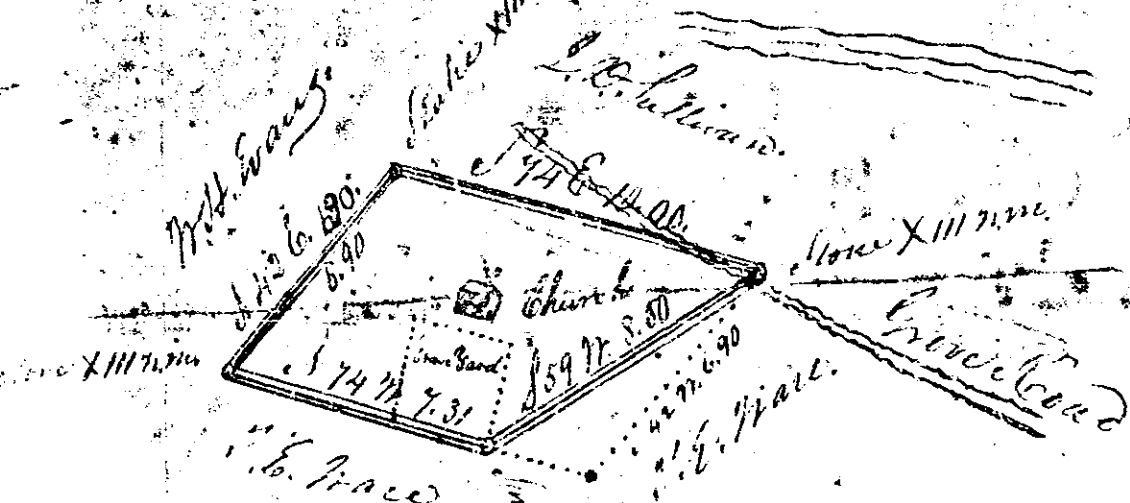

Plot of the Church Lot at
Washington, containing Five &
1/8 Acres. (Include the space as-
sented by the dotted lines & the
area would be 6 1/200 Acres)

March 21st 1860.

J. H. Sullivan
N.C.

28675

NOV 16 1956

Recorded November 16th. 1956 at
9:00 A. M. #28675