

Plat Book-BB-Page 35 B

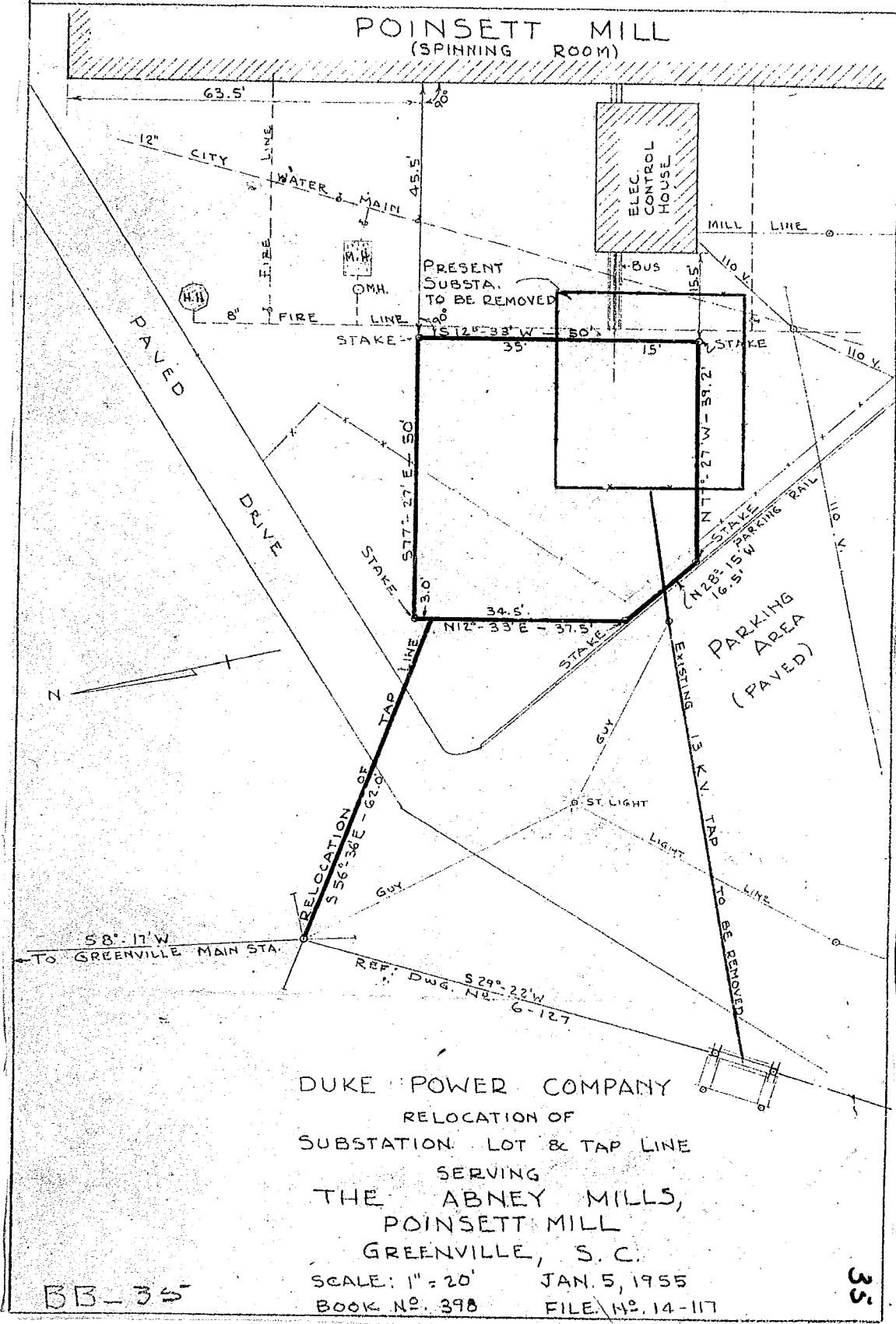

DUKE POWER COMPANY
 RELOCATION OF
 SUBSTATION LOT & TAP LINE
 SERVING
 THE ABNEY MILLS,
 POINSETT MILL
 GREENVILLE, S. C.

SCALE: 1" = 20' JAN. 5, 1955
 BOOK NO. 398 FILE NO. 14-117

BB-35

35

BAD COPY

#5103 Filed This 75 day of Feb 19 55
 And Recorded in Vol BB p. 35 at 10 P.M.
 G. S. Samson
 Register Mease Comptance Greenville County, S. C.

#11 And