

FILED
 GREENVILLE CO. S. C.
 AUG 3 10 14 AM 1951
 OLLIE FARNSWORTH
 R. M. C.

METHODIST
 CHURCH
 PROP.

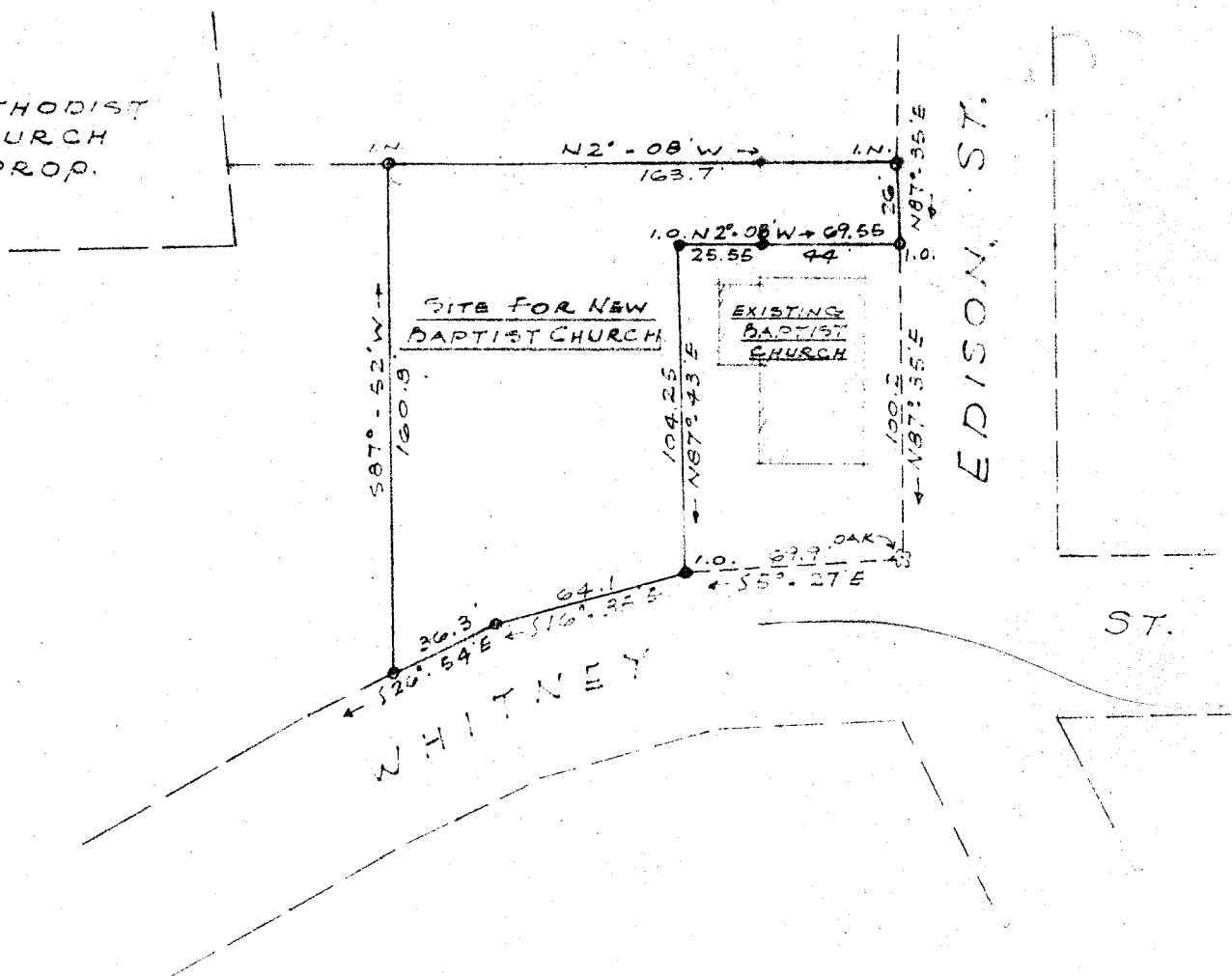

AUG 3 1951
 17898

NOTE
 ORIGINAL SUBDIVISION LINES
 ESTABLISHED BY J. E. SIRRINE
 & CO. ENGINEERS. DATE. 7-10-40.
 IRON PINS LOCATED AT ALL
 NEW CORNERS.
 BROKEN LINES REPRESENT
 THE ORIGINAL SURVEY.

PLAT SHOWING REVISIONS OF
 PROPERTY OF
 SLATER MANUFACTURING CO.
 SLATER, SOUTH CAROLINA
 PICKELL & PICKELL, ENGINEERS
 GREENVILLE, SOUTH CAROLINA
 SCALE = 1" = 60' DATE, JULY 30, 1951

1
 #17898 ~~PLAT~~ ~~THE~~ 3 ~~DAY~~ of Aug 19 51
 and Recorded in Vol. 77 Page 115 at
 Ollie Farnsworth
 Register Mesne Conveyance Greenville County, S. C.