

y-45-

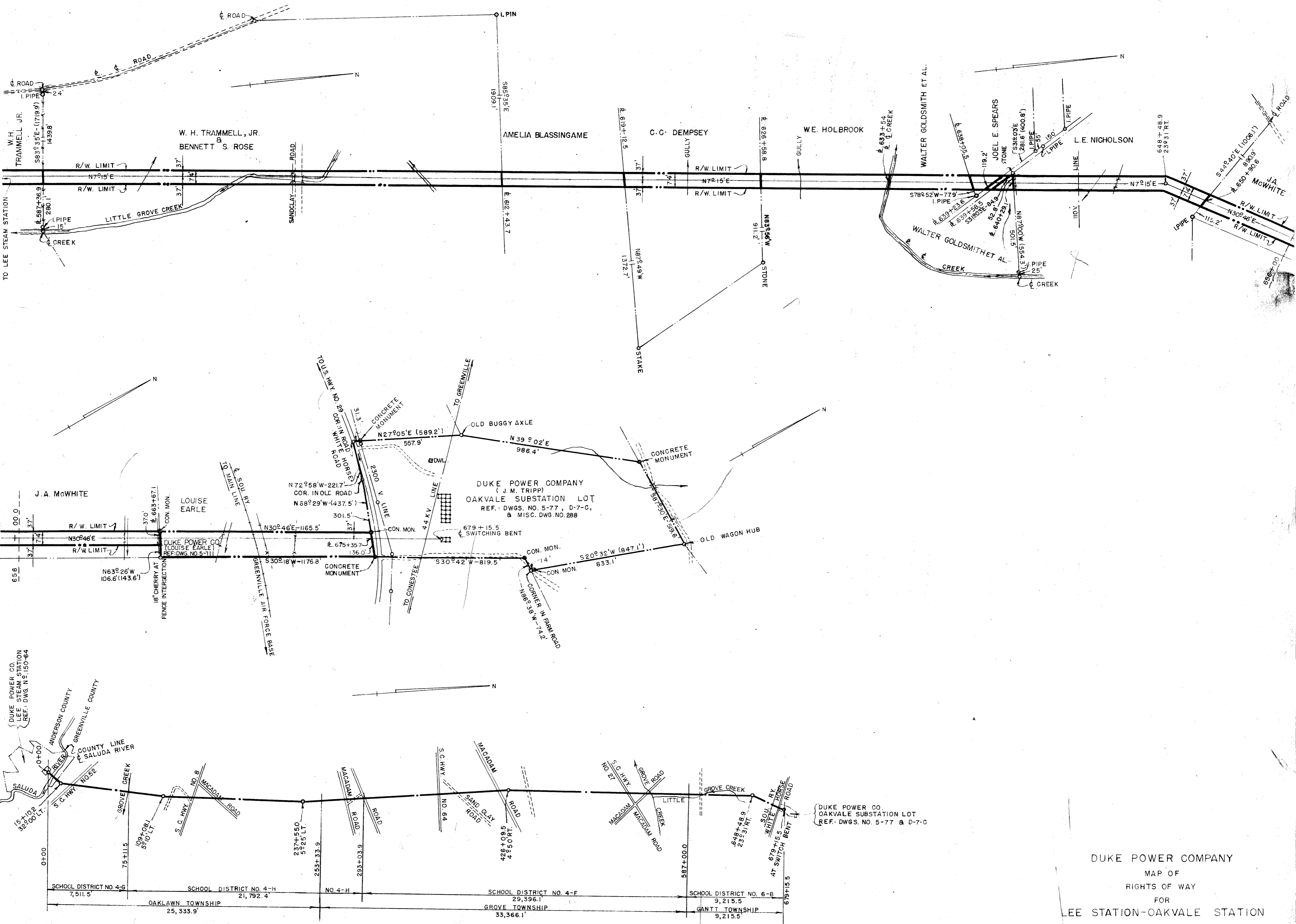

DUKE POWER COMPANY
MAP OF
RIGHTS OF WAY
FOR
LEE STATION-OAKVALE STATION
TRANSMISSION LINE
"LEE LINE"
GREENVILLE COUNTY, S.C.
SCALE: 1" = 300'
BOOKS N^o. 299 & 303
JULY 1950
FILE N^o. 100-84

#19686
This map was filed in the office of the Register of Deeds for Greenville County, S.C., on July 15, 1950, at 4:50 p.m.
Recorded by *Reid Sanson*
Register of Deeds, Greenville County, S.C.

FILED
JUL 15 1950
#19686