

#154873 - Graham, I. L.

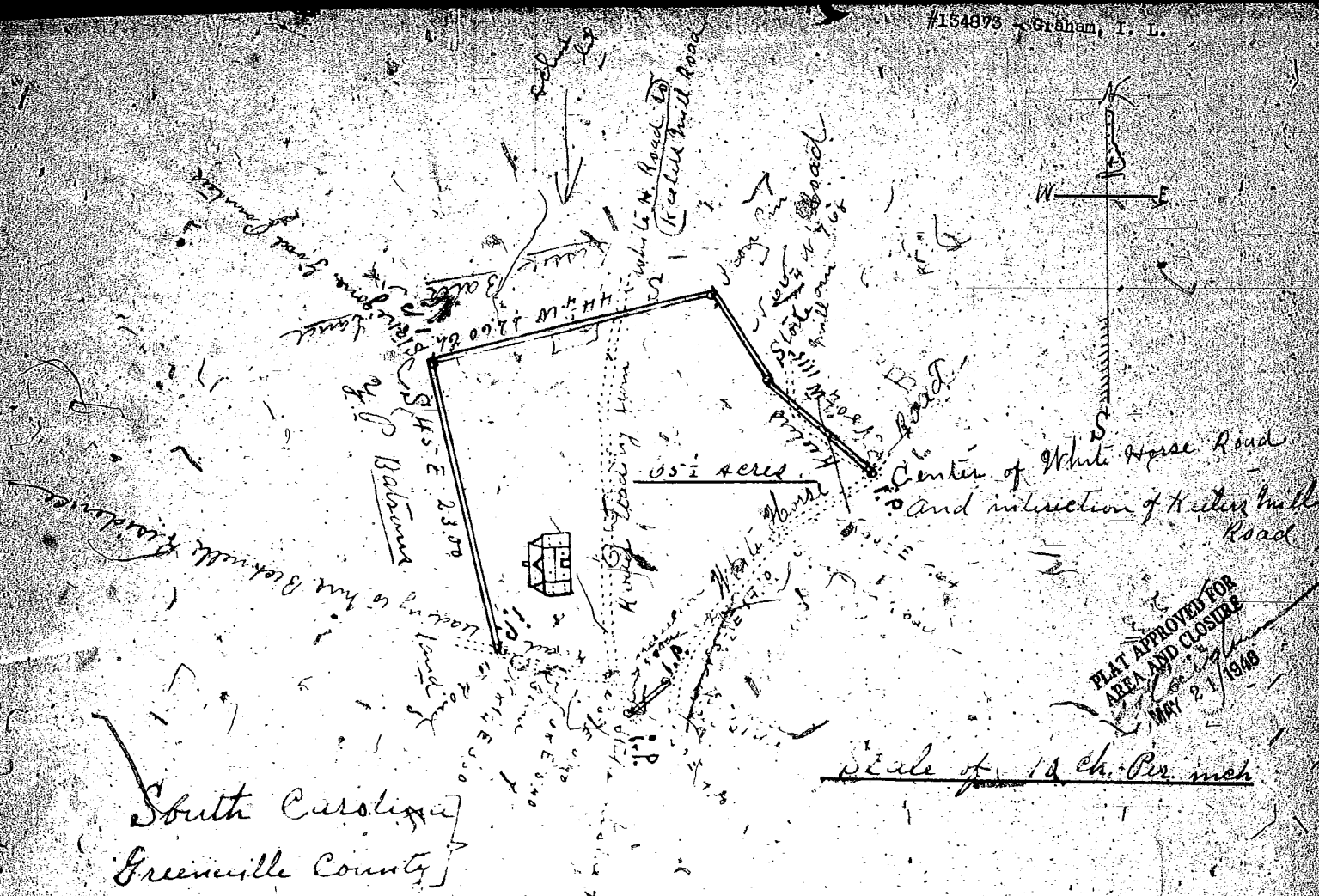

PLAT APPROVED FOR
AREA AND CLOSURE
MAY 21 1940

Scale of 1/4 Ch. Per inch

South Carolina
Greenville County

Resurveyed
June 10, 1947
W. A. Hester L.S.

By the request of V. W. McCarroll
I have resurveyed the above piece
of land on the west side of the
White Horse Road, about 11 miles
W. of Greenville S.C. and find
it to contain sixty five and a half
acres, and it has such shape, marks
and boundaries, as the above Plat
represents. Surveyed Jan. 17th 1940
W. A. Hester
Surveyor

BAD COPY