

For Substation Site Lease with Right of Way - See Deed Book 456, page 385

CONE MILLS CORPORATION
"UNION BLEACHERY DIVISION"

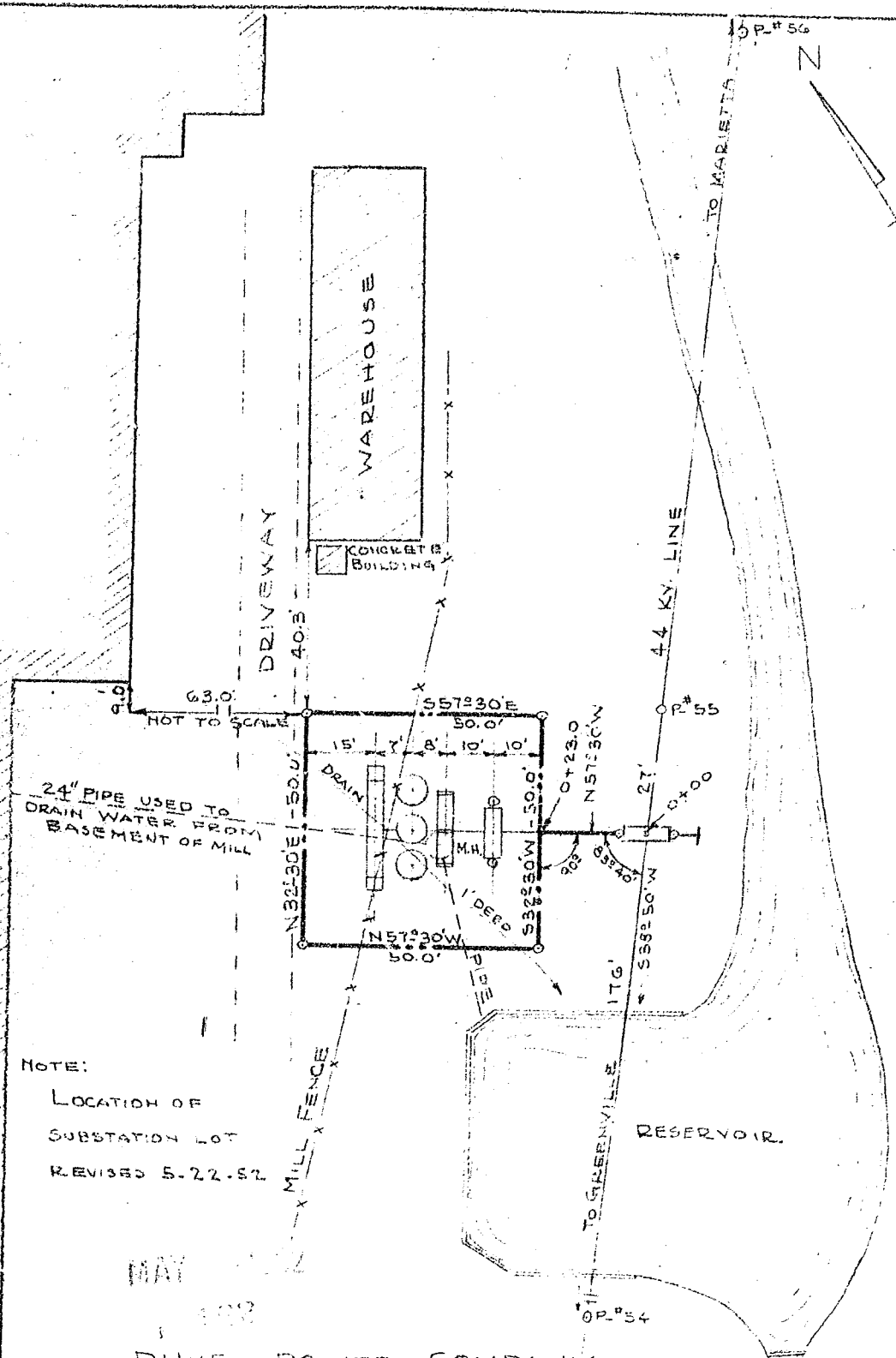

NOTE:
LOCATION OF
SUBSTATION LOT
REVISED 5-22-52

MAY 1952
DUKE POWER COMPANY
SUBSTATION LOT
AND
TAP LINE

CONE MILLS CORPORATION
"UNION BLEACHERY DIVISION"
GREENVILLE, S.C.

SCALE: 1"=30'
BOOK NO. 343

APRIL 18, 1952
FILE NO. 12-159

Checked
See 1st
MAY 28 1952

Recorded May 28th, 1952 at 10:00 A. M. #12162