

FILED THIS 14 DAY OF April 1938

AND RECORDED IN VOL. 8 PAGE 8

Ollie Jamsworth

Register Mashe Conveyance  
Greenville County S.C.

# 4783

Continued from Page No. 7  
Plat Book J.

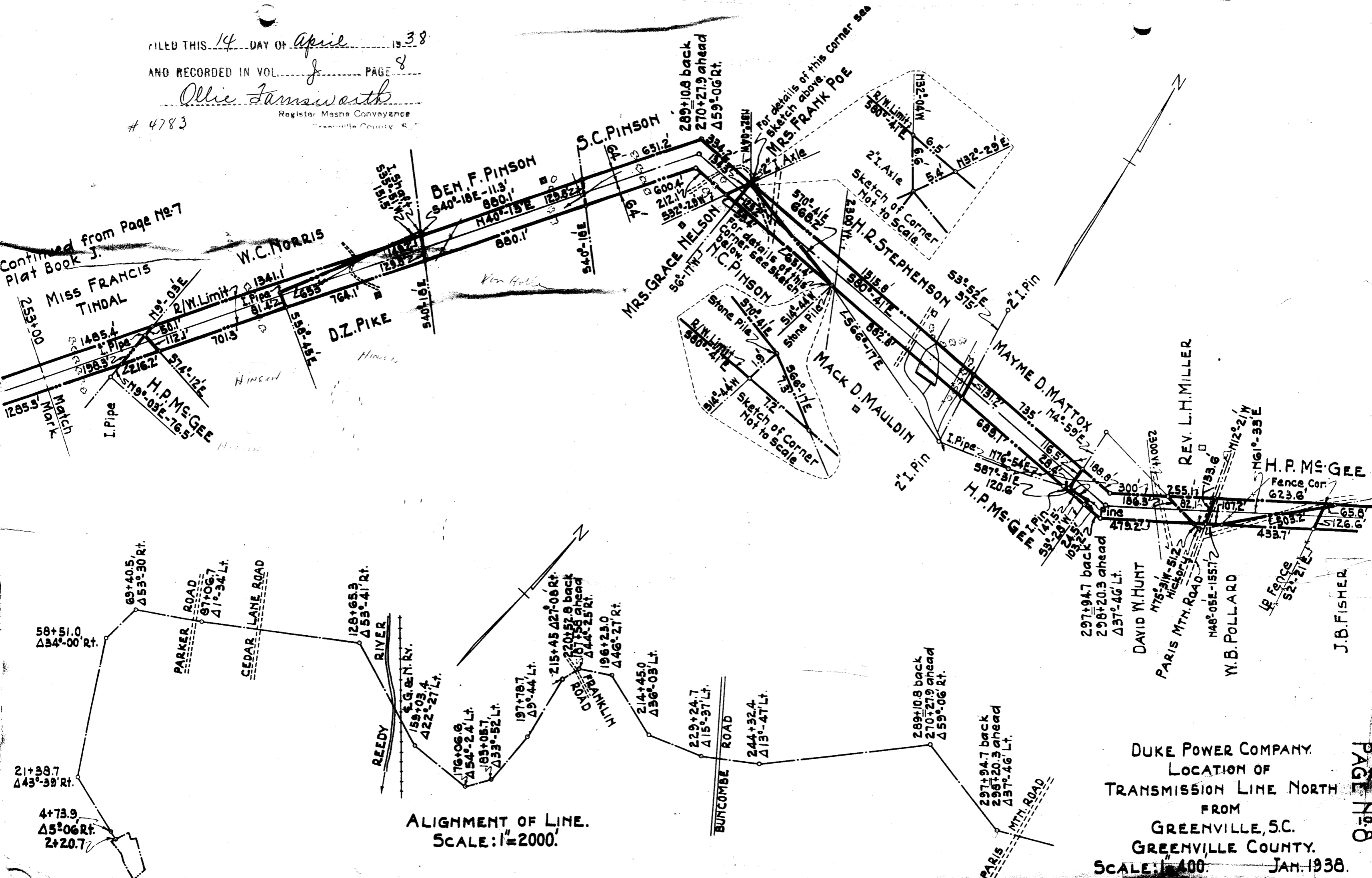

ALIGNMENT OF LINE.  
SCALE: 1"=2000'

DUKE POWER COMPANY.  
 LOCATION OF  
 TRANSMISSION LINE NORTH  
 FROM  
 GREENVILLE, S.C.  
 GREENVILLE COUNTY.  
 SCALE: 1"=400' JAN. 1938.

PAGE No. 8