

Recorded December 9, 1929, for New Firm

PROPERTY OF GREATER GREENVILLE SEWER DISTRICT COMMISSION

N. 88 - 17 E. 2245'

AREA 40.00 ACRES

S. 88 - 17 W. 2740'

PROPERTY OF MRS. C. J. PRIDE

PROPERTY OF
GREATER GREENVILLE SEWER
DISTRICT COMMISSION
GREENVILLE COUNTY S. C.

Scale: 1" = 300'

September, 1929

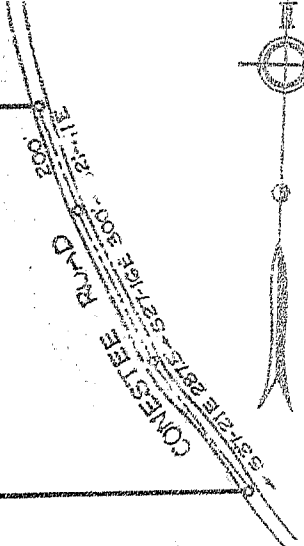
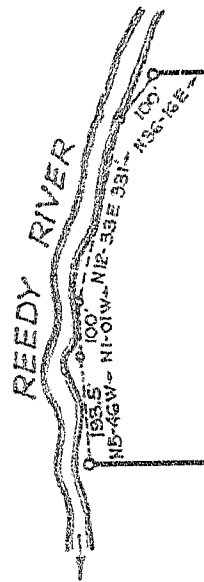

Surveyed by R.E.D.
Field Books 112 & 136
JOB NO. 1366-3

DAIDUN & NEVES ENGRS.