

South Carolina }
 Greenville County } The above plat by R. H. Hayes
 shows 238 Acre land sold by J. C. Farmer to W. A.
 Hudson Dec 2nd 1909 copy by Mrs Hudson

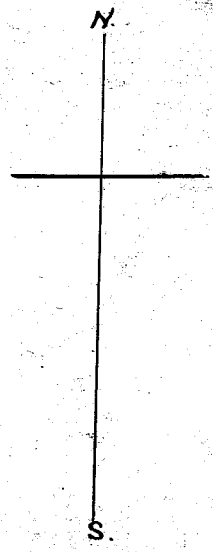
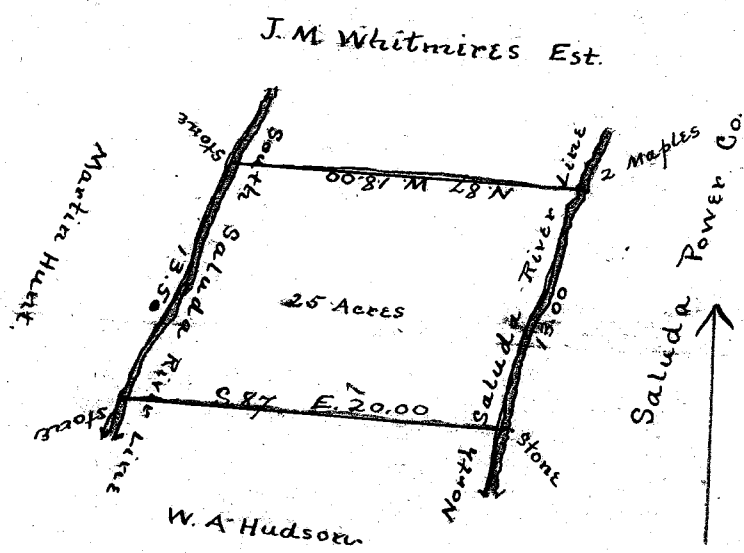
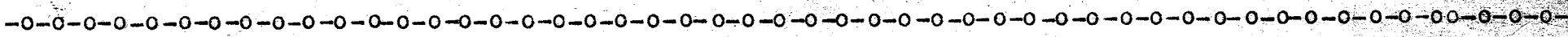

Scale 10 chs. to an inch.

See Plat Book E
 Page 31

South Carolina,
 Greenville County.
 The above plat describes twenty-five (25) acres of land sold by W.A. Hudson to John H. Williams,
 both of said County and State aforesaid, between North Saluda River and South Saluda River
 centre of each stream, and hath such marks, and bounds as above stated, said tract being part
 of the Laura Norwood Land, sold her by Hamlin Beattie and Avery Patton and by her to W.A. Hudson.
 Surveyed Oct. 8th., 1909.
 Wm. A. Hudson, D.S.

Recorded April 20th, 1910.
 and copied by J.B.