

MICROFILMED

Note: Improvements on this lot are not in a flood hazard area.

FILED
GREENVILLE, S.C.
JUL 15 11 05 AM '86
DUNNIE S. TANKERSLEY
R.M.C.

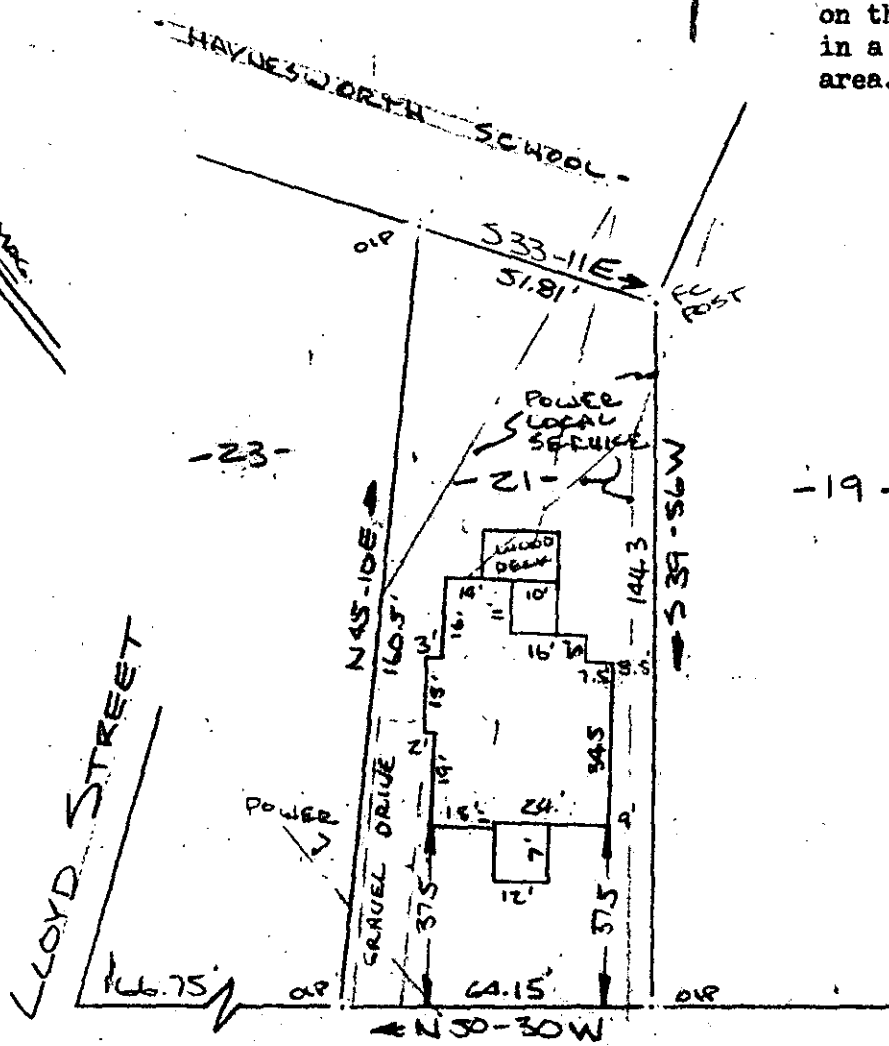

PROPERTY OF

LAWRENCE G. RUDER

CITY OF GREENVILLE, S.C.

SCALE: 1"=40' 8 JULY 1986



This is to certify that on the 8th day of July, 1986, I surveyed the property shown on this plat, being known as lot 21 on plat of PROPERTY OF JIMMY J. THARPE and recorded in Plat Book 10 - W at Page 49; and that the property lines, walls and buildings are as shown hereon, and that the walls and buildings located on said lot do not encroach or project on adjacent street or property, and that no adjacent walls or buildings encroach or project on said premises, and no power lines cross this property except as shown hereon.

R. B. Bruce

R. B. Bruce

R. B. Bruce, RLS #1952

12-X-95

2082

JUL 15 1986

CAROLINA SURVEYING CO.
112 Manly St.
Greenville, S.C. 300

Recordable Plat

1331801