

10 N 58 - 45 W 88.8 10

MICROFILMED

FILED GREENVILLE CO. S.C.

JUL 14 1 45 PM '86

BONNIE S. TANKERSLEY R.M.C.

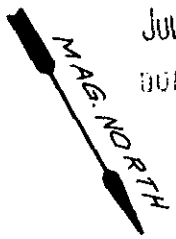

10

11

12

S 30-04 W 232.8

N 30-00 E 231.7

NOTE: 5' DRAINAGE & UTILITY EASEMENT ALONG EACH SIDE OF ALL SIDE LOT LINES & 10' ALONG EACH SIDE OF ALL REAR LOT LINES.

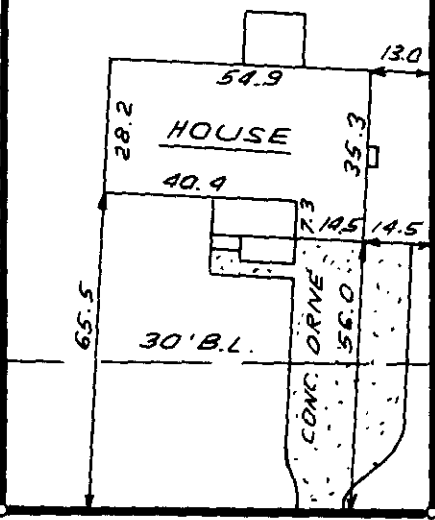

494.7' ± TO CHOCTAW COURT

S 59-28 E 89.0

JUL 14 1986

INDIAN TRAIL



12-X-89
1852

THIS IS TO CERTIFY THAT THE PROPERTY SHOWN ON THIS PLAT WAS SURVEYED UNDER MY DIRECT SUPERVISION PROPERTY LINES AND IMPROVEMENTS SHOWN ARE LOCATED CORRECTLY AND THAT NO VISIBLE ENCROACHMENTS EXIST UNLESS OTHERWISE SHOWN. THIS PROPERTY IS NOT LOCATED IN A DESIGNATED FLOOD HAZARD AREA.

SOUTH CAROLINA REGISTERED LAND SURVEYOR
 4781
 JAMES R. FREELAND

RLS JAMES R. FREELAND
 NO 4781

**STATE OF SOUTH CAROLINA
 GREENVILLE COUNTY**

FOREST ACRES
SEC. 1; LOT 11
PROPERTY OF
RALPH P. READ
REBECCA W. READ

FREELAND-CLINKSCALES & ASSOCIATES, INC.
 Engineers • Land Surveyors
 323 WEST STONE AVENUE
 GREENVILLE, S.C.
 (803) 271-4924

PLAT BOOK	8P - 35
DEED BOOK	1165 - 108
TAX MAP	T 29.4 - 1 - 56
PARTY CHIEF	D.C.H.
DRAWN	I.R.
DATE	JULY - 11 - 86
DWG. NO.	15759