

Note:

This Is Part Of Property Shown In Plat Book CCC - Page 45A.

FILED GREENVILLE CO. S.C. MAY 1 11 07 AM '86

DONNIE S. TANKERSLEY R.M.C.

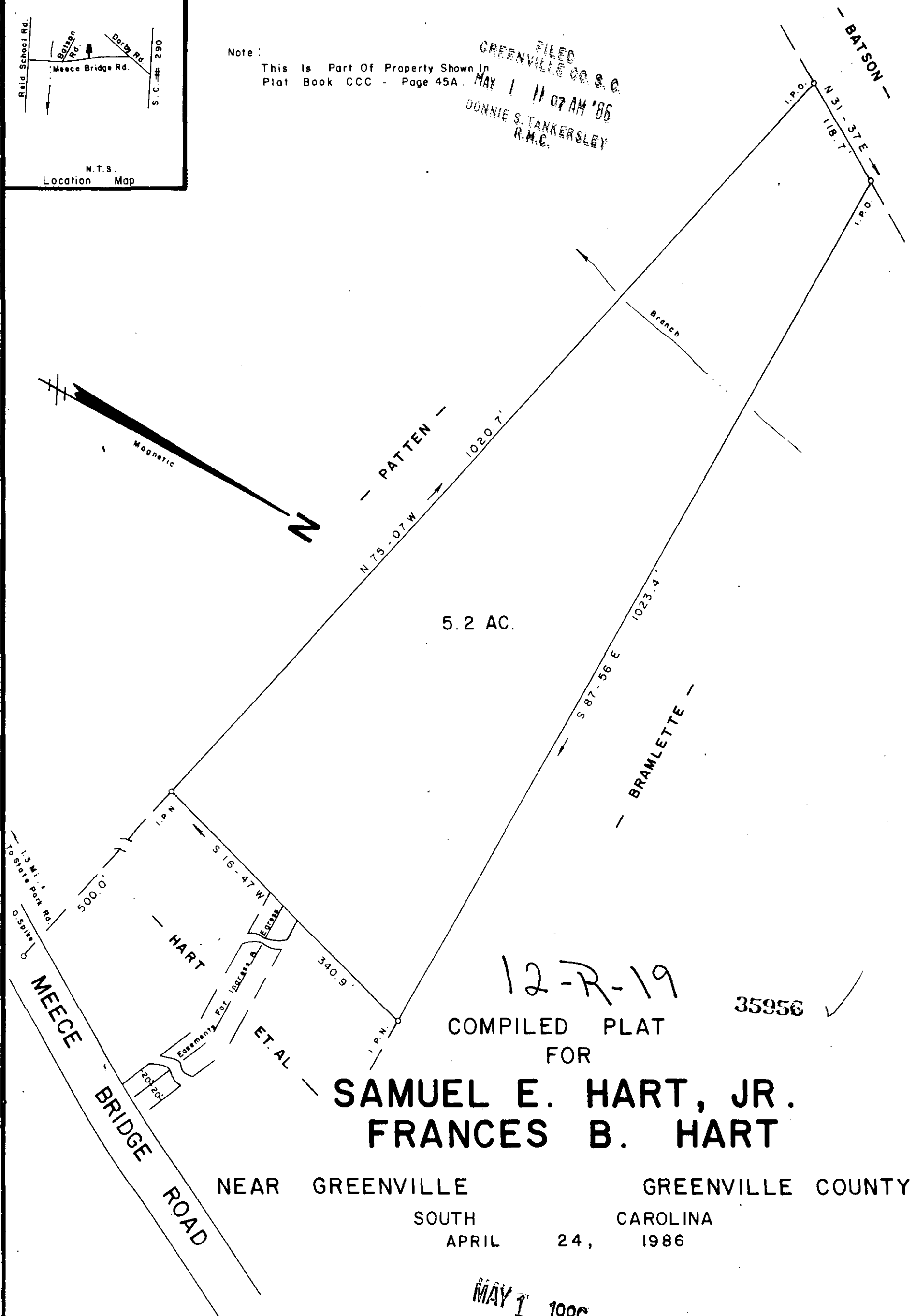
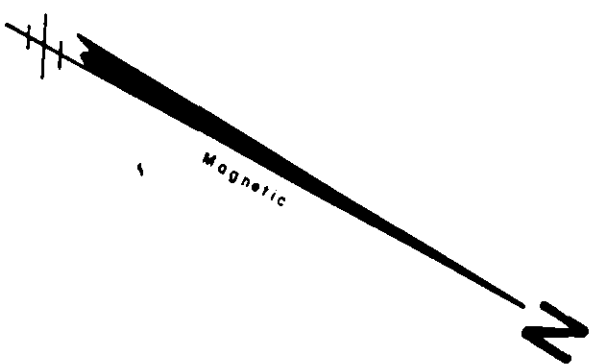

12-R-19

35956 ✓

COMPILED PLAT FOR

**SAMUEL E. HART, JR.
FRANCES B. HART**

NEAR GREENVILLE GREENVILLE COUNTY
SOUTH CAROLINA
APRIL 24, 1986

MAY 1 1986

Hereby Certify That The Ratio Of Precision Of The Field Survey Is As Shown Hereon And The Area Was Determined By Computer.

Jeffery M. Plumblee
 JEFFERY M. PLUMBLEE, INC.
 LAND SURVEYING
 P. O. BOX 788
 TRAVELERS REST, S.C. 29690
 (803) 834-4426



JEFFERY M. PLUMBLEE, INC. LAND SURVEYING

P. O. BOX 788 TRAVELERS REST, S. C. 29690 (803) 834-4426

820 2 MY01 86 820 S. 0101