

FILED  
GREENVILLE CO. S.C.  
JUL 18 4 22 PM '86  
DORRIS S. TANKERSLEY  
R.M.C.

MICROFILMED

FILED  
GREENVILLE CO. S.C.  
JUL 18 4 22 PM '86  
DORRIS S. TANKERSLEY  
R.M.C.

MICROFILMED

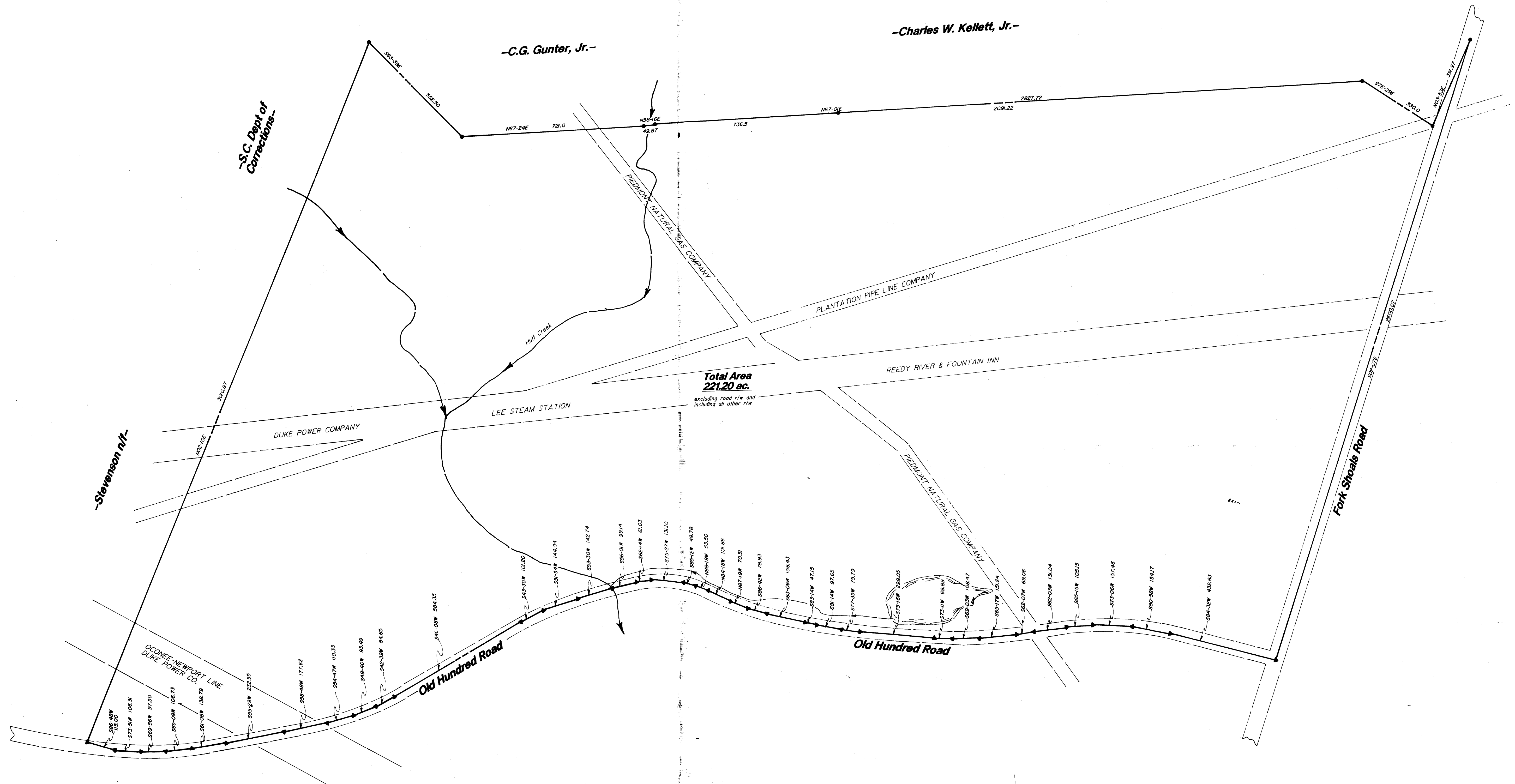

2748

JUL 18 1986

12-P-99

12-P-100 JUL 18 1986

2748

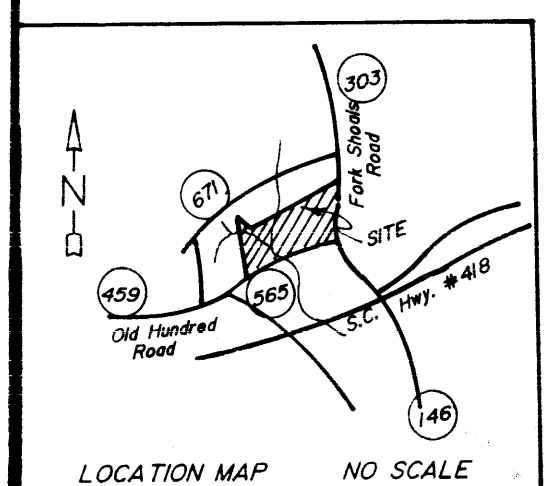

I do hereby certify that the ratio of precision of the field survey is 'locust' as shown hereon and that the area was determined by D.M.C. Method of area calculation.

*Robert R. Spearman*  
Robert R. Spearman, R.L.S. #3615  
Post Office Box 4  
Eastley, South Carolina  
Phone 18031859-2309

FINAL SURVEY FOR  
**Kellett's Well Boring, Inc.**  
greenville county south carolina  
july 10, 1986 scale 1"=200'  
200 0 200 400  
scale

6210 1-118 96 194 10-0000