

FILED
GREENVILLE CO., S.C.
MAR 10 49 AM '86
DONNIE S. TANKERSLEY
R.M.C.

Note:
Improvements on
this lot are not
in a flood hazard
area.

PROPERTY OF
VICTOR ALLAN PARIS
NEAR GREENVILLE, S.C.
SCALE: 1"=50' 13 MAR 1986

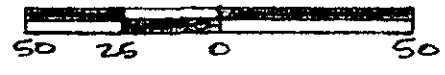

MOUNTAIN CREEK ROAD

N 42-30 E
328.00

328.33
S 42-30 W

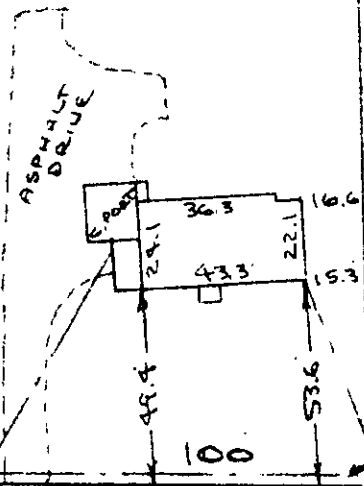

12-N-64 ✓ 31465 BELVUE ROAD (PINE STREET)
WATER IN ST R/W

This is to certify that on the 13th day of March, 1986, I surveyed the property shown on this plat, being known as lot 6 on plat of RUTH G. BUTLER LOT 6 PROPERTY OF VICTOR ALLAN PARIS and recorded in the RMC Office Greenville County, S. C., in Plat Book " 11 - L " at Page 11; and that the property lines, walls and buildings are as shown hereon, and that the walls and buildings located on said lot do not encroach or project on adjacent street or property, and that no adjacent walls or buildings encroach or project on said premises, and no power lines cross this property and no visible encroachments except as shown hereon

MAR 27 1986

R. B. Bruce
R. B. Bruce, P.L.S. # 1952

CAROLINA SURVEYING CO.
Greenville, S. C.

Recordable Plat

SC10 ----- 2 MR27 86 803 3.00CI