

MICROFILMED

RUSSELL AVENUE
WATER & SEWER IN ST R/W

Map
1928

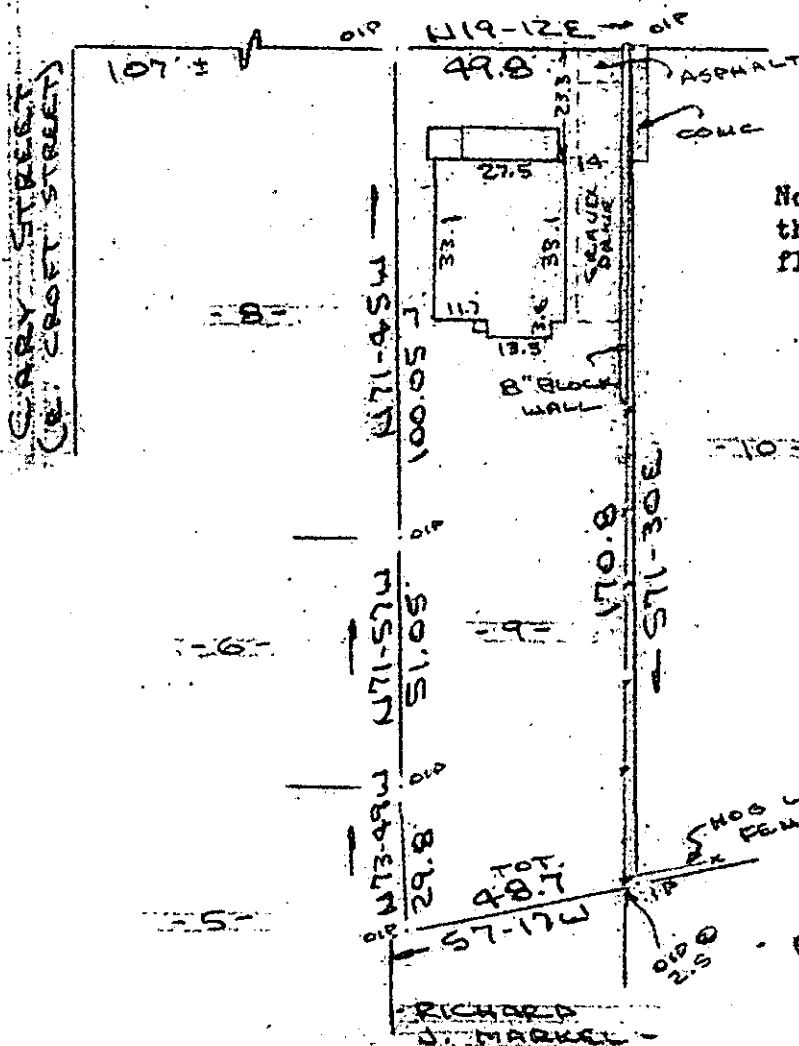

Note: Improvements on this lot are not in a flood hazard area.

FILED
GREENVILLE CO., S.C.
MAR 3 2 25 PM '86
JOHNIE S. TANKERSLEY
R.M.C.

PROPERTY OF
PERRY S. LUTHI JR. & CHARLOTTE K. LUTHI
CITY OF GREENVILLE S.C.
SCALE: 1"=40' 27 FEB 1986

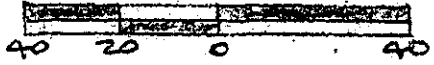

This is to certify that on the 27th day of February, 1986, I surveyed the property shown on this plat, being known as lot 9 on plat of PROPERTY OF D. R. CAIN TRUSTEE and recorded in the REC Office Greenville County, S. C., in Plat Book "H." at Page 135 and also known as PROPERTY OF PERRY S. LUTHI, JR. & CHARLOTTE K. LUTHI and recorded in the REC Office Greenville County, S. C., in Plat Book at Page and that the property lines, walls and buildings are as shown hereon, and that the walls and buildings located on said lot do not encroach or project on adjacent street or property, and that no adjacent walls or buildings encroach or project on said premises, and no power lines cross this property and no visible encroachments except as shown hereon.

28630 ✓
12-4-15
CAROLINA SURVEYING CO. Greenville, S.C.
R. B. Bruce, RLS # 1952