

FILED
GREENVILLE CO. S.C.
JAN 23 4 10 PM '86
DONNIE S. TANKERSLEY
R.M.C.

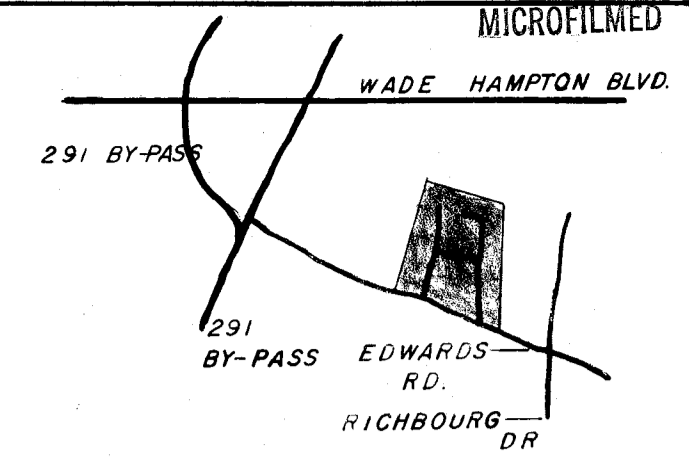
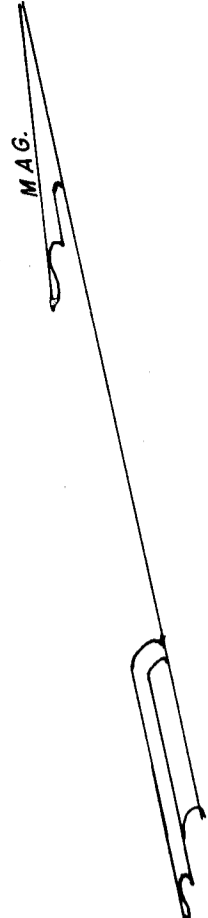

MICROFILMED

WADE HAMPTON BLVD.

291 BY-PASS

291 BY-PASS
EDWARDS RD.
RICHBOURG DR

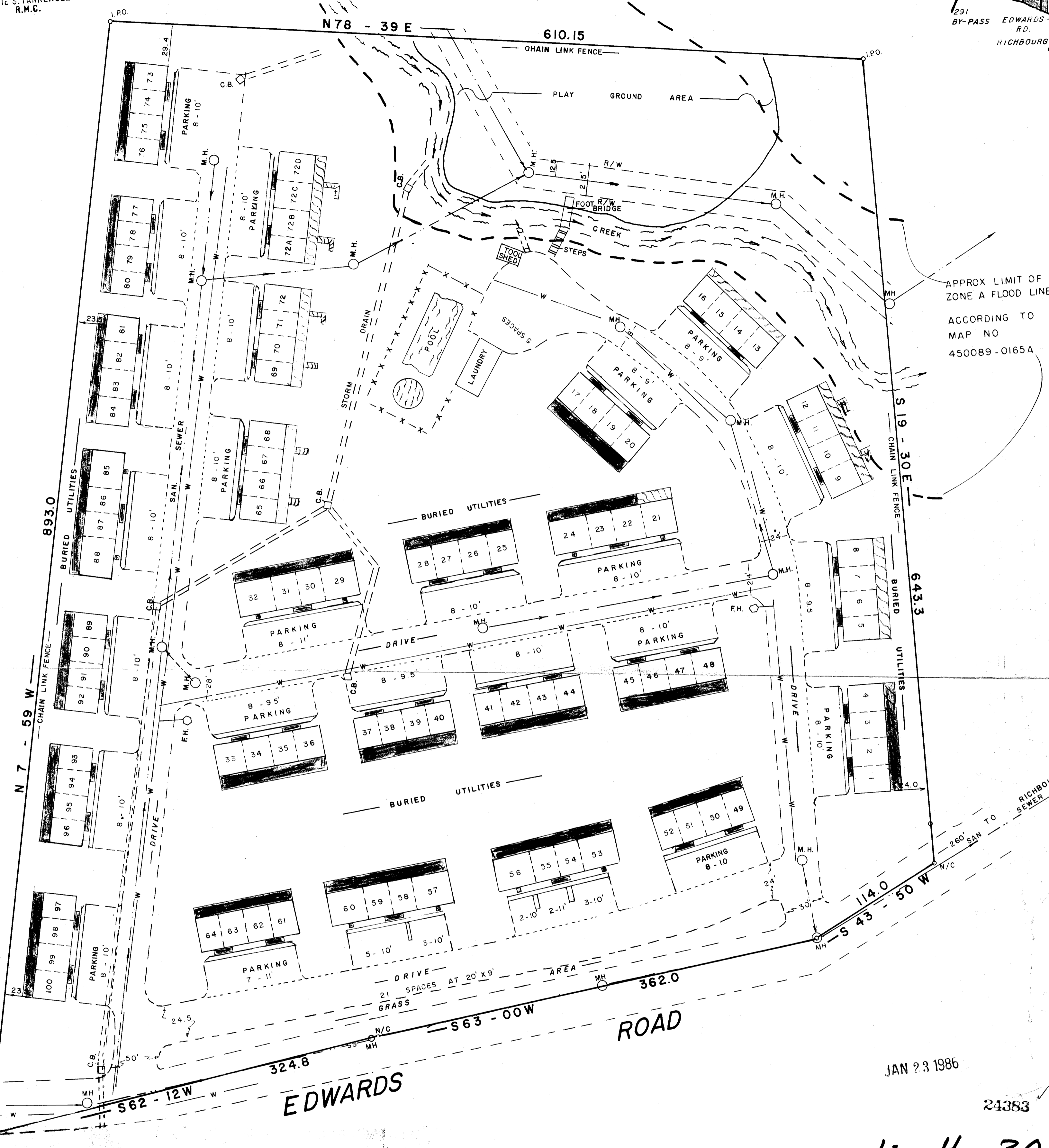

APPROX LIMIT OF
ZONE A FLOOD LINE
ACCORDING TO
MAP NO
450089-0165A

N 7 - 59 W
893.0
BURIED UTILITIES

DRIVE
8-10'

S 62 - 12 W
324.8

EDWARDS ROAD

S 63 - 00 W
362.0

JAN 23 1986

24383

12-H-30

SURVEY CERTIFICATE

The undersigned Registered Land Surveyor hereby certifies that this survey is a true, correct and accurate representation of the property shown hereon, the boundary lines and dimensions of the property. The distance to the nearest street or road is as shown on the survey and there are no visible discrepancies, conflicts, encroachments, protrusions, easements or apparent easements, rights of way or officially designated 100 year flood plains or flood prone areas except as shown. The computation of the area of the land and number of parking spaces (if any) as shown is correct, and the property has access to adjacent streets and roads, that this map was prepared in accordance with the minimum standard of practice for the State of South Carolina for land surveys, and that any boundary or parcel line shown hereon, but not surveyed, are so noted.

THIS PLAT IS NOT A SUBDIVISION AS DEFINED BY THE GREENVILLE COUNTY SUBDIVISION REGULATIONS.
1/23/1986
Charles F. Webb
Chairman, Secretary, or Director of Planning
Greenville County Planning Commission

NOTE TOTAL NO OF PARKING SPACES 232
NOTE:
= CONCRETE LIMITED COMMON ELEMENTS
= WOOD LIMITED COMMON ELEMENTS

SURVEY FOR
WILLIAMSBURG AT BOTANY WOODS
HORIZONTAL PROPERTY REGIME
GREENVILLE CO. SOUTH CAROLINA

WEBB SURVEYING & MAPPING GROUP
P.O. BOX 4756 - 29608
SCALE 1" = 50 FT.
DATE DECEMBER 23 1985

DATE 12-23-85

Registered No. 1577

THIS PLAT FOR RECORDING

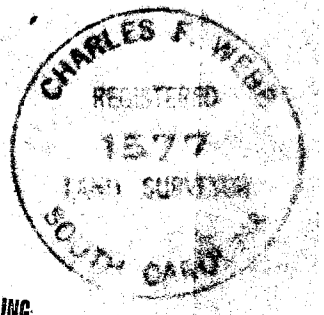

RATE OF PRECISION 1/10,000
AREA 12.29 AC.

500 21801 1-107A