

FILED
GREENVILLE CO. S.C.
JAN 2 11:12 AM '85

JOHNIE S. TADDA
R.M. #10

- TR 81 -

- TR 80 -

GORDON STREET

GRAVEL

ASPHALT

SPRINKLER

511

589-316

116.0

481-076

300.0

PET LOCAL SERVICE

35

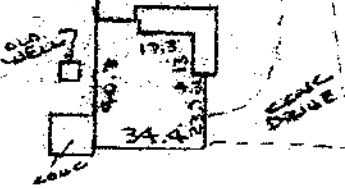

FRAME BLDG

TIN BLDG

ASPHALT DRIVE

LOT 25 -
CORDELL SUB-DIV #10 -

3.34 AC -
PT TR 83 -

SANITARY SEWER

CREEK

491.3
575-41W

EMMA OWINGS EST

MARK BRUCE CAMPBELL -
PT TR 83 -

TOT
NS-18W - 323.65
308.65

230.45
266.95 - 59-00E
TOT

CORDELL COURT



Note: Improvements on this lot are not in a flood hazard area.

PROPERTY OF
JIMMIE LOU WEST
NEAR GREENVILLE, GREENVILLE CO., S.C.
SCALE: 1"=60' 28 OCT 1985

JAN 2, 1986

22034

12-E-78

This is to certify that on the 28th day of October, 1985, I surveyed the property shown on this plat, being known as part of tract 83 (3.34 acres) on plat of PART OF EARLE SUBDIVISION PROPERTY OF LOOPER & YOUNG and recorded in the RMC Office Greenville County, S. C., in Plat Book "F" at Pages 77, 79 & 81 and also known as PROPERTY OF JIMMIE LOU WEST and recorded in Plat Book " " at Page ; and that the property lines, walls and buildings are as shown hereon, and that the walls and buildings located on said lot do not encroach or project on adjacent street or property, and that no adjacent walls or buildings encroach or project on said premises, and no power lines cross this property except as shown hereon.

CAROLINA SURVEYING Co.
112 MAINLY ST.
GREENVILLE, S.C.
240.3-1-23

R. B. BRUCE
R.B. BRUCE RLS #1952

500 Recordable Plat

MICROFILMED