

FILED
GREENVILLE CO., S.C.
Nov 21 4 29 PM '85
DONNIE S. TANKERSLEY
R.M.C.

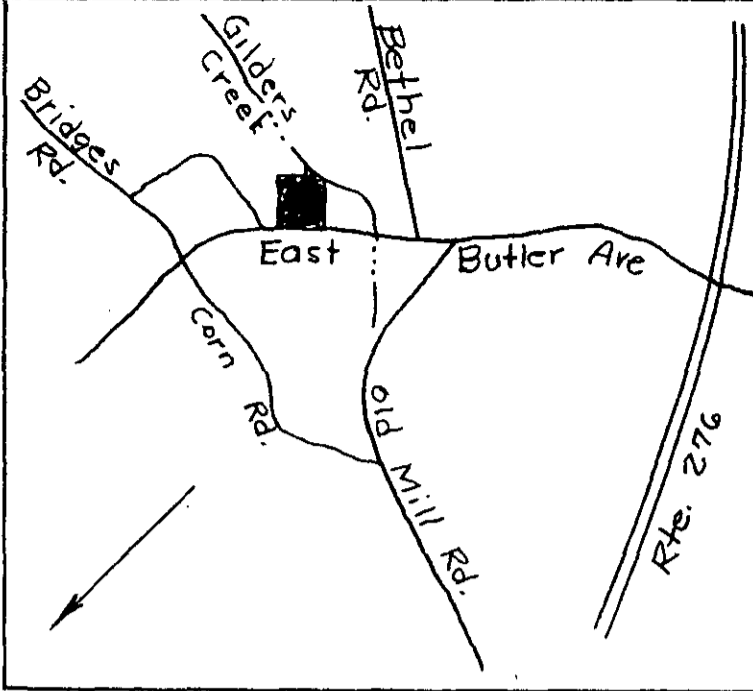

Location Map

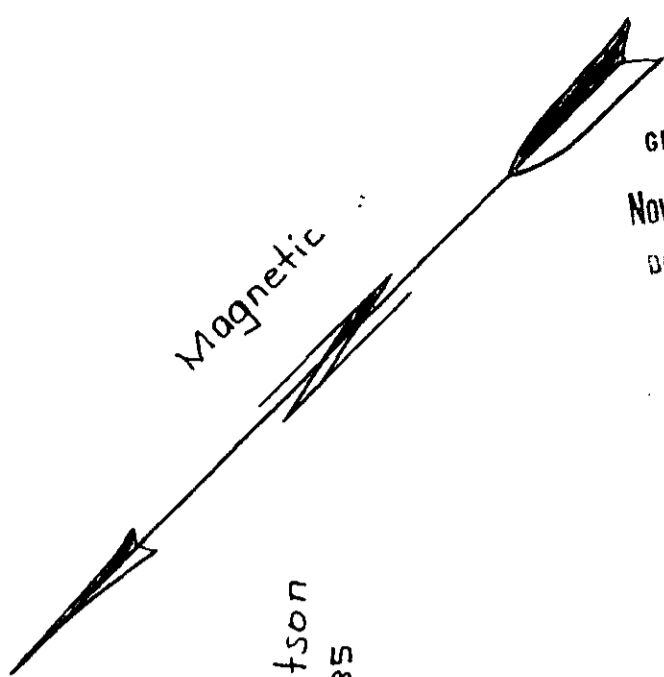

Tom P. & Deborah B. Watson
Plat by me dated 10-5-85

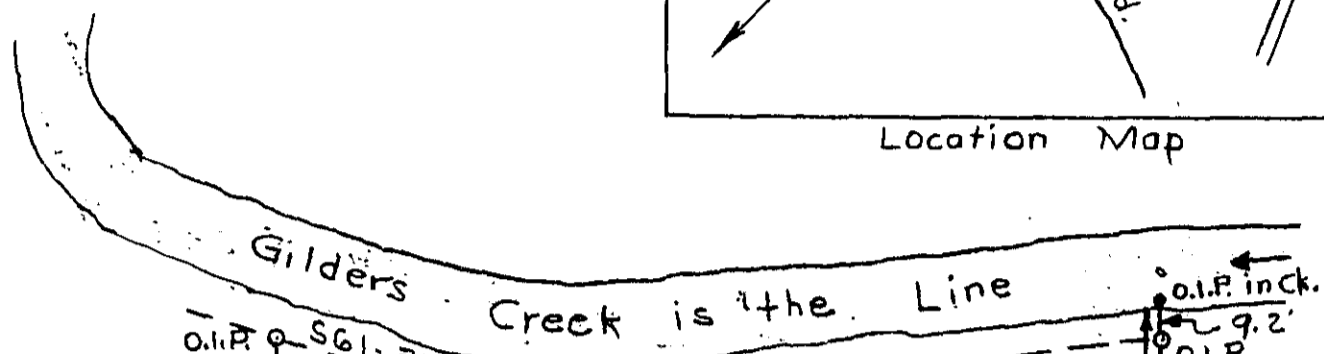

S45-22E 35.57' 0.I.P. S61-31W 63.23' 0.I.P. S38-35W 172.46' 0.I.P. inch. 9.2' 0.I.P.

0.I.P. S44-33W 125.25' 0.I.P.

1.948 Ac. ±

S45-22E 84.6'

0.I.P. 19.9' Anchor Fence

S48-57E 125.64' 6.8

Holly Springs Sec. 1

44.84' Brook Bend Road

125'

0.I.P. N44-33E 349.4' 0.I.P. 0.I.P. 0.I.P.

East Butler Ave.

S. Hunter Howard
1243 - 601

PROPERTY OF
OLD NINETY SIX GIRL SCOUT COUNCIL INC.
GREENVILLE CO. MAULDIN, S. C.

Scale 1"=50' Nov. 19, 1985
T.H. Walker Jr. Reg. L.S. 3182
300 Maple Dr. Mauldin, S.C.



Error of closure exceeds 1/5000

12-E-7



NOV 21 1985