

MAG  
1981

CHEROKEE DRIVE  
WATER & SEWER IN ST R/W

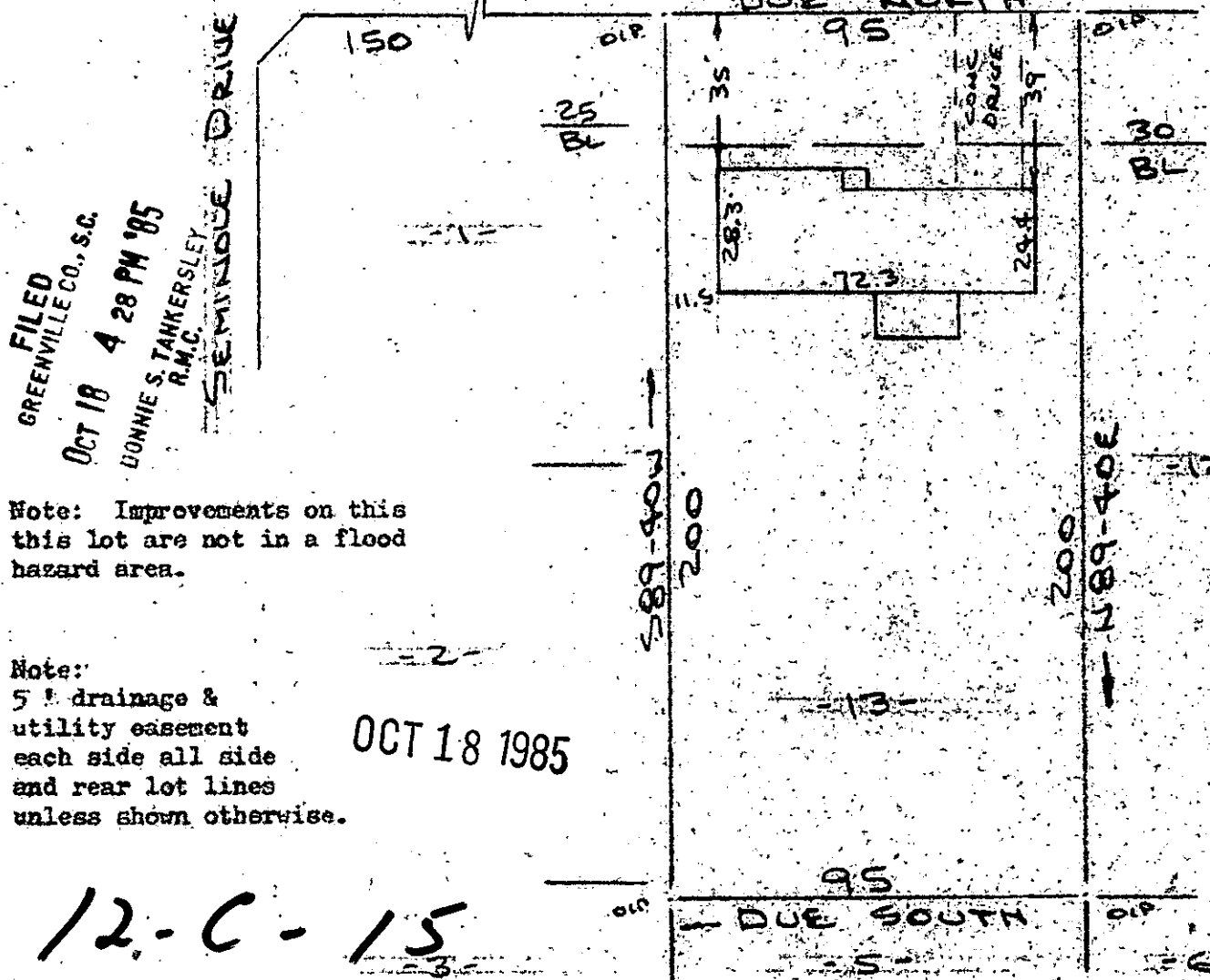

FILED  
GREENVILLE CO., S.C.  
OCT 18 4 28 PM '85  
DONNIE S. TAMKERSLEY  
R.M.C.  
SEMINOLE DRIVE

Note: Improvements on this  
this lot are not in a flood  
hazard area.

Note:  
5' drainage &  
utility easement  
each side all side  
and rear lot lines  
unless shown otherwise.

OCT 18 1985

12-C-15

PROPERTY OF  
A. WAYNE GREEN & ANEHA W. GREEN  
SIMPSONVILLE S.C.  
SCALE: 1" = 40' 16 OCT 1985



This is to certify that on the 16th day of October, 1985, I surveyed the property shown on this plat, being known as lot 13 on plat of ADDITION TO WEST GEORGIA HEIGHTS and recorded in the RMC Office Greenville County, S. C., in Plat Book "8 - P" at Page 32; and that the property lines, walls and buildings are as shown hereon; and that the walls and buildings located on said lot do not encroach or project on adjacent street or property, and that no adjacent walls or buildings encroach or project on said premises, and no power lines cross this property except as shown hereon.

13640

*R. B. Bruce*  
R. B. Bruce, RLS # 1952