

LINE	BEARING	DISTANCE	CURVE	RADIUS	ARC	CHORD	CHORD BRG
1	N 51°31'17"E	10.00	1	231.76	71.20	70.92	N 58°31'54"W
2	N 41°14'30"W	23.71	2	231.76	131.70	129.94	N 83°38'42"W
3	N 41°14'30"W	13.70	3	385.86	103.85	103.55	N 72°35'42"E
4	N 41°14'30"W	37.40	4	385.86	93.71	93.48	N 58°19'05"E
5	N 55°38'27"E	37.40	5	438.88	111.30	111.00	N 68°03'37"E
6	N 82°37'16"W	74.00	6	438.88	29.19	29.18	N 78°12'28"E
7	N 83°04'14"W	71.74	7	275.78	84.76	84.29	N 80°57'09"E
8	N 73°05'34"E	88.18	8	275.78	87.84	87.87	N 73°09'20"W
9	N 85°16'08"E	171.84	9	275.78	78.82	78.55	N 57°55'07"W
10	N 38°07'58"W	135.00	10	228.00	81.49	81.30	N 46°14'01"E
11	N 38°07'58"W	91.00	11	228.00	208.02	199.08	N 12°37'16"E
12	N 38°07'58"W	134.00	12	272.00	88.47	88.29	N 09°30'50"W
13	N 30°47'18"E	148.02	13	50.00	119.67	93.08	N 80°40'28"W
14	N 59°51'56"W	143.07	14	50.00	54.23	51.61	N 18°57'44"E
15	N 46°48'42"E	118.00	15	50.00	89.11	83.68	N 73°10'55"W
16	N 46°48'42"E	51.91	16	272.00	101.43	100.84	N 27°20'56"E
17	N 22°10'09"E	109.58	17	272.00	75.62	75.37	N 45°59'44"E
18	N 38°28'43"W	81.54	18	230.00	12.33	12.33	N 38°44'00"E
19	N 13°41'32"W	88.00	19	230.00	125.88	124.31	N 21°31'08"E
20	N 42°45'28"E	90.18	20	230.00	37.30	37.26	N 01°11'36"E
21	N 34°59'53"E	73.49	21	50.00	89.51	84.04	N 35°38'45"W
22	N 00°55'08"E	35.13	22	50.00	52.27	49.82	N 34°07'48"E
23	N 88°08'41"W	30.99	23	50.00	48.58	44.81	N 89°14'09"W
24	N 18°10'47"E	40.89	24	50.00	49.39	47.41	N 34°14'56"W
25	N 88°55'08"W	37.41	25	50.00	55.07	52.33	N 25°36'22"E
26	N 89°39'12"W	30.27	26	270.00	53.75	53.66	N 01°24'14"E
27	N 72°42'54"W	70.00	27	270.00	71.80	71.59	N 14°43'32"E
28	N 69°45'05"W	88.48	28	270.00	82.67	82.53	N 28°59'38"E
29	N 83°05'59"E	43.87	29	270.00	21.80	21.79	N 37°57'23"E
30	N 43°22'01"E	88.31	30	270.00	85.11	84.78	N 32°45'45"W
31	N 44°57'44"E	55.11	31	270.00	56.72	56.62	N 17°42'50"W
32	N 01°45'25"W	33.47	32	50.00	14.86	14.81	N 84°38'14"W
33	N 89°20'01"E	37.77	33	50.00	78.87	69.38	N 12°11'28"W
34	N 49°43'51"W	39.67	34	50.00	51.80	49.34	N 61°18'11"E
35	N 85°18'08"E	35.36	35	50.00	41.79	40.58	N 65°11'21"W
36	N 40°18'08"E	71.94	36	50.00	87.90	77.01	N 09°08'53"E
37	N 40°18'08"E	71.94	37	230.00	13.37	13.38	N 14°12'26"W
38	N 04°43'51"W	35.36	38	230.00	105.88	104.83	N 29°03'28"W
39	N 48°39'07"E	41.55	39	50.00	18.44	18.37	N 55°42'14"E
40	N 72°05'32"E	22.82	40	50.00	38.32	37.38	N 87°04'39"E
41	N 83°04'17"W	29.03	41	50.00	51.48	49.24	N 41°28'18"W
42	N 82°37'14"W	26.93	42	50.00	53.12	50.85	N 18°27'36"E
43	N 49°43'51"W	35.29	43	50.00	82.28	73.30	N 83°57'54"W
44	N 59°51'56"W	33.00					
45	N 30°47'18"E	34.85					
46	N 53°57'38"E	35.37					
47	N 53°57'38"E	25.35					
48	N 53°57'41"E	28.00					
49	N 86°18'08"E	38.00					
50	N 38°07'55"W	17.00					

NOTES:

- IRON PINS AT ALL CORNERS, UNLESS NOTED OTHERWISE.
- DRAINAGE AND UTILITY EASEMENTS 5' EITHER SIDE OF ALL SIDE LOT LINES AND 10' EITHER SIDE OF ALL REAR LOT LINES.
- ALL SANITARY SEWER EASEMENTS ARE 25' WIDE.
- NO BUILDINGS SHALL BE LOCATED NEARER THAN 10% OF THE AVERAGE WIDTH OF THE LOT TO ANY INSIDE LOT LINE, EXCEPT DETACHED GARAGES AND OTHER OUTBUILDINGS WHICH SHALL NOT BE LOCATED NEARER THAN 75' TO THE FRONT LOT LINE NOR NEARER THAN 5' TO ANY SIDE OR REAR LOT LINES.
- OWNER IS RESPONSIBLE FOR POSTING 25 MPH SPEED LIMIT SIGNS ON BERNWOOD DR. & STATEN LN.
- NO ACCESS SHALL BE PROVIDED TO LOTS 51 AND 52 FROM REID SCHOOL ROAD.
- REVISED 30' BUFFER, ADDED STREET NAME 'STATEN COURT' NOV. 26 1985.
- STREET SIGNS DO NOT CONFORM TO GREENVILLE COUNTY STANDARDS AND SHALL BE THE RESPONSIBILITY OF THE OWNERS TO MAINTAIN UNTIL SUCH TIME AS THEY MEET COUNTY STANDARDS.

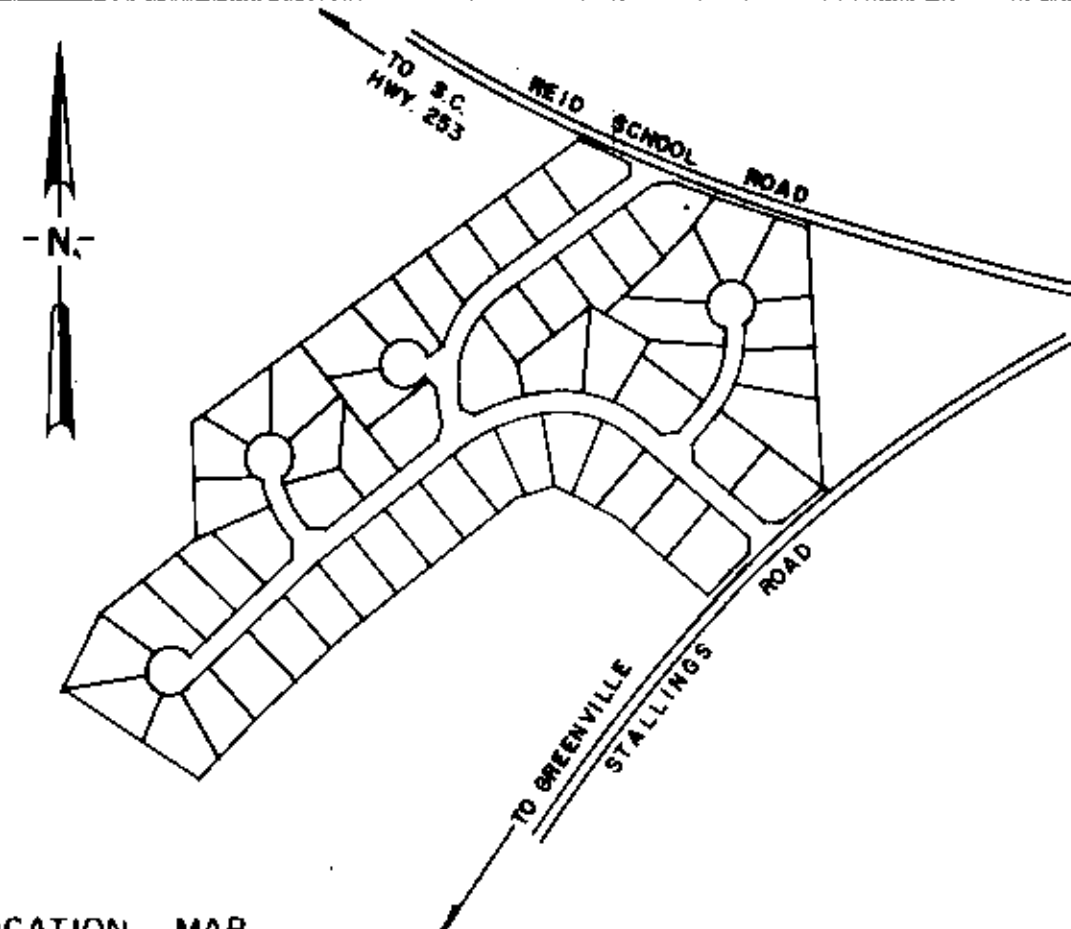

LOCATION MAP

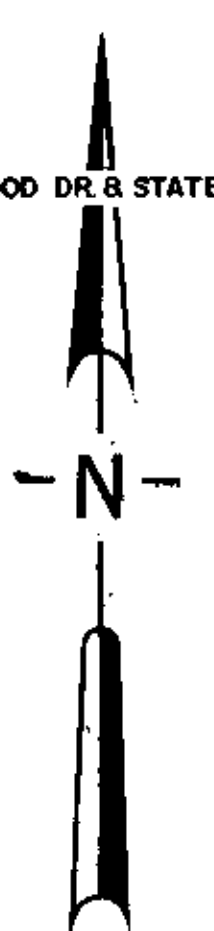

FINAL PLAT
CERTIFICATE OF OWNERSHIP AND DEDICATION

"The undersigned hereby acknowledge that I am (we are) the owner(s) of the property shown and described herein and that I (we) hereby adopt this plan of subdivision with my (our) free consent and that I (we) establish the maximum building restriction lines, and hereby dedicate to public use as shown streets and easements herein as shown on this plat.

Signed: *Michael B. Barber*
SIGNED
SIGNED
SIGNED

CERTIFICATE OF ACCURACY

I, William N. Shardon, certify that this plat was drawn by me (or under my supervision) from an actual survey made under my supervision from (an actual survey made by me) (good description recorded in Book _____ Page _____) that the boundaries and surveyed are shown as broken lines plotted from information found in Book _____ Page _____ that this plat was prepared in accordance with the Greenville County Subdivision Regulations as adopted.

DATE: 11 SEPT 86 SIGNED: *William N. Shardon*
GREENVILLE COUNTY PLANNING COMMISSION

S. C. Registration No. 7261

CERTIFICATE OF APPROVAL FOR RECORDING

"I hereby certify that the subdivision plat shown herein has been found to comply with the Subdivision Regulations for Greenville County, with the exception of such variances, if any, as are noted in the minutes of the Greenville County Planning Commission of Greenville County, South Carolina, and that it has been approved for recording in the office of the County Register of Mense Conveyance."

DATE: Sept 12, 1986 SIGNED: *John Clayton King*
LIMITED TO PLANNING
GREENVILLE COUNTY PLANNING COMMISSION

FILE NUMBER
81-147
PEBBLE VALLEY

BALENTINE BROS. BUILDERS OWNER ARBOR ENGINEERING, INC. SURVEYOR

NO. OF ACRES	22.689	MILES NEW ROAD	0.57
NO. OF LOTS	57	DATE	26 AUG. 1985
<p>100 0 100 200 scale feet</p> <p>GREENVILLE SOUTH CAROLINA</p> <p>HP TAG DATE 26 AUG. 1985 SCALE FILE DATE 85133</p>			

REVISED
Sept 12, 1986
DATE

12-B-96

LEGEND

- ROAD R/W RIGHT-OF-WAY LINE
- 20' B/L BUILDING SETBACK LINE
- S.D. ESMT. STORM DRAIN & UTILITY EASEMENT (WIDTH AS SHOWN)
- 25' SS ESMT. 25' SANITARY SEWER EASEMENT
- 15' ESMT. 15' SIGNAGE & LANDSCAPING EASEMENT

ARROW INDICATES DIRECTION WHICH HOUSE IS TO FACE ON LOTS.

Plat Filed This 12 day of Sept 1986
And Recorded in the Office of the County Register of Mense Conveyance Greenville County, S.C.

REVISED 27 AUG. 1986:
REV. NOTE # 5
ADDED NOTE # 8
ADDED DRAINAGE EASEMENTS TO LOTS 48 & 56.

Arbor Engineering, Inc.
P.O. BOX 263, GREENVILLE, S.C.
LANDSCAPE ARCHITECTS ENGINEERS RECREATIONAL PLANNERS

RECORDING FEE PAID \$300

FILED
GREENVILLE CO. S.C.
SEP 17 3 57 PM '86
JUNNIE S. STANKERSLEY
R.M.C.

81-147