

FILED
GREENVILLE CO S.C.
SEP 8 9 30 PM '86
DONNIE S. TANKERSLEY
R.M.C.

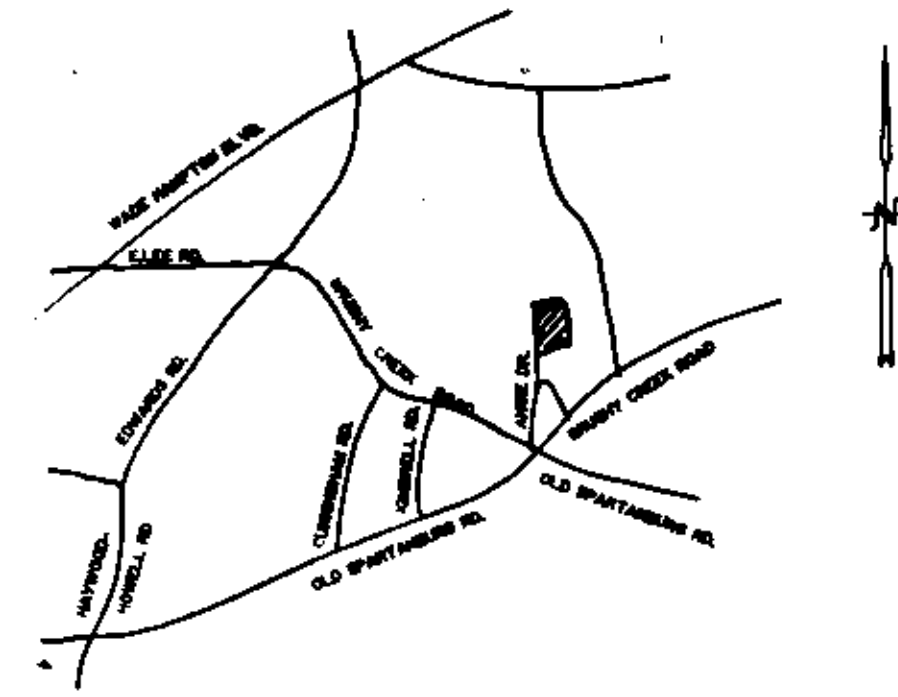
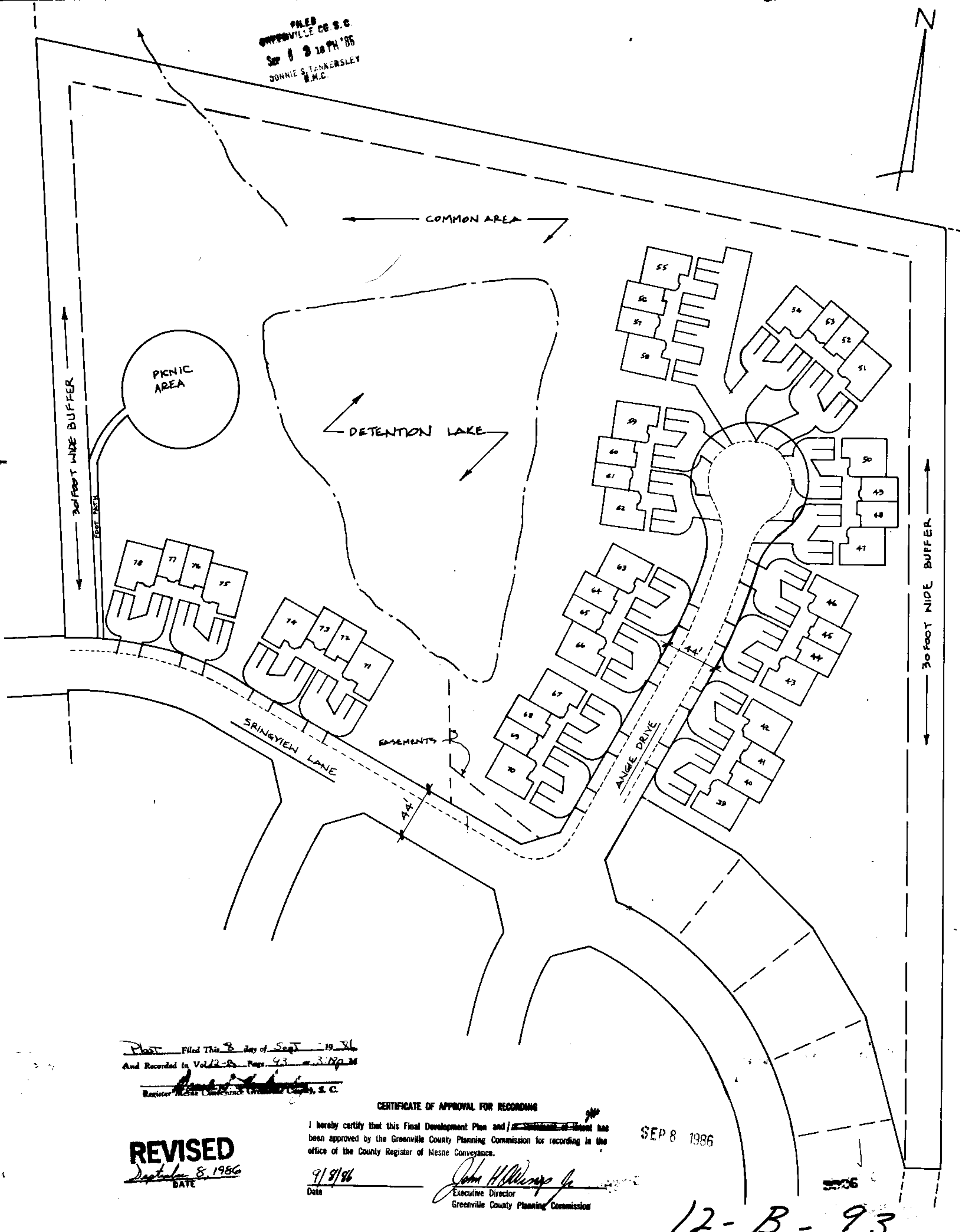

LOCATION MAP (N.T.S.)

GENERAL NOTES:

- (1) **CONSTRUCTION**
PROJECT CONSISTS OF 40 ATTACHED UNITS IN GROUPS OF 4. ALL UNITS HAVE 2 (TWO) BEDROOMS. SEE ATTACHED FLOOR PLANS.
- (2) **LANDSCAPING**
A 30 FOOT NATURAL BUFFER SHALL BE PROVIDED AROUND THE PERIMETER AS SHOWN. INDIVIDUAL UNITS SHALL BE TYPICAL SUBDIVISION LANDSCAPING. FLOWER BEDS WILL BE PLANTED @ ENTRANCES TO THE SUBDIVISION. COMMON AREAS SHALL BE LEFT IN THEIR NATURAL STATE.
- (3) **PARKING**
EACH UNIT SHALL HAVE 2 (TWO) OFF STREET PARKING SPACES.
- (4) **DRAINAGE**
THE DETENTION LAKE HAS BEEN ENGINEERED TO ACCEPT ALL RUNOFF FROM RUSSTON PHASES I & II, ANGIE DRIVE & WOODHARBOR.

FILE NUMBER

86-111

REVISED FINAL DEVELOPMENT PLAN
SECTION TWO PHASE TWO
RUSSTON PLACE

SMITH AND STEELE BUILDERS, INC. OWNER
RICHARD D. WOOTEN, JR. SURVEYOR

NO. OF ACRES: 9.487 MILES OF NEW ROADS: 0
NO. OF UNITS: 40 DATE: 9/27/86

ZONE: P.U.D.
SCALE 1" = 50'
100 50 0 50 100

Plat Filed This 8 day of Sept 1986
And Recorded in Vol 12-8 Page 43
Register of Deeds Greenville County, S.C.

CERTIFICATE OF APPROVAL FOR RECORDING

I hereby certify that this Final Development Plan and / or ~~Statement of Intent~~ has been approved by the Greenville County Planning Commission for recording in the office of the County Register of Mesne Conveyance.

REVISED
September 8, 1986
DATE

9/8/86
Date

John H. Williams, Jr.
Executive Director
Greenville County Planning Commission

SEP 8 1986

12-B-93