

Note: Improvements on this lot are not in a flood hazard area.

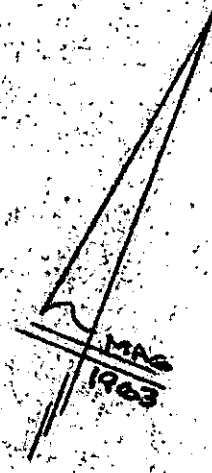

0.77 AC.

PROPERTY OF  
RICKEY D. BOOZER  
&  
JULIE S. BOOZER

NEAR GREENVILLE, GREENVILLE CO., S.C.  
SCALE: 1" = 50' 20 AUG 1985



FILED  
GREENVILLE CO., S.C.  
AUG 27 10 17 AM '85  
DONNIE S. TANKERSLEY  
R.M.C.

BROOK GREEN ROAD

W.E. SHAW

JAMES DOWELL

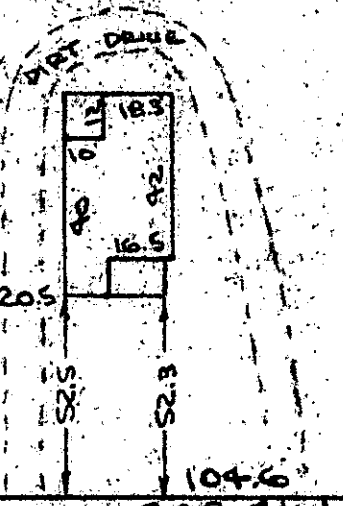

EAST LEE ROAD  
WATER & SEWER IN RD R/W

This is to certify that on the 20th day of August, 1985, I surveyed the property shown on this plat, being known as 0.77 acre on plat of PROPERTY OF RICKEY D. BOOZER & JULIE S. BOOZER and recorded in Plat Book \_\_\_\_\_ at Page \_\_\_\_\_; and that the property, lines, walls and buildings are as shown hereon, and that the walls and buildings are as shown hereon, and that the walls and buildings located on said lot do not encroach or project on adjacent street or property, and that no adjacent walls or buildings encroach or project on said premises, and no power lines cross this property except as shown hereon.

11-W-17

6811

CAROLINA SURVEYING  
112 Hanly St.  
Greenville, S.C.

CO. R. B. Bruce, RLS # 1952