

FILED
GREENVILLE CO., S.C.
Aug 26 10 56 AM '85
DONNIE S. TANKERSLEY
R.M.C.

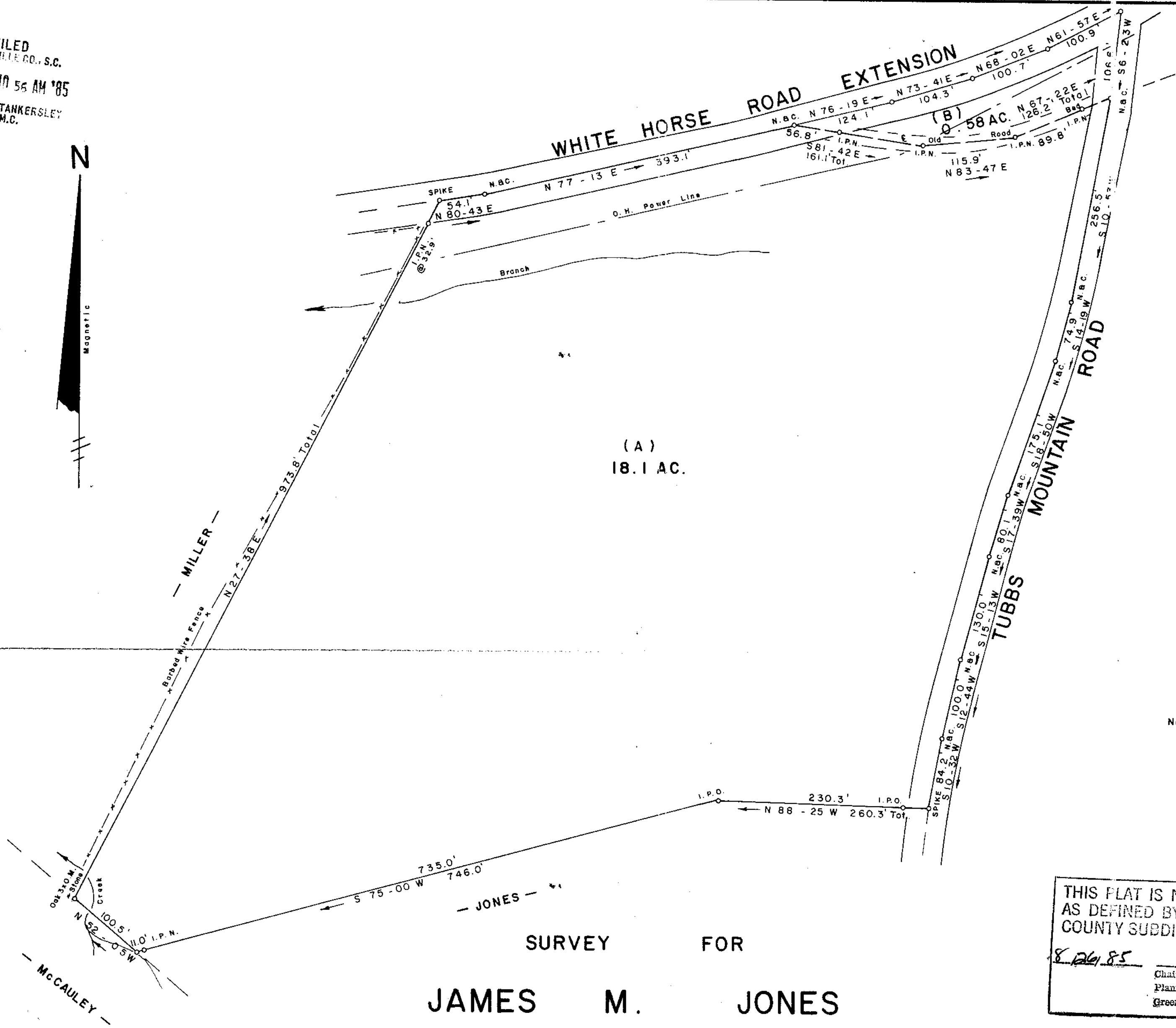

Note:
Tracts A & B To Be Combined.

SURVEY FOR
JAMES M. JONES
NEAR TRAVELERS REST GREENVILLE COUNTY
SOUTH CAROLINA
AUGUST 23, 1984
REVISED JULY 23, 1985

THIS PLAT IS NOT A SUBDIVISION
AS DEFINED BY THE GREENVILLE
COUNTY SUBDIVISION REGULATIONS.
8/26/85 *F. J. Jones*
Chairman, Secretary, or Director of
Planning,
Greenville County Planning Commission

11-P-90 1985

6640

I Hereby Certify That The Ratio Of Precision
Of The Field Survey Is 1:2,000 As Shown
Hereon And The Area Was Determined By Computer.

Jeffery M. Plumblee
P.L.S. # 7861

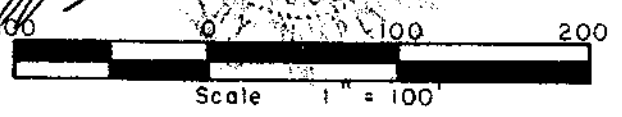

JEFFERY M. PLUMBLEE, INC.
LAND SURVEYING
P O BOX 788
TRAVELERS REST, S. C. 29690
(803) 834-4426

5010 1 AUG 19 85 1205 5.0001

MICROFILMED