

FILED
GREENVILLE CO. S.C.

MAR 29 4 10 PM '85

DONNIE S. JAMES
R.M.C.

ADAMS STREET

- 62 -
MYRTLE AVENUE
LIFE EST -

MAR 1985

ALEXANDER STREET
WATER & SEWER IN ST RW
N75-25E-594.1 TOT
560.0

TAYLOR'S ROAD
CRAWFORD CREEK ROAD
N15-48W-134.5 TOT
145.0
TEL

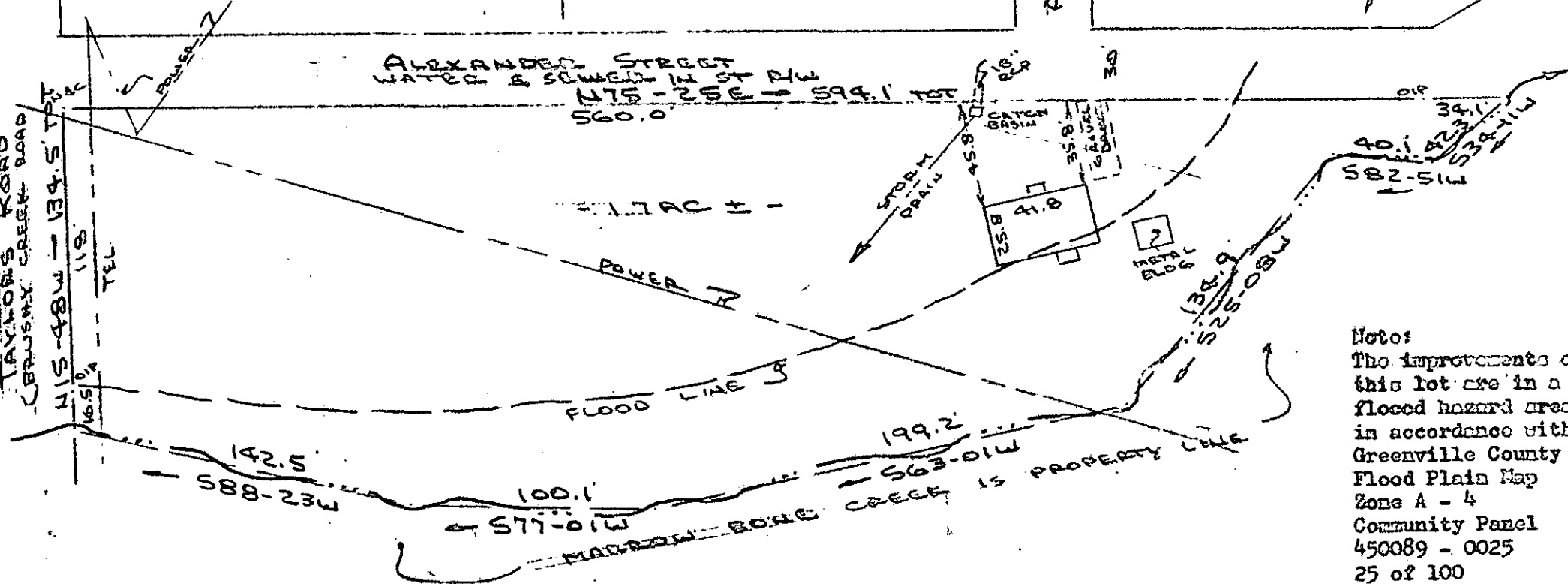

Notes:
The improvements on
this lot are in a
flooded hazard area
in accordance with
Greenville County
Flood Plain Map
Zone A - 4
Community Panel
450089 - 0025
25 of 100
Floodway.

PROPERTY OF
BILLY JOE WHITE & MARGIE B. WHITE

NEAR GREENVILLE, GREENVILLE CO., S.C.

SCALE: 1"=60' 28 MAR 1985

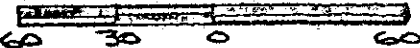

MAR 29 1985

11-K-24-1

28912

This is to certify that on the 28th day of March, 1985, I surveyed the property shown on this plat, being known as 1.87 acres on plat of PROPERTY OF RICKY D. FRUITT & SHIRLEY A. REYNOLDS and recorded in the REC Office Greenville County, S. C., in Plat Book " 8 - L " at Page 79; and that the property lines, walls and buildings are as shown hereon, and that the walls and buildings located on said lot do not encroach or project on adjacent street or property, and that no adjacent walls or buildings encroach or project on said premises, and no power lines cross this property except as shown hereon.

R. B. Bruce
Recordable Plat

CAROLINA SURVEYING CO., 112 Early St., Greenville, S. C.

GC10 - 1 MR29 85 071

3.0000

T6-13-8

MICROFILMED