

Note: Drainage & utilities easement 5' each side of side and rear lot lines.

OAK PARK DRIVE
WATER & SEWER IN STR/W

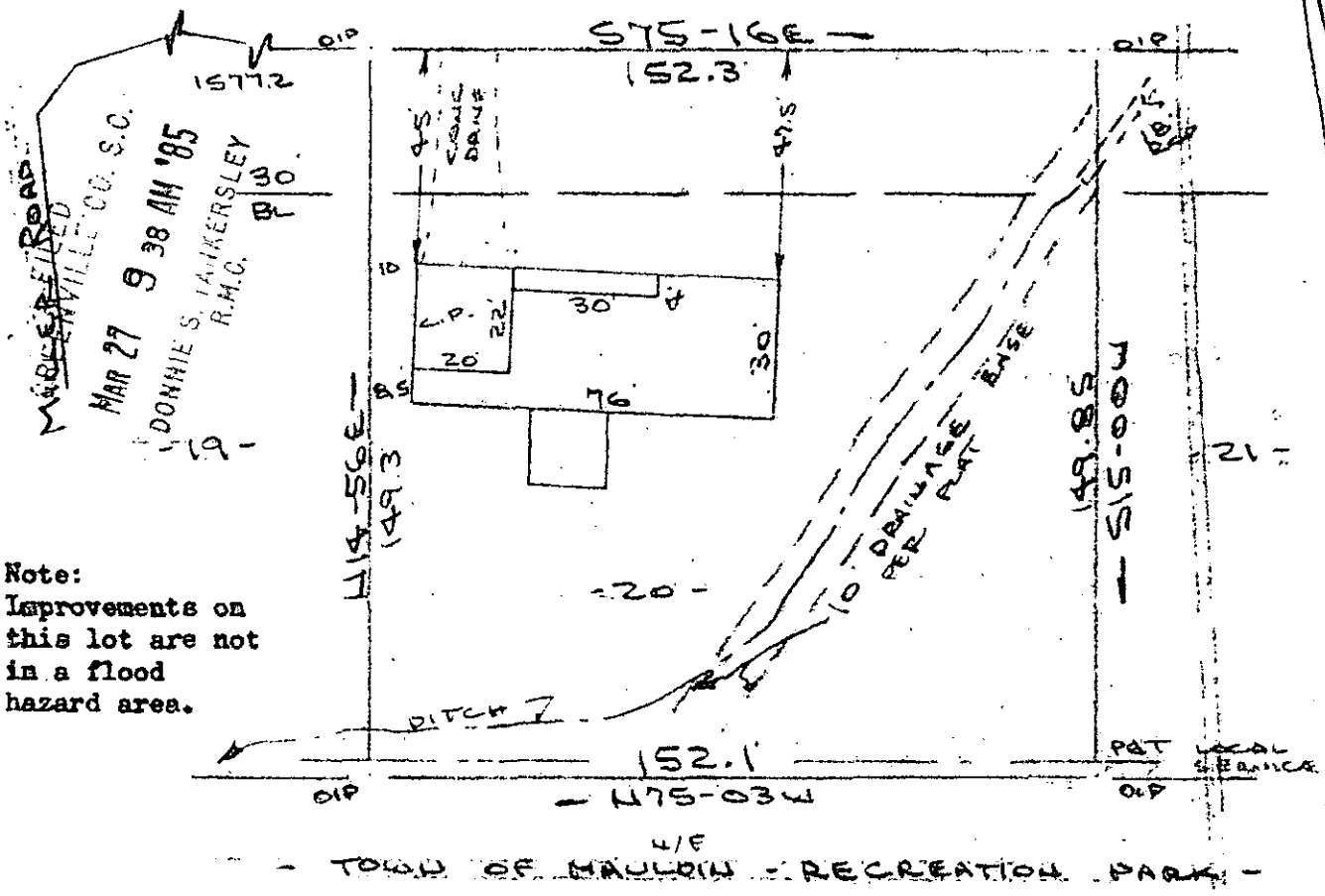

Note:
Improvements on
this lot are not
in a flood
hazard area.

PROPERTY OF
WILLIAM E. BALLEW & DONNA JO DUNLAP
GREENVILLE COUNTY, MAULDIN, S.C.

SCALE: 1"=40' 14 MAR 1985

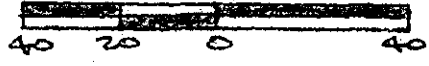

This is to certify that on the 14th day of March, 1985, I surveyed the property shown on this plat, being known as lot 20 on plat of PARKWOOD SECTION 1 and recorded in the REC Office Greenville County, S. C., in Plat Book " 4 - F " at Page 22; and that the property lines, walls and buildings are as shown hereon, and that the walls and buildings located on said lot do not encroach or project on adjacent street or property, and that no adjacent walls or buildings encroach or project on said premises, and no power lines cross this property except as shown hereon. Also known as PROPERTY OF WILLIAM E. BALLEW & DONNA JO DUNLAP and recorded in Plat Book at Page

11L-3
MAR 27 1985
28442 ✓

R. B. Bruce
R. B. Bruce, RLS # 1952

CAROLINA SURVEYING CO.
112 Manly St.
Greenville, S. C.

Recordable Plat