

MICROFILMED



FILED
GREENVILLE CO. S.C.

MAR 26 10 03 AM '85

DONNIE S. PARKERSLEY
R.M.O.

N 9 - 45 E 100.0 10.

N 80 - 15 W 150.0

S 80 - 15 E 150.0

S 9 - 45 W 100.0 10.

139.4' ± TO
HEATHWOOD DR.

CREIGHTON STREET

15

14

13

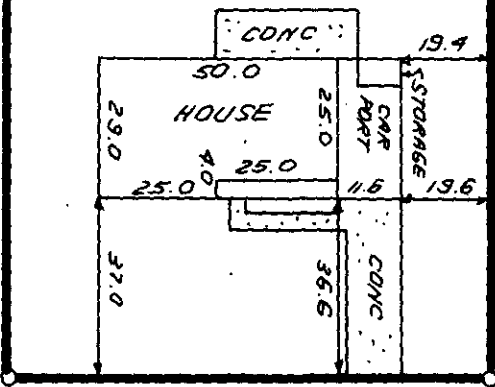

MAR 26 1985

11 - J - 94
28290



THIS IS TO CERTIFY THAT THE PROPERTY SHOWN ON THIS PLAT WAS SURVEYED UNDER MY DIRECT SUPERVISION. PROPERTY LINES AND IMPROVEMENTS SHOWN ARE LOCATED CORRECTLY AND THAT NO VISIBLE ENCROACHMENTS EXIST UNLESS OTHERWISE SHOWN. THIS PROPERTY IS NOT LOCATED IN A DESIGNATED FLOOD HAZARD AREA.



**STATE OF SOUTH CAROLINA
GREENVILLE COUNTY**

FREELAND & ASSOCIATES
Engineers • Land Surveyors
318 WEST STONE AVENUE,
GREENVILLE, S.C.
(803) 271-4924

COLONIAL HILLS
SECTION 3
LOT 14
PROPERTY OF
CHARLES J. CLYBORNE

PLAT BOOK	BBB@ 91
DEED BOOK	
TAX MAP	T 39.1-11-19
PARTY CHIEF	B.G.
DRAWN	K.E.G.
DATE	3-22-85
DWG. NO.	12658

6210 1 MAR 26 85 013