

WILMINGTON ROAD  
WATER & SEWER IN STRAI

MICROFILMED

FILED  
GREENVILLE, S.C.  
MAR 14 2 22 PM '85

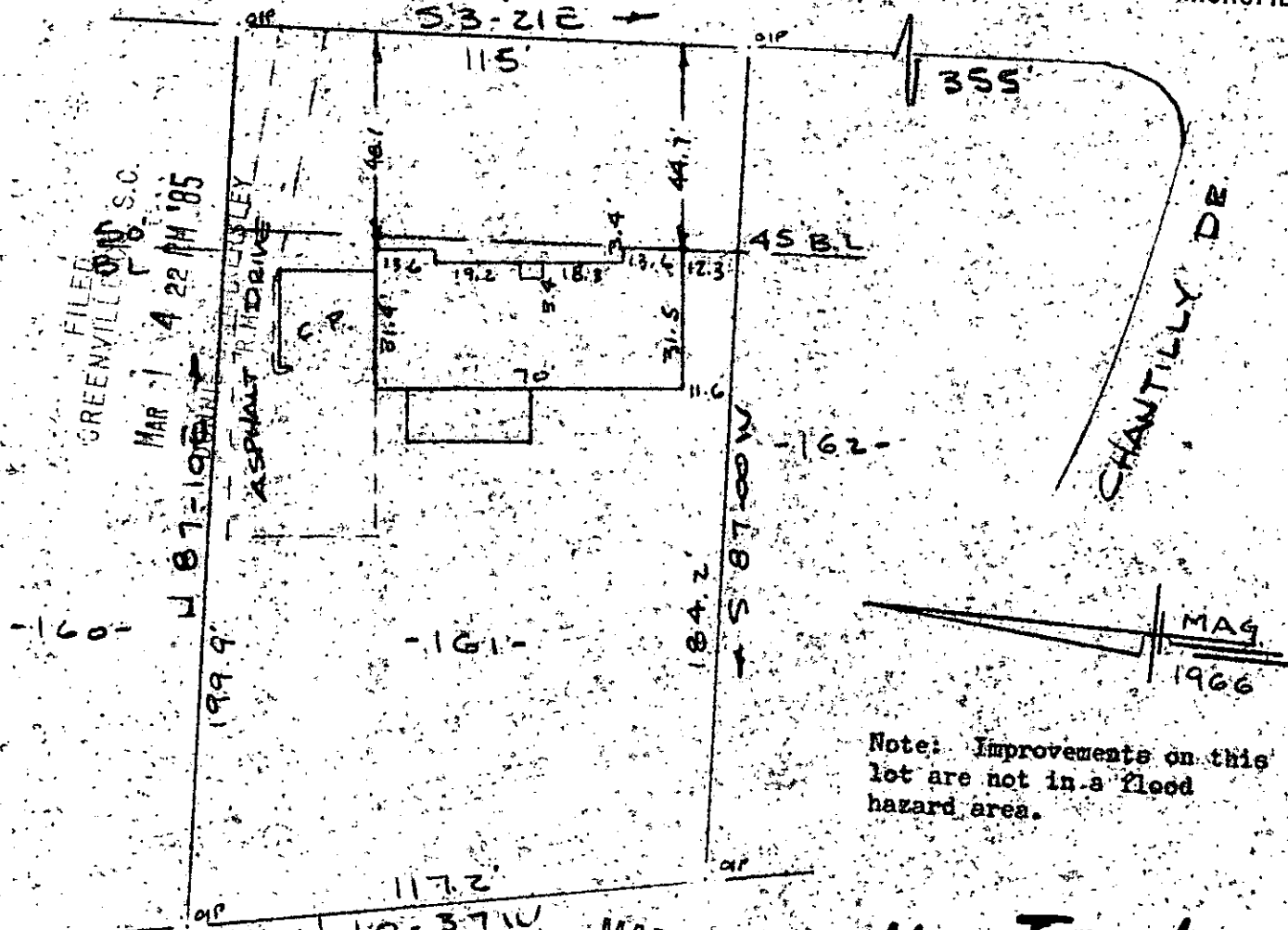

Note: Improvements on this lot are not in a flood hazard area.

PROPERTY OF  
FRANCIS N. KING & RUTH L. KING  
NEAR GREENVILLE, S.C.  
SCALE: 1" = 40'  
25 FEB 1985

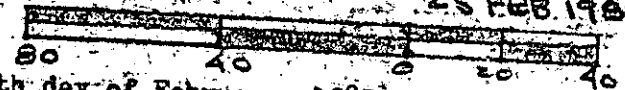

This is to certify that on the 25th day of February, 1985, I surveyed the property shown on this plat, being known as lot 161 on plat of SECTOR III BOPANY WOODS and recorded in the RDE Office Greenville County, S. C., in Plat Book "RR" at Page 37; and that the property lines, walls and buildings are as shown hereon, and that the walls and buildings located on said lot do not encroach or project on adjacent street or property, and that no adjacent walls or buildings encroach or project on said premises, and no power lines cross this property except as shown hereon.

*R. B. Bruce*  
R. B. Bruce, RLS # 1952

CAROLINA SURVEYING CO.  
112 Manly St.  
Greenville, S. C.

Recordable Plat

282/29A

P 1513-1-146