

FILED  
GREENVILLE CO., S.C.  
SEP 10 9 49 AM '85  
LONNIE S. TANKERSLEY  
R.M.C.

Magnetic



Note:  
Iron Pins At All Property Corners.  
There is a 5' Drainage And Utilities Easement Along Each Side Of All Side And Rear Lot Lines

SEP 10 1985

111-87

Filed This 10 day of Sept 19 85  
And Recorded in Vol. 11-1 Page 37 at 9:48 AM  
Register Means Conveyance Greenville County, S. C.

JEFFERY M. PLUMBLEE, INC.  
LAND SURVEYING

P. O. BOX 786  
TRAVELERS REST S. C. 29680 (803) 634-4426

506.4 - 1 - Pt. 1

RECORDING FEE  
PAID \$ 5.00

FB 7, 18, 22, 23

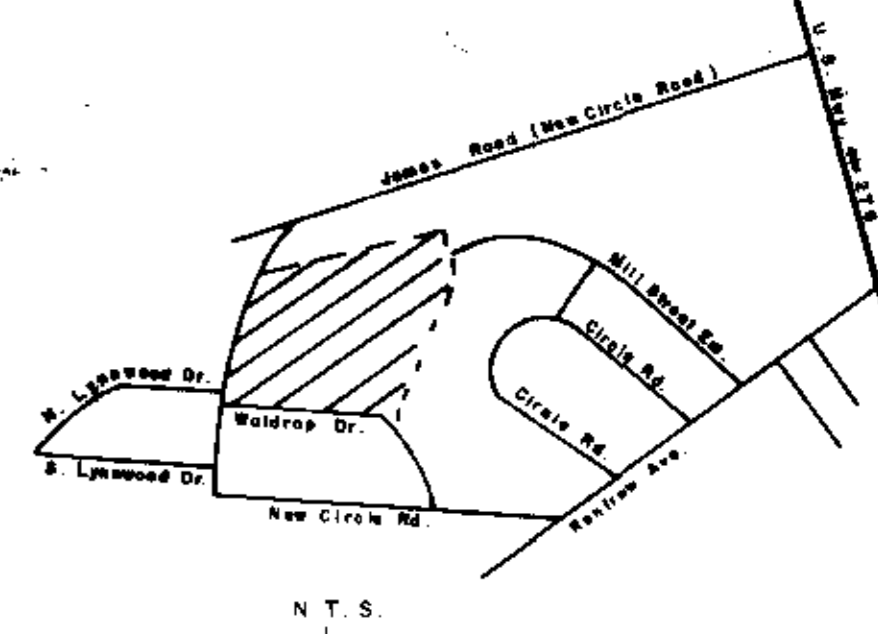

LOCATION MAP

# FINAL PLAT

## CERTIFICATE OF OWNERSHIP AND DEDICATION

The undersigned hereby acknowledge that we are the owners of the lands shown and described hereon and that we hereby assign this plat of subdivision with our free consent and that we establish the minimum public utility easements and dedicate to public use the roads, streets, and easements shown on this plat as indicated on said plat.

9-9-85  
Signed: Linda D. Hawkins  
Signed:  
Signed:  
Signed:

## CERTIFICATE OF ACCURACY

I, Jeffery M. Plumblee, certify that this plat was drawn by me drawn under my supervision or an actual survey made under my supervision from an actual survey made by me in accordance with the description recorded in Book Page Book Page etc. I further certify that the error of closure as calculated by latitudes and departures is 1/5000 that the boundaries not surveyed are shown as broken lines plotted from information found in Book Page that this plat was prepared in accordance with the Greenville County subdivision Regulations as adopted.

9/9/85  
DATE  
Signed: Jeffery M. Plumblee  
REGISTERED SURVEYOR

S. C. Registration No. 7881

## CERTIFICATE OF APPROVAL FOR RECORDING

I hereby certify that the subdivision plat shown herein has been found to comply with the Subdivision Regulations for Greenville County with the exception of such variances if any as are noted in the minutes of the Greenville County Planning Commission of Greenville County, South Carolina and that it has been approved for recording in the office of the County Register of Mesite Conveyance.

9/9/85  
DATE  
Signed: John H. Williams Jr.  
REGISTERED SURVEYOR

FILE NUMBER  
**84-168**

SUMMARY PLAT

# TANNETTE ESTATES

LINDA D. HAWKINS OWNER  
JEFFERY M. PLUMBLEE, INC. ENGINEER OR SURVEYOR

NO OF ACRES 12.56 MILES OF NEW ROADS 0

NO OF LOTS: 12 DATE 12-19-84

ZONE

SCALE 1" = 100'

