

# RUSSELL AVENUE

WATER & SEWER IN ST R/W

FILED  
GREENVILLE CO., S.C.  
FEB 11 10 07 AM '85  
DONNIE S. TANKERSLEY  
R.M.C.

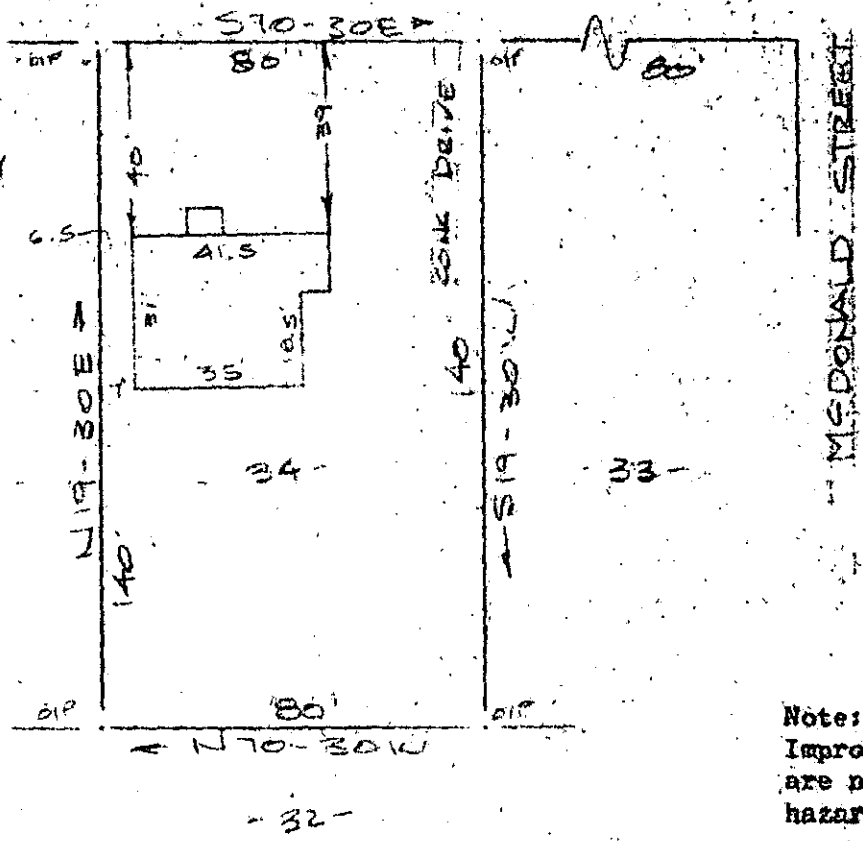

Note:  
Improvements on this lot  
are not in a flood  
hazard area.

PROPERTY OF  
 C. KELLY GREENVILLE, S.C.  
 SALS: 1" = 40'  
 OF ASHWORTH S.C.  
 FEB 1985

This is to certify that on the 6th day of February, 1985, I surveyed the property shown on this plat, being known as lot 34 on plat of MAP OF NORTH HILLS and recorded in the RMC Office Greenville County, S. C., in Plat Book "H." at Page 90; and that the property lines, walls and buildings are as shown hereon, and that the walls and buildings located on said lot do not encroach or project on adjacent street or property, and that no adjacent walls or buildings encroach or project on said premises, and no power lines cross this property except as shown hereon.

11-A-30  
 FEB 11 1985 23619

R. B. Bruce, RLS # 1952

Recordable Plat

CAROLINA SURVEYING CO.  
 112 Manly St.  
 Greenville, S. C.

GCTO  
 FEB 11 85  
 016  
 3.0000