

1/4 GROVER M & B.M. RIDDLE

FILED GREENVILLE CO. S.C. JAN 9 10 14 AM '85 DONNIE S. TANKERSLEY R.M.C.

584.1-1-1-3.17 out of 584.1-1-3.12

1/4 JERRY PAUL & APRITH KERRY KELLY

HUGH TALLENT, JR & LEONORE I. TALLENT

MAY 1980

REF TO SURVEY FOR H. MICHAEL GAINBY BY CAROLINA SURVEYING CO. BEING RECORDED IN B.M.C. FOR GREENVILLE CO IN PLAT BOOK 74 @ PAGE 84

JAN 9 1985

11-E-22 20455

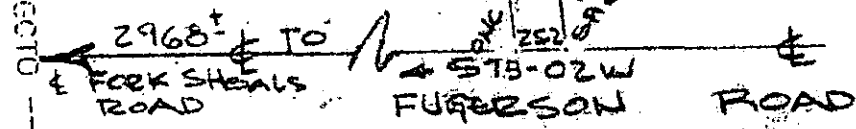

SURVEY FOR MICHAEL ALAN CERVANTES & DEBEA MARIE CERVANTES & LEONORE I. TALLENT GREENVILLE COUNTY, S.C.

SCALE: 1" = 100' 4 JAN 1985

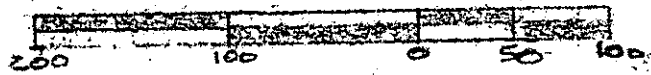

I Certify That The Ratio Of Precision Of The Field Survey is 1/3000+ As Shown Hereon And That The Area Determined By D.M.D. Method Of Area Calculations.

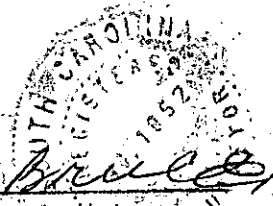

R. B. BRUCE, RLS #1952

CAROLINA SURVEYING CO. 112 MANLY ST. GREENVILLE, S.C.

(6974)