

MICROFILMED

PK P.M.D. 81012

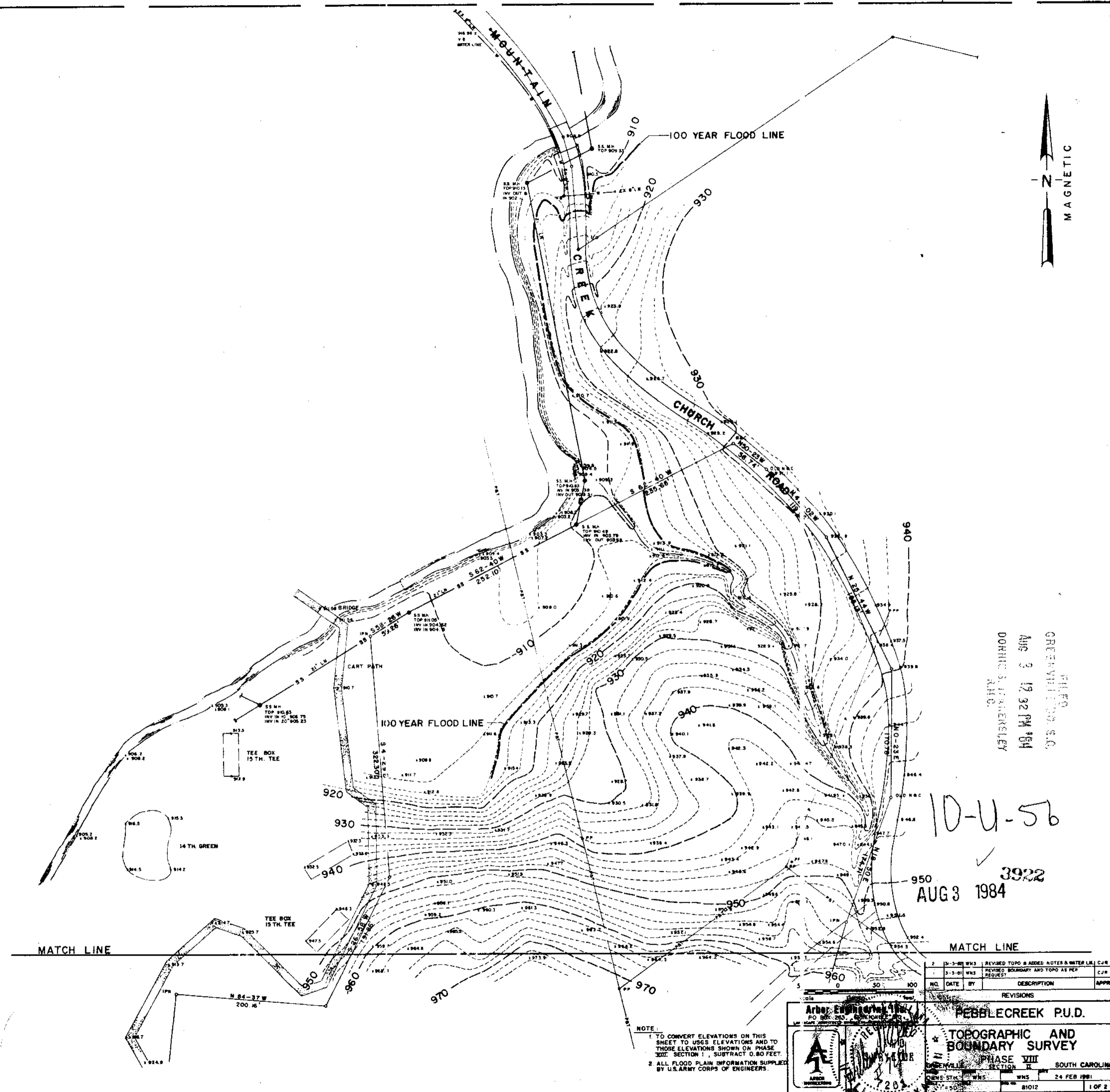

FILED  
GREENVILLE S.C.  
AUG 3 12 32 PM '84  
DORRIS J. JENNINGS  
A.M.C.

10-U-56  
3922  
AUG 3 1984

NO.	DATE	BY	DESCRIPTION	APPR.
1	2-24-84	WNS	REVISED TOPO & ADDED NOTES & WATER LINES	CJR
2	2-24-84	WNS	REVISED BOUNDARY AND TOPO AS PER REQUEST	CJR

REVISIONS

Arber Engineering Inc.  
P.O. Box 295, Greenville, S.C. 29602

**PEBBLECREEK P.U.D.**

**TOPOGRAPHIC AND BOUNDARY SURVEY**

PHASE VIII

SECTION II SOUTH CAROLINA

WNS STK WNS WNS 24 FEB 1981

81012 1 OF 2

NOTE:  
1. TO CONVERT ELEVATIONS ON THIS SHEET TO USGS ELEVATIONS AND TO THOSE ELEVATIONS SHOWN ON PHASE VIII SECTION I, SUBTRACT 0.80 FEET.  
2. ALL FLOOD PLAIN INFORMATION SUPPLIED BY U.S. ARMY CORPS OF ENGINEERS.